

PRELIMINARY PLAT
 "TIM LOEHR ADDITION"
 SEDGWICK COUNTY, KANSAS

SOUTHEAST QUARTER SECTION 31, T27S, R3W

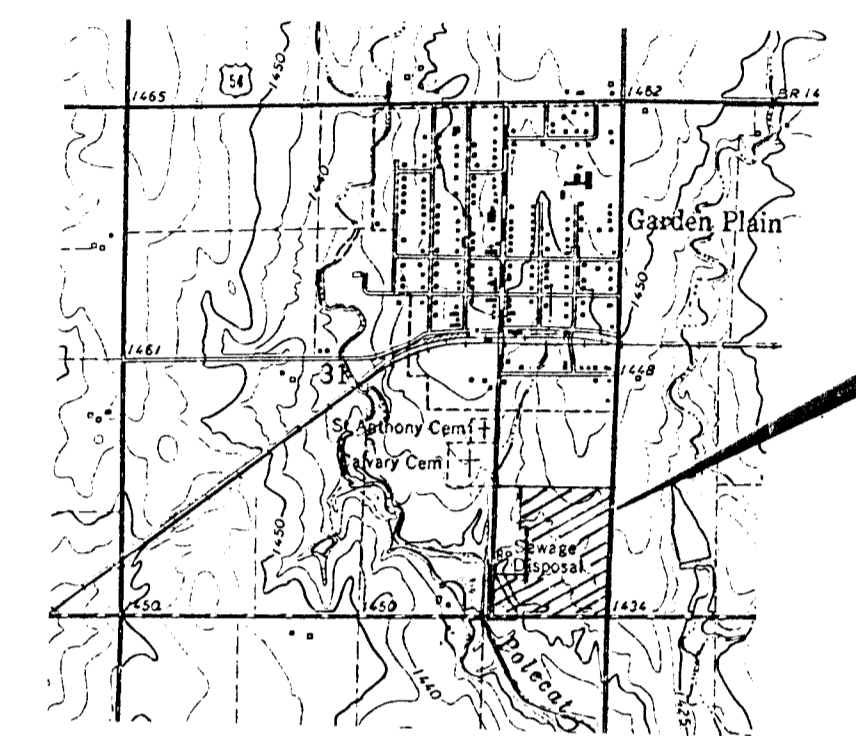

VICINITY MAP
 Sec 31, T27S, R3W
 SCALE: 1" = 2000'

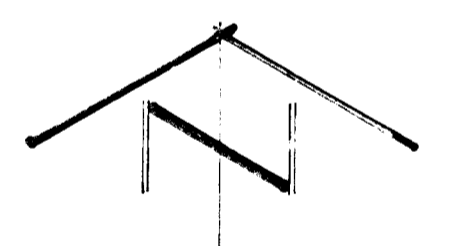

#881203
 SCALE: 1" = 100'
 CONTOUR INTERVAL 2'
 TOPOGRAPHY 14 JULY, 1988

Subdividers: Tim A. & Patricia L. Loehr
 Gary & Jean Zoglman
 William L. & Sharon F. Brown

c/o William L. Brown
 1208 N. Sedgwick, Box 256
 Garden Plain, Kansas 67050
 Tele: 535-2664

