

SKETCH PLAT  
**LEWIS WEST 2ND. ADDITION**

THE WEST 139 FEET OF LOT 20, KNIGHT ACRES,  
 SEDGWICK COUNTY, KANSAS, EXCEPT THE NORTH  
 361 FEET THEREOF AND EXCEPT THE SOUTH 135  
 FEET THEREOF.

LEWIS F. WEST

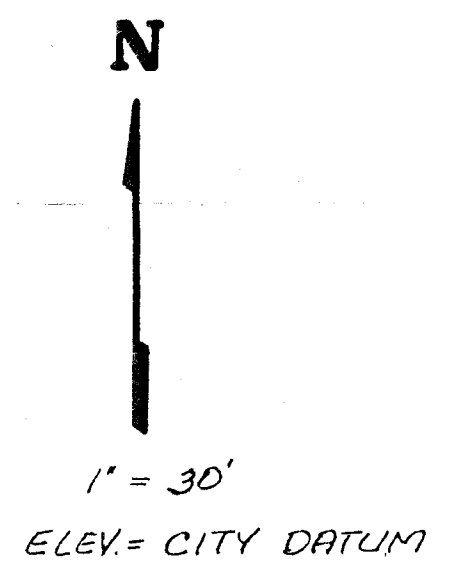

BENCH MARK:  
 City standard disc 30' S. & 42'  
 E. of the E. of Sheridan &  
 Central.  
 Elev. = 121.66 City Datum

BENCH MARK: (set this survey)  
 R.R. Spike in north side of H.L.P.  
 @ S.E. Corner of Knight & St. Louis  
 Elev. = 119.45 City Datum

drainage plan