

Mobile Home Park Area 435,600 Sq. Ft.
 Required Recreation Area 34,848 Sq. Ft.
 Designated Recreation Area 38,044 Sq. Ft.

SW Cor. Sec. 15,
 T-28-S, R-1-E

PRELIMINARY SITE DEVELOPMENT PLAN SHERWOOD ACRES MOBILE HOME PARK

Total Available Acreage 10
 Mobile Home Sites 60
 Density 6

LEGAL DESCRIPTION
 The West 10 Acres of the East 15 Acers of the Southwest Quarter of the Southwest Quarter of Section 15, Township 28 South, Range 1 East, of the 6th Principal Meridian, City of Wichita, County of Sedgwick, State of Kansas.

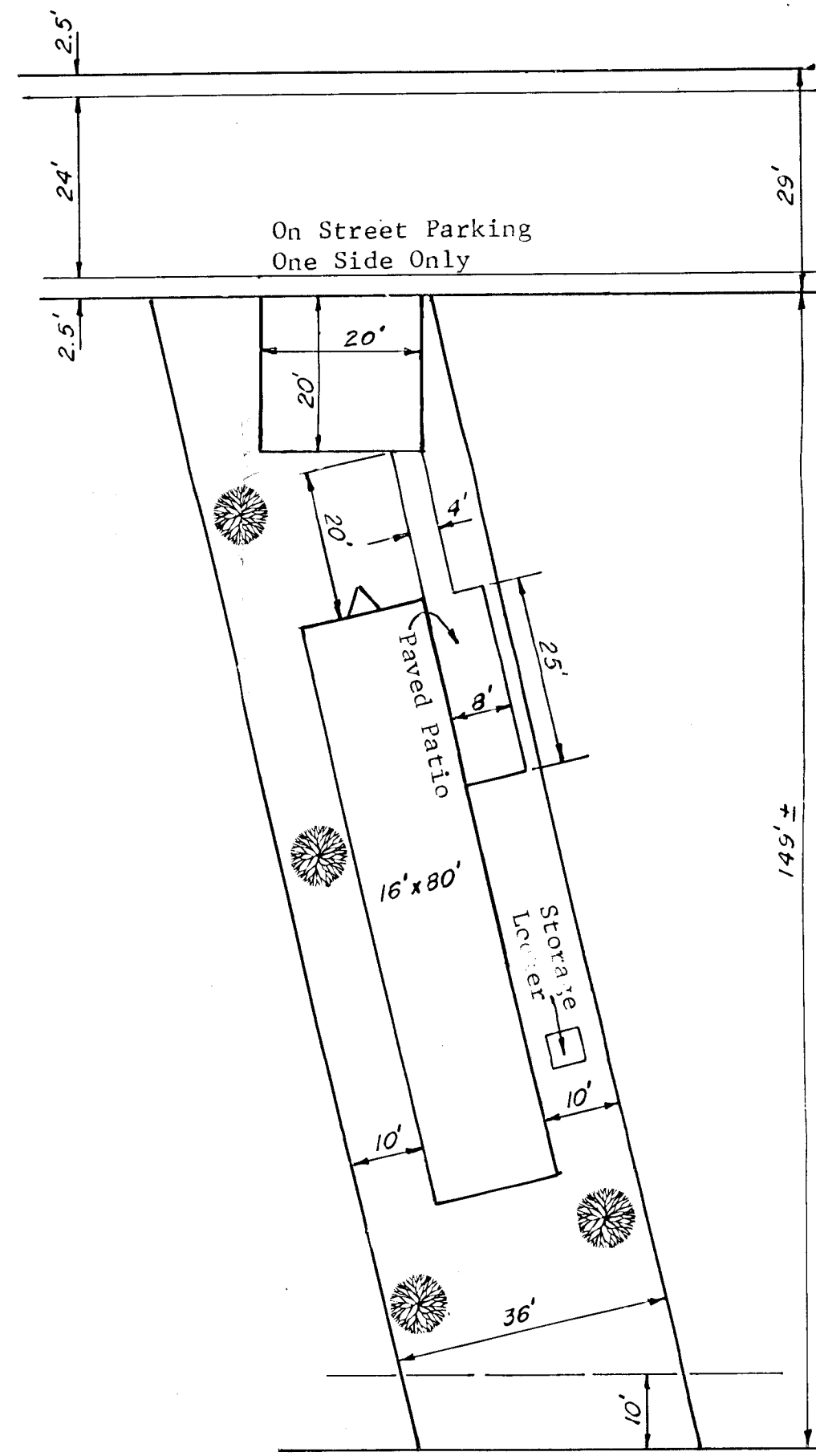

TYPICAL SITE LAYOUT
 Scale 1" = 20'

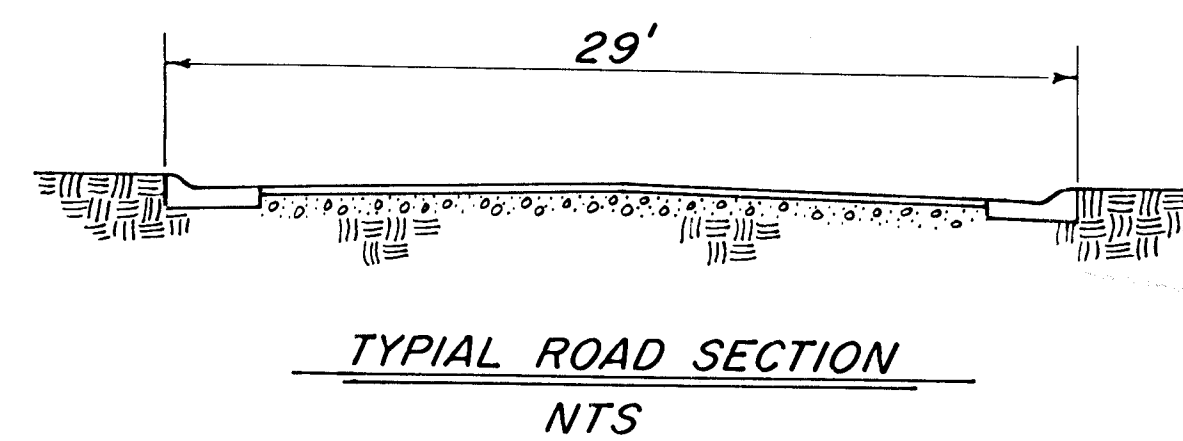

TYPICAL SWALE SECTION
 N.T.S.

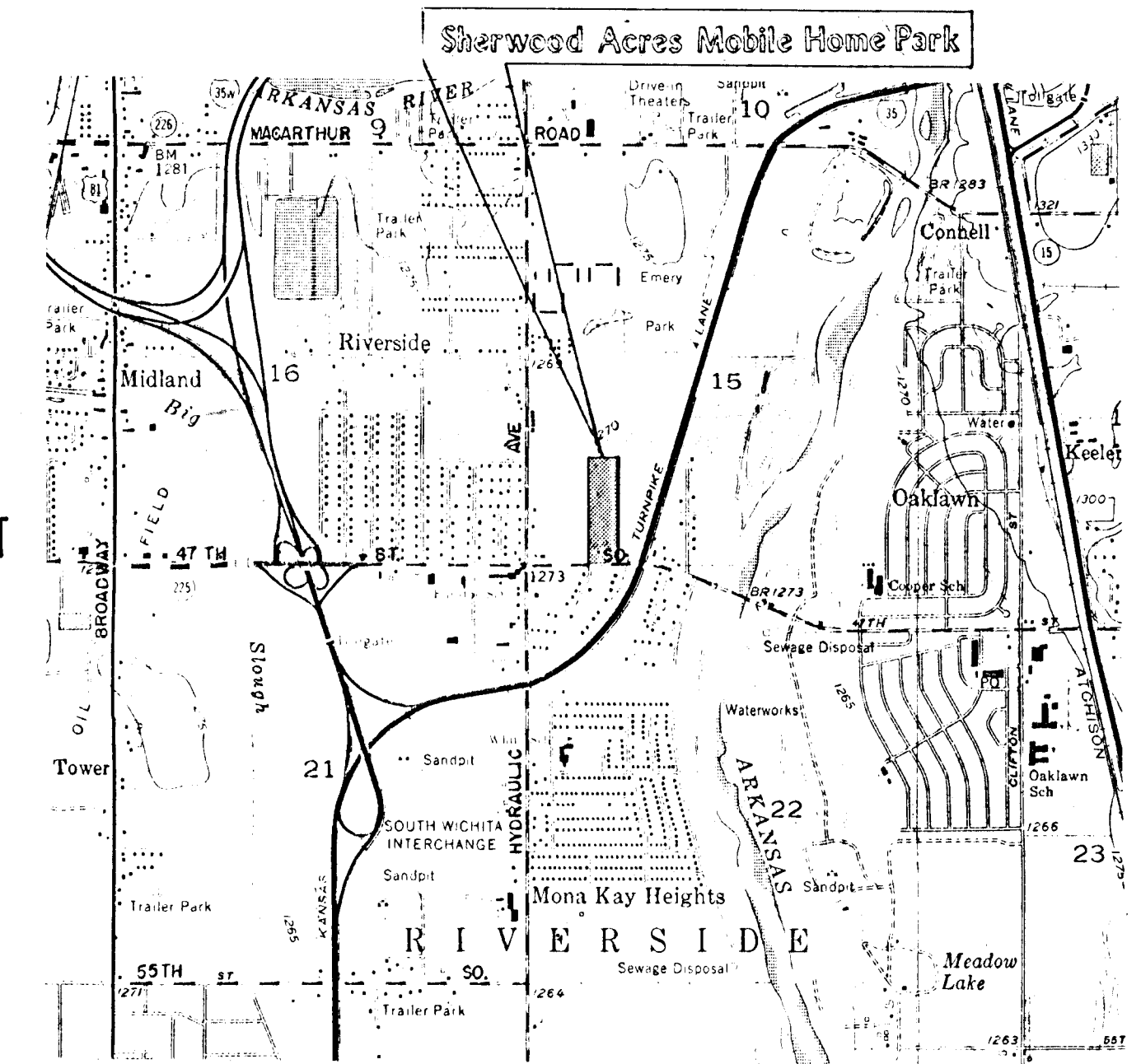

LOCATION MAP

SURV. PLOT. DES. DR. TR. CKD. APP.

Booker/Freund
 Engineers Architects Planners

SCALE AS NOTED DATE OCTOBER, 1984 DWG. NO. K-9139-01