

DRAINAGE PLAN of
SENECA HILLS 2nd ADDITION
 WICHITA, SEDGWICK COUNTY, KANSAS.

Engineer: P.E.C. p.a.
 1440 English, Wichita, Ks. 67211
 Owners: J. Boyd, T.W. Boyd & W.D. Wadley
 128 So. Dellrose, Wichita, Ks. 67218

Utilities:
 Water - City of Wichita
 Sewer -
 Gas - Gas Service Co.
 Power - K.G. & E.
 Tel - Southwestern Bell (Underground cable on East side of Seneca)

NOTE: Lot 1 shall be graded to drain to prop floodway or streets, ditches or storm sewers via drives, flumes, private storm sewers and/or other approved drainage facilities.

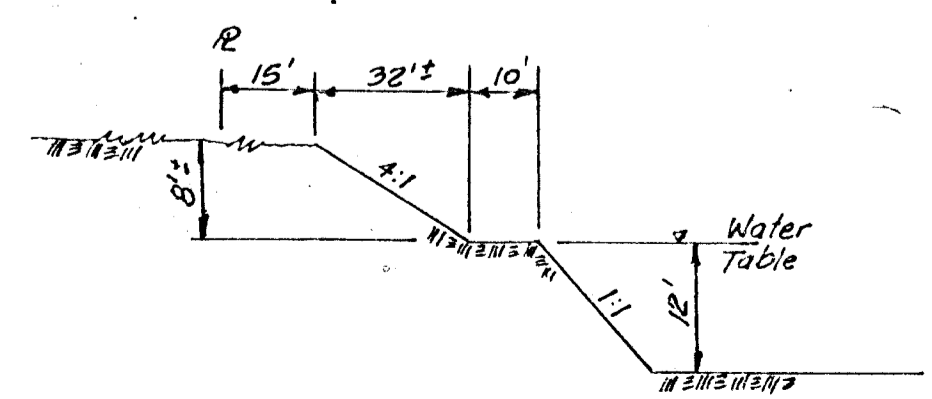

SECTION A-A n.s.

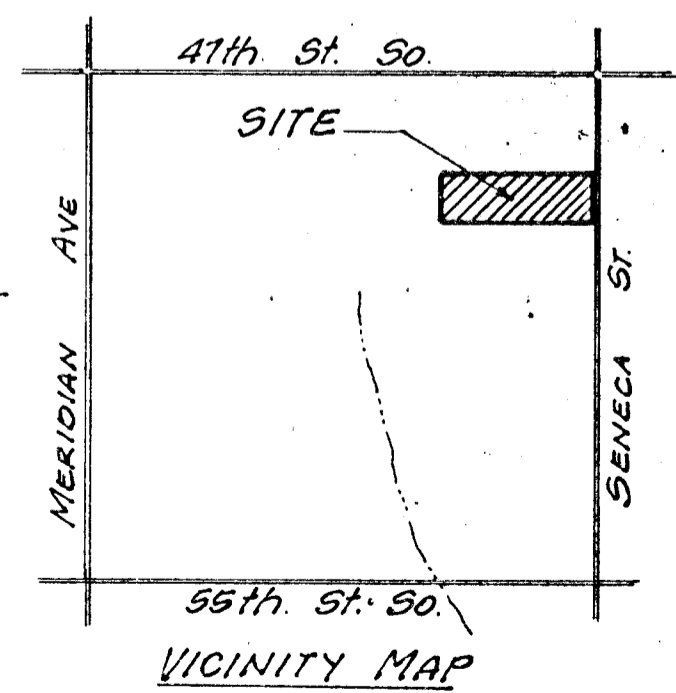

Scale 1" = 100'
 B.M. Brass Cap 74'N & 44'E
 Intersection Seneca &
 47th St. So. El. = 87.34
 City Datum.
 Oct. 25, 1984.
 Topo Oct 3, 1980.

Charles S. Brown 10-31-84