

1. ALL ELEVATIONS BASED ON CITY OF WICHITA DATUM.
2. ALL MATERIALS AND CONSTRUCTION METHODS SHALL COMPLY TO CITY OF WICHITA STANDARD SPECIFICATIONS, LATEST EDITION, UNLESS OTHERWISE NOTED.
3. APPLICATION RATES FOR SEED, FERTILIZER & MULCH SHALL BE:
 SEED : K-31 FESCUE 8 LBS/1,000 SQ. FT.
 FERTILIZER: 10-20-0 TO LBS/1,000 SQ. FT.
 MULCH : PRAIRIE HAY 100 LBS/1,000 SQ. FT.
4. CONTRACTOR SHALL SATISFY HIMSELF OF CONDITIONS PRIOR TO EXCAVATION.
5. STRIP TOPSOIL AND STOCKPILE IN DESIGNATED AREA.
6. AFTER COMPLETION OF EARTHWORK OPERATIONS, PLACE 6" TOPSOIL ON DISTURBED AREAS AND SEED AS SPECIFIED.
7. EXCESS TOPSOIL SHALL BE WASTED ON-SITE OR DISPOSED OF AS DIRECTED BY THE OWNER.

GRADING PLAN
SENECA HILLS 2nd ADDITION
 WICHITA, SEDGWICK COUNTY, KANSAS.

Engineer: P.E.C. p.a.
 1440 English, Wichita, Ks. 67211
 Owners: J. Boyd, T.W. Boyd & W.D. Wadley
 128 So. Dellrose, Wichita, Ks. 67218
 Utilities:
 Water - City of Wichita.
 Sewer -
 Gas - Gas Service Co.
 Power - K.G.E.
 Tel. - Southwestern Bell (Underground cable on East side of Seneca)

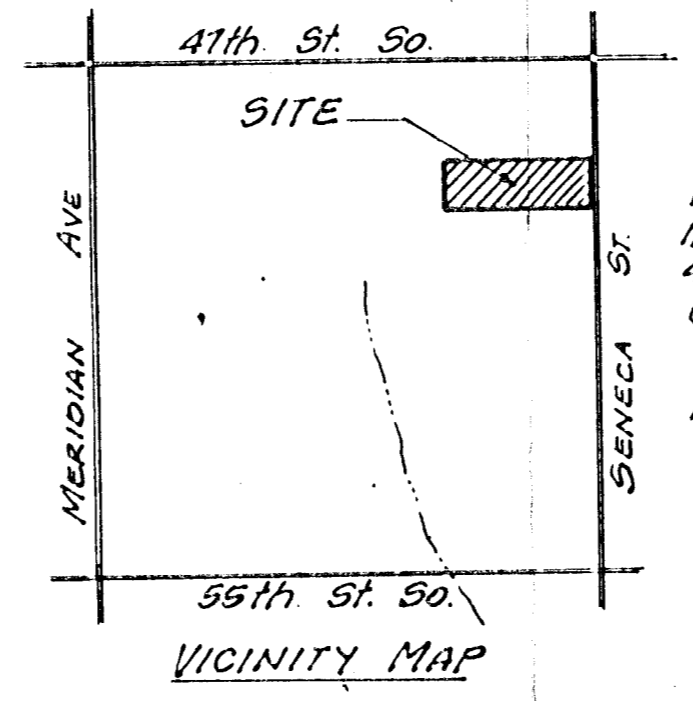

Scale 1" = 100'
 B.M. Brass Cap 74'N & 44'E
 Intersection Seneca &
 47th St. So. El. - 87.34
 City Datum.
 Oct. 25, 1984.
 Topo Oct 3, 1980

**APPROVED
 DRAINAGE PLAN**

