

**PRELIMINARY PLAT**

**MAPLE VALLEY ADDITION**

**WICHITA, SEDGWICK COUNTY, KANSAS**

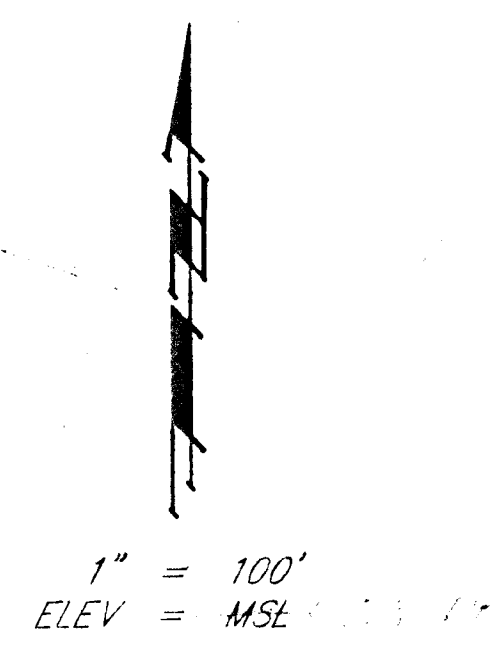

Part of the NE 1/4 of Sec. 25, Twp. 27-S, R-2-W of the 6th P.M., Sedgwick County, Kansas.

LEE & CARLENE BANKS  
 \* Greystone, Inc.  
 Attn: Richard E. Huffman  
 155 N. Market, Suite 900  
 Wichita, KS 67202  
 265-2727

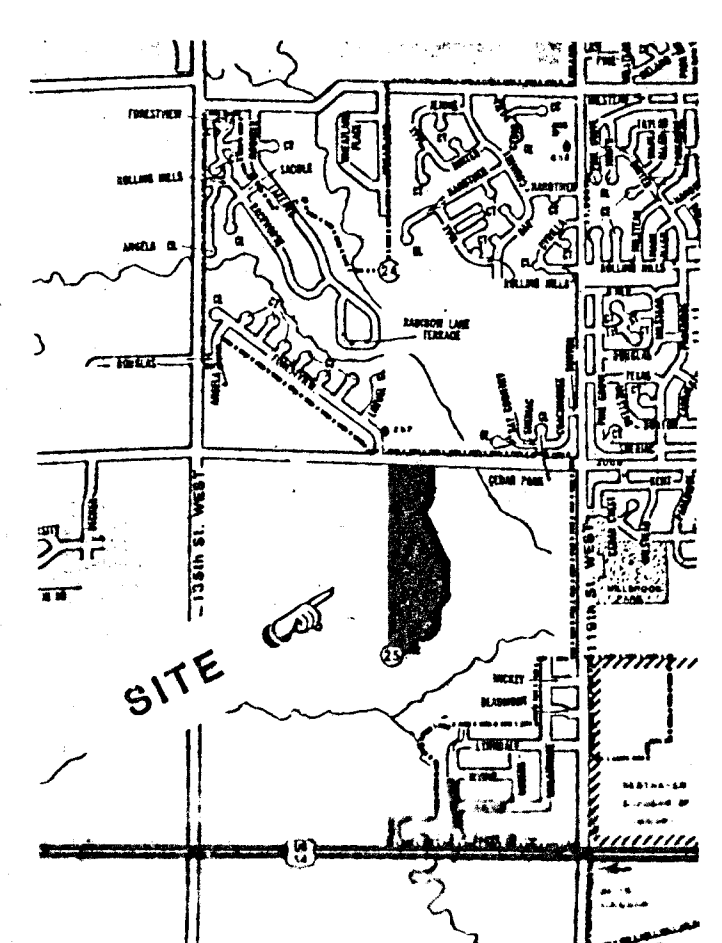

**VICINITY PLAT**

*Water Line &  
 Sanitary Sewer  
 Lay out*

11-14-90

**N**  
 ASSUMED ADJUSTED  
 TOPOGRAPHIC MAP OF LANDS LOCATED AT  
 NORTHEAST QUARTER OF SECTION 25, 27 S. 2 W.  
 SEDGWICK COUNTY, KANSAS

SURVEYING & ENGINEERING  
 BAUGHMAN COMPANY, P.A.  
 315 ELLIS STREET, WICHITA, KANSAS 67211

0 100 200 300  
 1:1200 100'-1"

CONTOUR INTERVAL: 2 ft.  
 PHOTOGRAPHY BY: AERIAL PHOTOGRAPHY  
 MILES AIR PHOTO SURVEY TYPE: VERTICAL W/ 40%  
 500 FEETABLE ROAD AUTHORITY: 100% A.M.G.L.  
 11/13/82 148 15-527 P.254 OTHER OPERATED: 28 MAR. 1988

27 July 1990  
**BAUGHMAN COMPANY P. A.**  
 SURVEYING & ENGINEERING  
 315/282-7271 • 315 ELLIS • WICHITA, KANSAS 67211