

N.W. Cor. NW 1/4 Sec 9, T27S, R1W, Gth PM.

N.W. Cor. NE 1/4, NW 1/4 Sec 9, T27S, R1W, Gth PM.

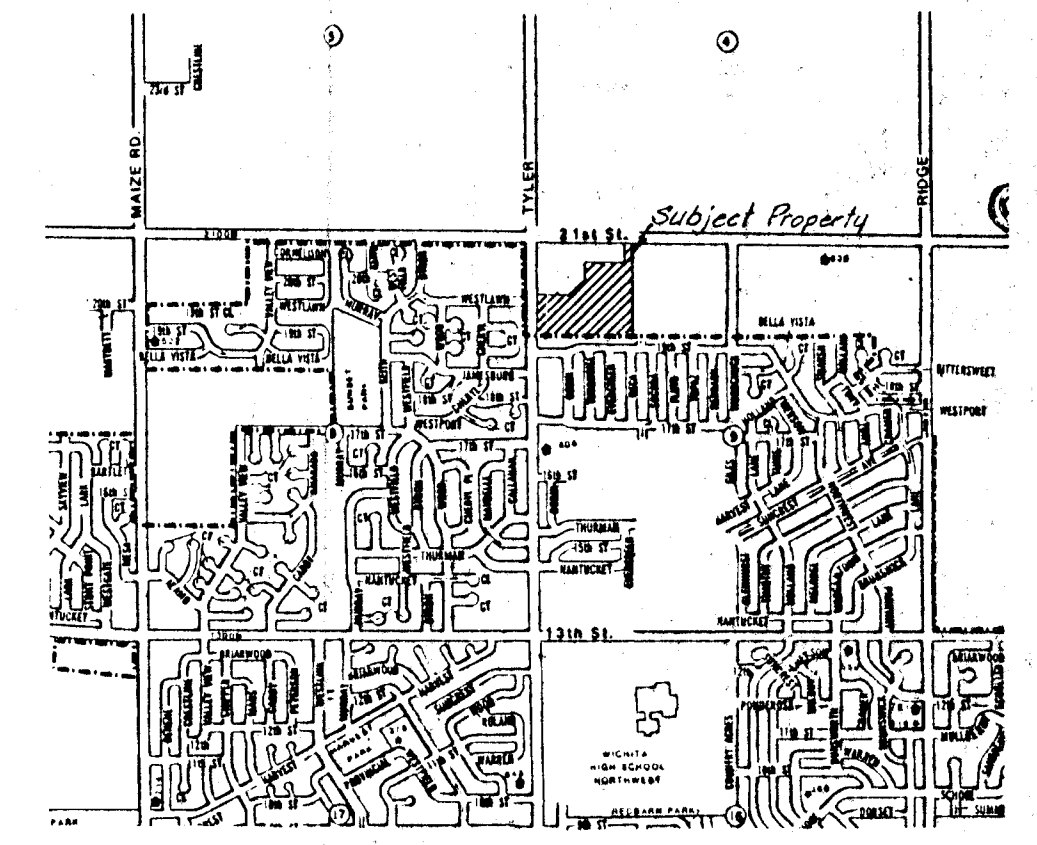

VIGNITY PLAT

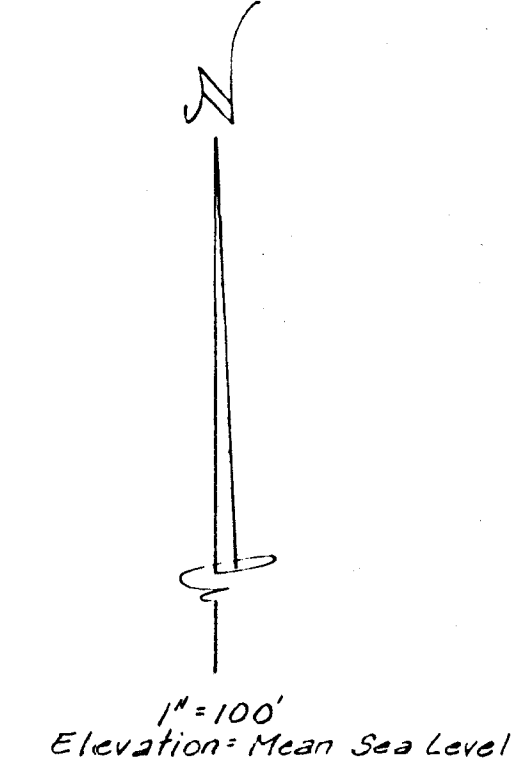

BENCH MARK: City Standard Disc.
38' west & 90' south of E's both
Tyler Road & 21st St. No.
Elevation = 1357.35 M.S.L.

DRAINAGE CONCEPT

PRELIMINARY PLAT

WESTWIND 4TH ADDITION

TRACT IN THE NW 1/4 SEC. 9, TWP 27-S, R-1-W

OWNER: WESTWIND PARTNERSHIP III
LEONARD E. MAROTTE, GEN. PARTNER

DA = 3.6 Ac.
C = 0.44 C₁₀₀ = 0.61
Q = 6.1 cfs
Q₁₀₀ = 16.4 cfs
(overflows east in street)

DA = 15 Ac.
C = 0.44 C₁₀₀ = 0.61
Q = 7.6 cfs
Q₁₀₀ = 20.2 cfs
Total Q₁₀₀ = 50.5
(overflows @)

NOTE: THIS CONCEPT CONFORMS TO THE "DRAINAGE REPORT FOR WESTWIND 2ND, WESTWIND 3RD..." DATED MARCH 1987 (PART I - WESTWIND C.U.P.).

REFER ALSO TO THE DRAINAGE PLAN FOR WESTWIND 3RD ADDITION, DATED MARCH 27, 1987.