

DRAINAGE PLAN WESTWAY

Wichita, Sedgwick County, Kansas.

5-16-86

Owner/Developer: Phil Ruffin P.O. Box 17087 Wichita, Ks.
 Engineer: P.E.C. p.a.
 1440 English, Wichita, Ks. 67211

Notes:-
 Underground Telep. (S. Western Bell Co.)
 along west side of Seneca, north side of
 Pawnee, east side of Elizabeth & north
 side of Crawford.
 For building setbacks see
 C.U.P. D.R.-21 amended.
 Date of Toop March 21, 1975

B.M. disc 52' North & 44' East
 of centerline of Seneca &
 Pawnee. Elev. = 103.447 City Datum.

- Notes:
1. Lots 1 & 3 shall continue to be drained via existing streets & private storm water sewer system.
 2. Lot 2 shall be graded to drain to existing streets, gutters, and/or storm water sewer systems via drives, flumes, private storm sewers and/or other approved drainage facilities.

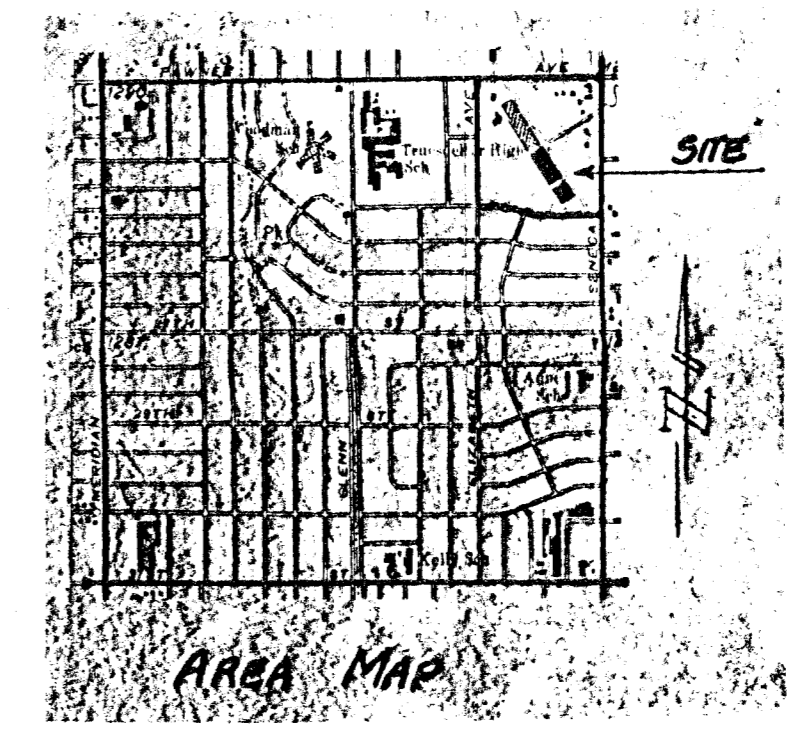

LEGEND	
	DRAINAGE BASIN BOUNDARY
	DRAINAGE SUB-BASIN BOUNDARY
	DRAINAGE FLOW DIRECTION
	SUB-BASIN NUMBER

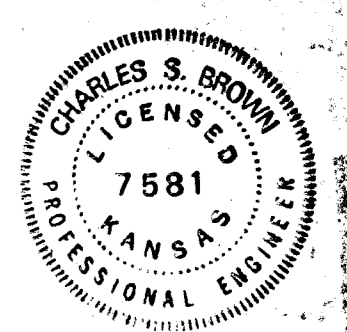

3/4" I.P. on Thimble
 NE Cor. NE1/4, NE1/4
 Sec. 6, T28S, R1E
 of the 6th P.M.

3/4" I.P. on Thimble
 NW Cor. NE1/4, NE1/4
 Sec. 6, T28S, R1E
 of the 6th P.M.

1/2" I.P. on Thimble
 NE Cor. NE1/4, NE1/4
 Sec. 6, T28S, R1E
 of the 6th P.M.

1" = 100'
 Found Monument
 Set 3/4" I.P.

WESTWAY PARK ADDITION