

PRELIMINARY PLAT OF  
**HORSESHOE LAKE (REPLAT OF NORTH LAKES ADD.)**

PREPARED FOR: GRANDVIEW INC.  
 8100 E. 22ND ST. NORTH, BLDG. 1000  
 WICHITA, KANSAS 67226

ENGINEER: PROFESSIONAL ENGINEERING CONSULTANTS, P.A.  
 303 S. TOPEKA  
 WICHITA, KANSAS 67207

NOTES: SEE HORSESHOE LAKE C.U.P. (OP-75) FOR ADDITIONAL REQUIREMENTS.  
 ALL RESERVES SHALL BE OWNED AND MAINTAINED BY A HOMEOWNERS ASSOCIATION.  
 RESERVES A, B, C, E, G, H, I AND J SHALL PERMIT ENTRY MONUMENTS, LANDSCAPING, WALKS, AND UTILITIES, CONFINED TO EASEMENTS. RESERVES A, C, D, E AND J SHALL ALSO PERMIT WALLS CONFINED TO EASEMENTS.  
 RESERVES D, F AND H SHALL PERMIT DRAINAGE, DRAINAGE STRUCTURES, LAKES, LANDSCAPING, WALKS, RECREATIONAL USE, UTILITIES AND WALLS CONFINED TO EASEMENTS.

*Not Binded!  
 C-20-95*

MERE RIDGE ADDITION  
 ZONED AA

RESERVE "A"

RITCHIE CORPORATION  
 ZONED "E" LIGHT IND.  
 UNPLATTED

LAKE RIDGE 2ND ADDITION  
 ZONED AA

12  
 ZONED BB  
 SUBJECT TO PLATTING

13  
 ZONED C

EXCEPTION  
 COX MACHINE ADD.  
 ZONED E

EXCEPTION  
 POSEY DANIELS  
 ZONED R-1

14  
 ZONED C

10  
 ZONED L.C.  
 SUBJECT TO PLATTING

11  
 ZONED L.C.  
 SUBJECT TO PLATTING

SCALE: 1"=100'

JUNE, 1995  
 TOPO FEBRUARY, 1986

A.C. = ACCESS CONTROL  
 C.A.C. = COMPLETE ACCESS CONTROL  
 B.S.L. = BUILDING SETBACK LINE

BENCH MARK: CITY OF WICHITA BENCH MARK DISC, 30 FEET NORTH AND 37 FEET EAST OF THE INTERSECTION OF THE CENTERLINES OF HOOKER AND 21ST ST. N.  
 ELEV.=139.991 CITY DATUM  
 ELEV.=1327.17 M.S.L.

NOTE: CONTOUR LINES ON MEAN SEA LEVEL.  
 SANITARY SEWER MANHOLE ON CITY DATUM.

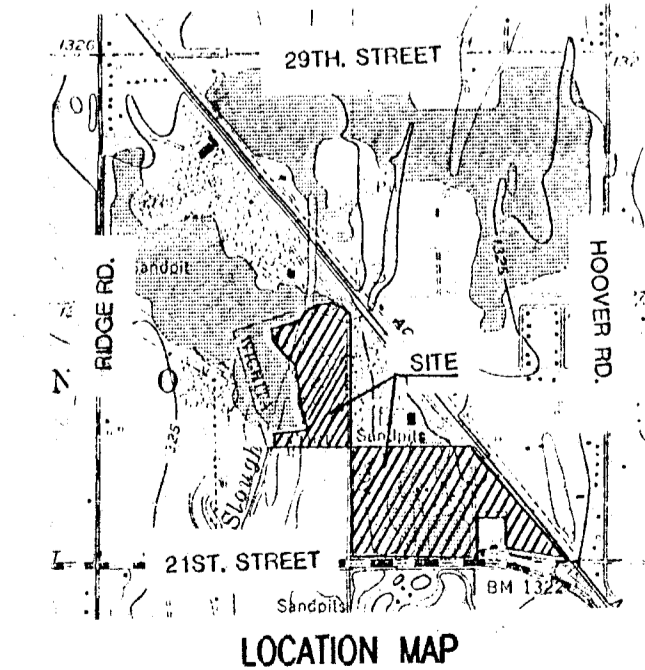

S.W. CORNER SE. 1/4  
 SEC. 3, T27S, R1W  
 OF THE 6TH P.M.

10" Gas (Atk) 10' 60" Water

ACCESS CONTROL EXCEPT 1 OPENING (RT. TURN ONLY) 230'  
 ACCESS CONTROL EXCEPT 1 OPENING (RT. TURN ONLY) 495'  
 COMPLETE ACCESS CONTROL 401.21'  
 ACCESS CONTROL EXCEPT 2 OPENINGS