

PRELIMINARY PLAT OF
"NELSON'S HILLSIDE PARK"
 WICHITA, KANSAS

IN THE SOUTHEAST QUARTER OF SECTION 3,
 TOWNSHIP 28 SOUTH, RANGE 1 EAST OF THE 6TH P.M.,
 SEDGWICK COUNTY, KANSAS

Owner: Joyland Hillside Park, Inc.
 Zoning: "LC" & "SF-6"

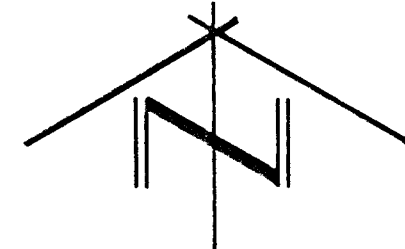

SCALE: 1" = 20'
 O = IRON FOUND AS NOTED
 □ = IRON MONUMENT FOUND
 * = MARKER WITH I.D. CAP
 "T151 C152" SET
 (D) = DESCRIBED
 (M) = MEASURED
 BEARING BASIS ASSUMED
 B.M. = BENCH MARK
 F.H. = FIRE HYDRANT
 M.H. = MANHOLE
 W.M. = WATER METER
 W.V. = WATER VALVE
 P.D. = POWER POLE
 FILE # 970089
 20 MARCH, 1997

LEGAL DESCRIPTION

A tract in the Southeast Quarter of Section 3, Township 28 South, Range 1 East of the Sixth Principal Meridian, Sedgwick County, Kansas, described as follows:

BEGINNING at a point on the North line of the Southeast Quarter of said Section 3, which is 50 feet West of the Northeast corner of said Southeast Quarter; thence South, parallel with the East line of said Southeast Quarter, a distance of 30 feet; thence East, parallel with the North line of said Southeast Quarter, a distance of 10 feet; thence South, parallel with the East line of said Quarter, a distance of 92 feet; thence Southwesterly to a point which is 185 feet South and 240 feet West of the Northeast corner of said Southeast Quarter; thence West, parallel with the North line of said Southeast Quarter, a distance of 102 feet; thence North, parallel with the East line of said Quarter, a distance of 185 feet to the North line of said Quarter; thence East, on said North line, a distance of 292 feet to the **POINT OF BEGINNING**.

This legal description was prepared by Terra Tech Land Surveying, Inc. and is true and correct according to information of record and to the best knowledge and belief of the corporation.

TERRA TECH LAND SURVEYING, INC.

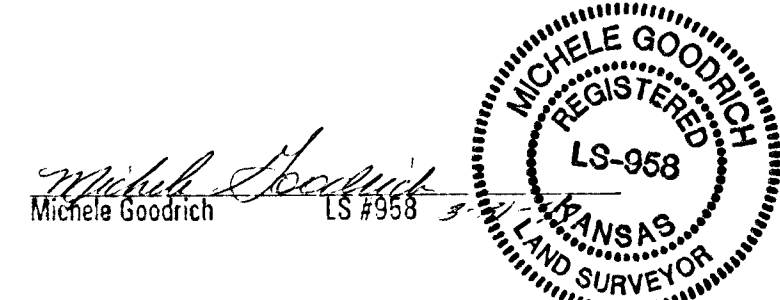

This document should contain a crimped seal and the surveyor's signature in blue ink. If it does not, it is a copy that should be assumed to contain unauthorized alterations. The certification on this document shall not apply to any copies.

