

N.E. Cor. N.W. Cor.
 Sec. 7, T27S, R2E
 6th P.M.

**PRELIMINARY PLAT OF
 NORTHBOROUGH 2nd Add.
 Wichita, Sedgwick County, Kansas.**

OWNER: T. I. Leben, etal
 105 S. Broadway, Suite 640, 67202

DEVELOPER: Manor Care of Kansas
 c/o Bud Brown
 1940 Old Tustin Ave. Santa Ana, Ca.

ENGINEER: P. E. C. p.a
 1440 English, 67211

1" = 100'
 B.M. Disc 45.4' east &
 45.5' north of & inter-
 section of Woodlawn &
 21st St. north
 Elev. = 200.65 City Datum.
 Revised Topo of 10-28-85
 Note:
 for Setback Lines See
 C.U.P. D.P.-67

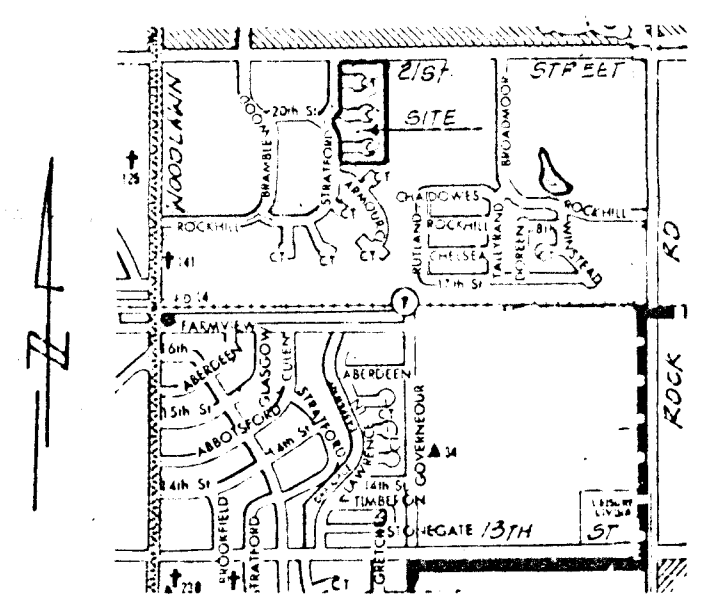

AREA MAP
 Date: March 13, 1986