

BENCH MARK:
 City Standard Disc. 32'E & 23.5'
 S of E of 17th St N of Sheridan
 Elev. = 125.146 City Datum

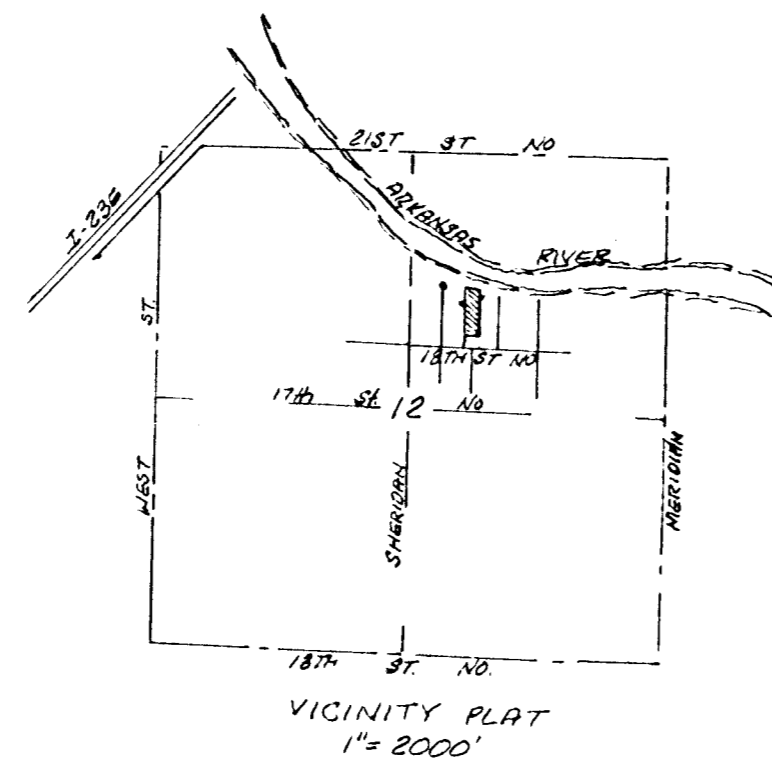

PRELIMINARY PLAT
PHILLIPS RIVERSIDE ADDITION

PART OF THE NE 1/4 OF SEC. 12, TWP. 27-S, R-1-W OF THE
 6TH. P.M., SEDGWICK COUNTY, KANSAS

WAYNE PHILLIPS