

④
 Area = 67
 C = 0.5
 $T_c = 30$ minutes
 Q = 228 c.f.s.
 24+30'

③
 Area = 92 acres
 C = 0.5
 $T_c = 30$ minutes
 Q = 313 c.f.s.
 44+5'

②
 Area = 82 acres
 C = 0.5
 $T_c = 30$ minutes
 Q = 279 c.f.s.
 54+30'

NOTE: A DRAINAGE CONCEPT PLAN IS TO BE PREPARED BY MID-KANSAS ENGINEERING
 M.H. #4 TOP - 193.0
 F.L. - 190.07
 8" STUBS N. & S. - 180.65
 M.H. #5 TOP - 197.5
 F.L. - 193.43
 8" STUBS N. & S. - 184.01

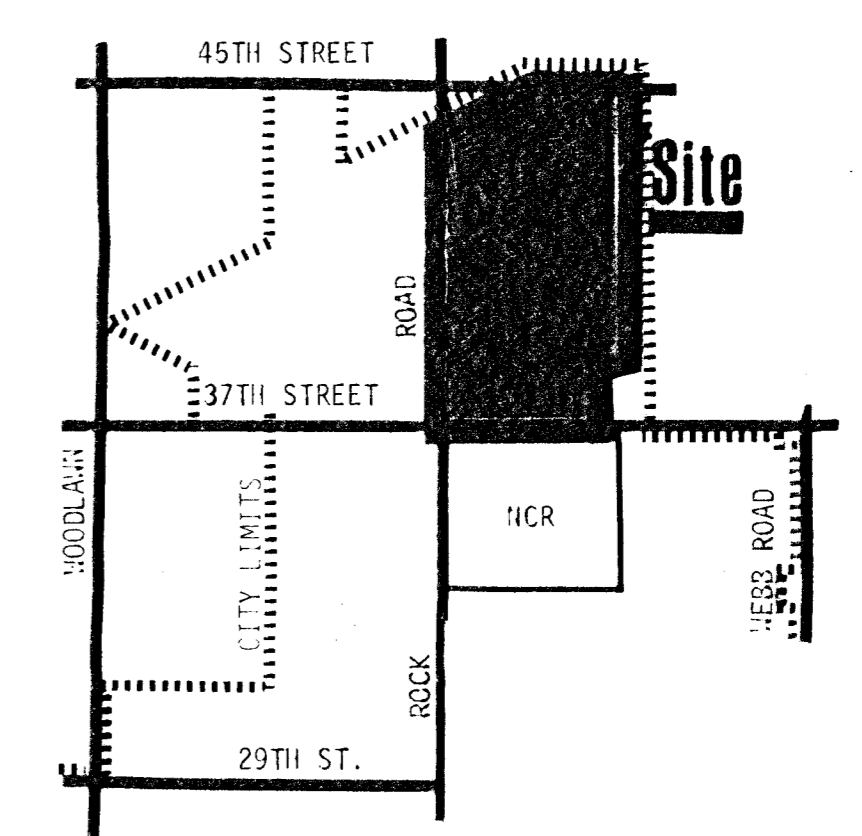

LOCATIO



NORTH POINT INDUSTRIAL PARK 2NC DRAINAGE CONCEPT PLAN

① Area = 60.3 acres C = 0.5
 $T_c = 30$ minutes
 Q = 297.2 c.f.s.



MID-KANSAS ENGINEERING CONSULTANTS PA 240N ROCK ROAD WICHITA, KANSAS 672-0561