

LAKESIDE MOBILE HOME PARK SECOND ADDITION

WICHITA, SEDGWICK COUNTY, KANSAS

UNPLATTED
WILLIAM P. ALCORN
ZONED E

1385 66

SCALE 1"=100'

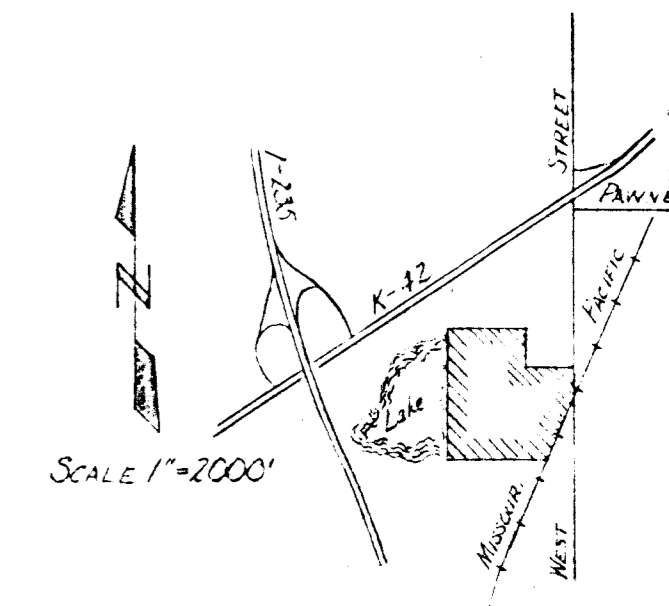

LOCATION MAP

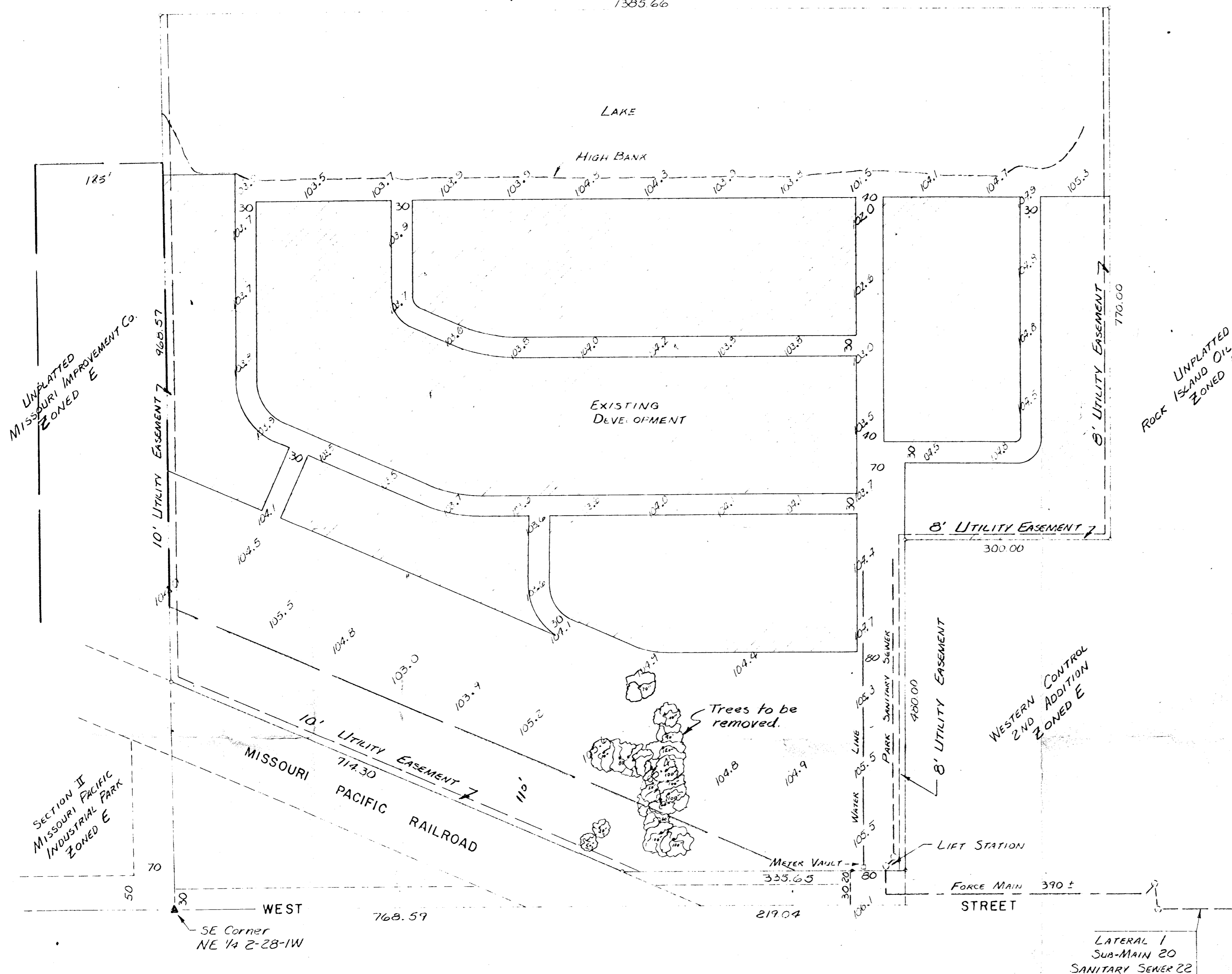

OWNERS
William P. Alcorn, Golda M. Alcorn
and Ruth E. Slagle

DATE OF SURVEY
JULY 1977

BENCH MARK
B.M. E.I. 108.25 + on SW Corner
South Headwall RCBC, South Side, K-42
East Side West Street.

LAKESIDE MOBILE HOME PARK 2625 SO. WEST ST. WICHITA, KANSAS	
PRELIMINARY PLAN LAKESIDE MOBILE HOME PARK SECOND ADDITION	
CAMPBELL & CASTLE ENGINEERS WICHITA, KANSAS	DSG DR CH APP
DATE JULY 1977	DWG FILE NO 7653-D-10,128 SHEET NO 1 OF 1