

LEGEND

- Drainage Direction - Minor Storm
- ⇨ Drainage Direction - Major Storm
- Proposed SWS + Inlet
- Existing SWS + Inlet
- VG. Proposed Valley Gutter

N
W + E
S

SCALE: 1"=80'

NOTES:

PLAT IS SUBJECT TO GENERAL PROVISIONS OF TALLGRASS II CUP DP-163

DRAINAGE CONCEPT PLAN TO BE PREPARED BY P.E.C. AND SUBMITTED TO CITY ENGINEER.

RESERVES "A THRU G" SHALL PERMIT LANDSCAPING, ENTRY MONUMENTS, WALKS AND UTILITIES CONFINED TO ESMTS.

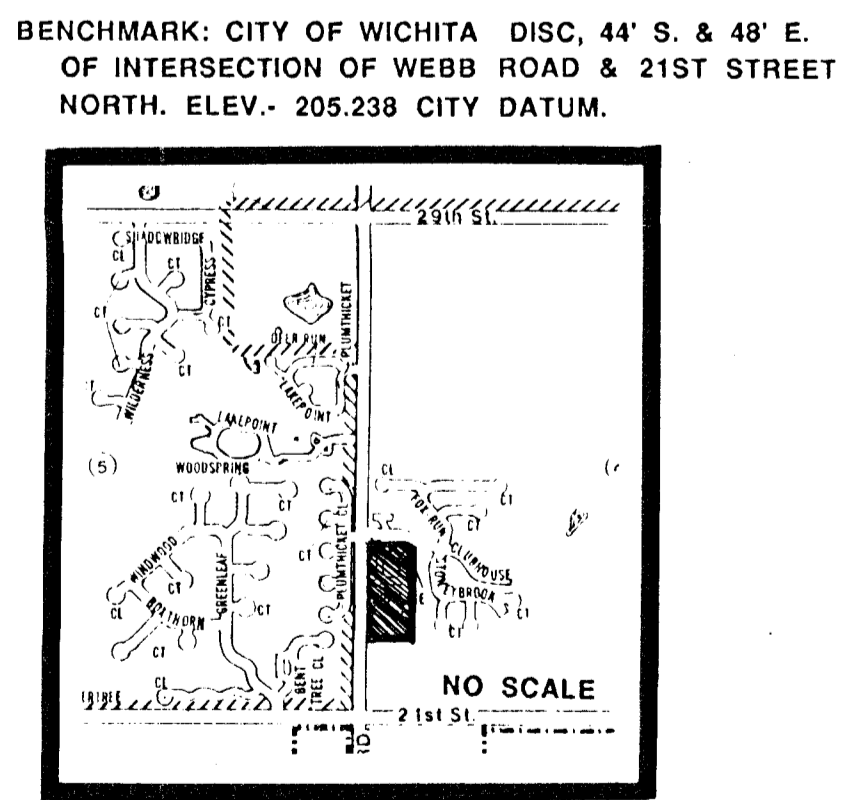

LOCATION MAP

DRAINAGE CONCEPT 1/11/91
A REPLAT OF A PORTION OF TALLGRASS EAST ADDITION.

TALLGRASS EAST 5TH ADDITION

OWNER: RITCHIE ASSOCIATES, 8100 E. 22ND ST. NO. BLD. 1000, WICHITA, KANSAS 67226