

- NOTES:
1. BENCHMARK:
R.R. Spike in Utility Pole, 48' West and 40' South of the S.W. Cor. Sec. 27, T27S, R2E
Elev. 157.19 City Datum
 2. Reserves "A", "B", "C" shall permit entry features, signage, irrigation, walls and entry monuments, walks, lighting, landscaping, berms, and utilities confined to easements.
 3. Reserves "C", "D", "E", shall permit walls, signage, playground equipment, swimming pools, parking, gazebos, small park structures, picnic areas/tables with overhead structures, irrigation, walks, lighting, landscaping, berms, lakes, drainage, drainage structures, and utilities confined to easements.
 4. Reserves "F" shall be reserved as an Emergency Access Easement and shall permit street paving, utilities, drainage, and drainage structures.

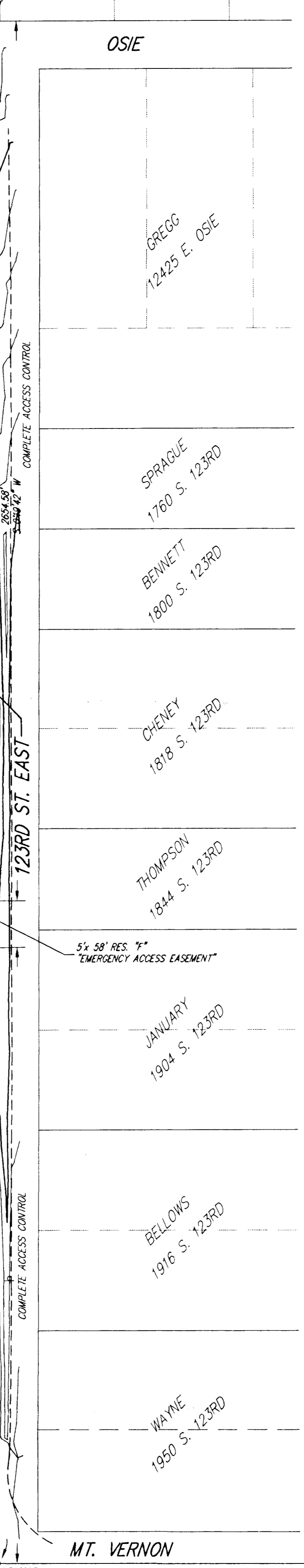

REVISED PRELIMINARY PLAT TARA FALLS ADDITION SEDGWICK COUNTY, KANSAS

OWNER:
TERRA PROPERTIES, INC.
GENE VITARELLI, PRESIDENT
321 N. MONTEBELLA CIR.
WICHITA, KANSAS 67230

LEGAL DESCRIPTION:
The W1/2 of the NE1/4 of Sec. 34, Twp. 27-S, R-2-E of the 6th P.M.,
Sedgwick County, Kansas.

(316) 733-2673

DWG FILE: C0758PP
PROJECT NO. 97B00758

SRB
SAVOY, RUGGLES & BOHM, P. A.
ENGINEERING & SURVEYING

924 NORTH MAIN
WICHITA, KANSAS 67203
316-264-8008
FAX 264-4621

REV. 11 DEC. 97
REV. 4 NOV 97
27 AUG 97

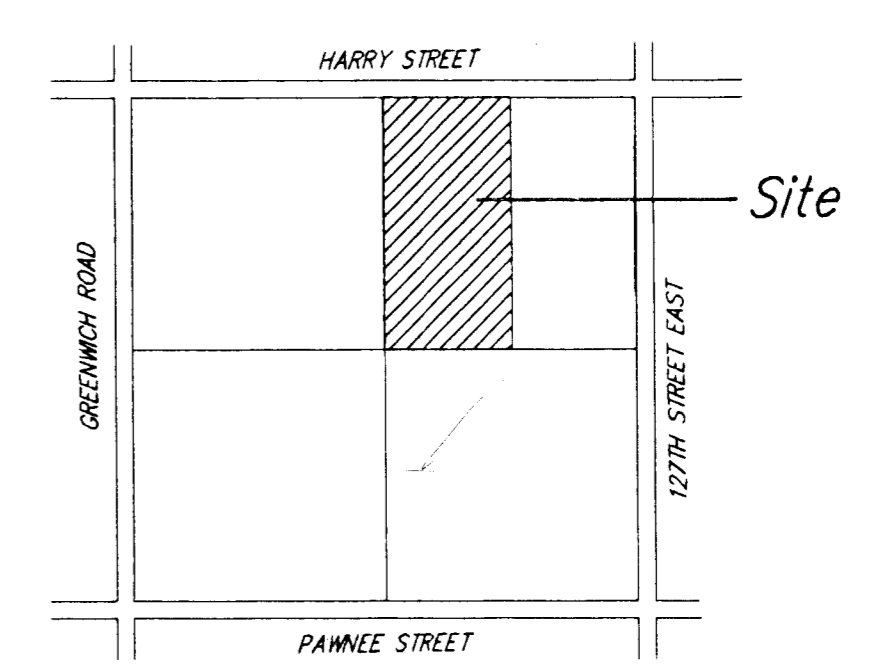

LOCATION MAP
NO SCALE