

REGRADE MAIZE ROAD DITCH FROM FIELDCREST, NORTH TO DRAINAGE CHANNEL

N.E. COR NE1/4, SE1/4 SEC. 31, TWP 27-S, R-1-W

N.W. COR NW1/4, SW1/4 SEC. 32, TWP 27-S, R-1-W

LEGAL DESCRIPTION:  
PART OF THE NE1/4 OF THE SE1/4 OF SEC. 32, TWP 27-S, R-1-W OF THE 6TH P.M., SEDGWICK COUNTY, KANSAS.

STORM WATER SEWER TO ROUTE TO EXISTING POND EAST OF PRAIRIE WOODS.

LEGAL DESCRIPTION:  
PART OF THE NW1/4 OF THE SW1/4 OF SEC. 31, TWP 27-S, R-1-W OF THE 6TH P.M., SEDGWICK COUNTY, KANSAS.

# DRAINAGE CONCEPT (5-29-97)

## LINDSAY'S ORCHARD

### WICHITA, SEDGWICK COUNTY, KANSAS

(217 Lots Residential SF-6 Zoning)

- NOTES:
- City of Wichita Benchmark disc @ Maize Road and May Street 31.5' S. and 38' E. of centerline both. Elev. 137.67 (City Datum) Elev. 1325.07 (NGVD)
  - Topography by Savoy, Ruggles, and Bohm, PA. 1996

OWNER:  
RICK THOMPSON  
250 N. GLENEAGLES CT.  
WICHITA, KANSAS 67212  
(316) 722-2122

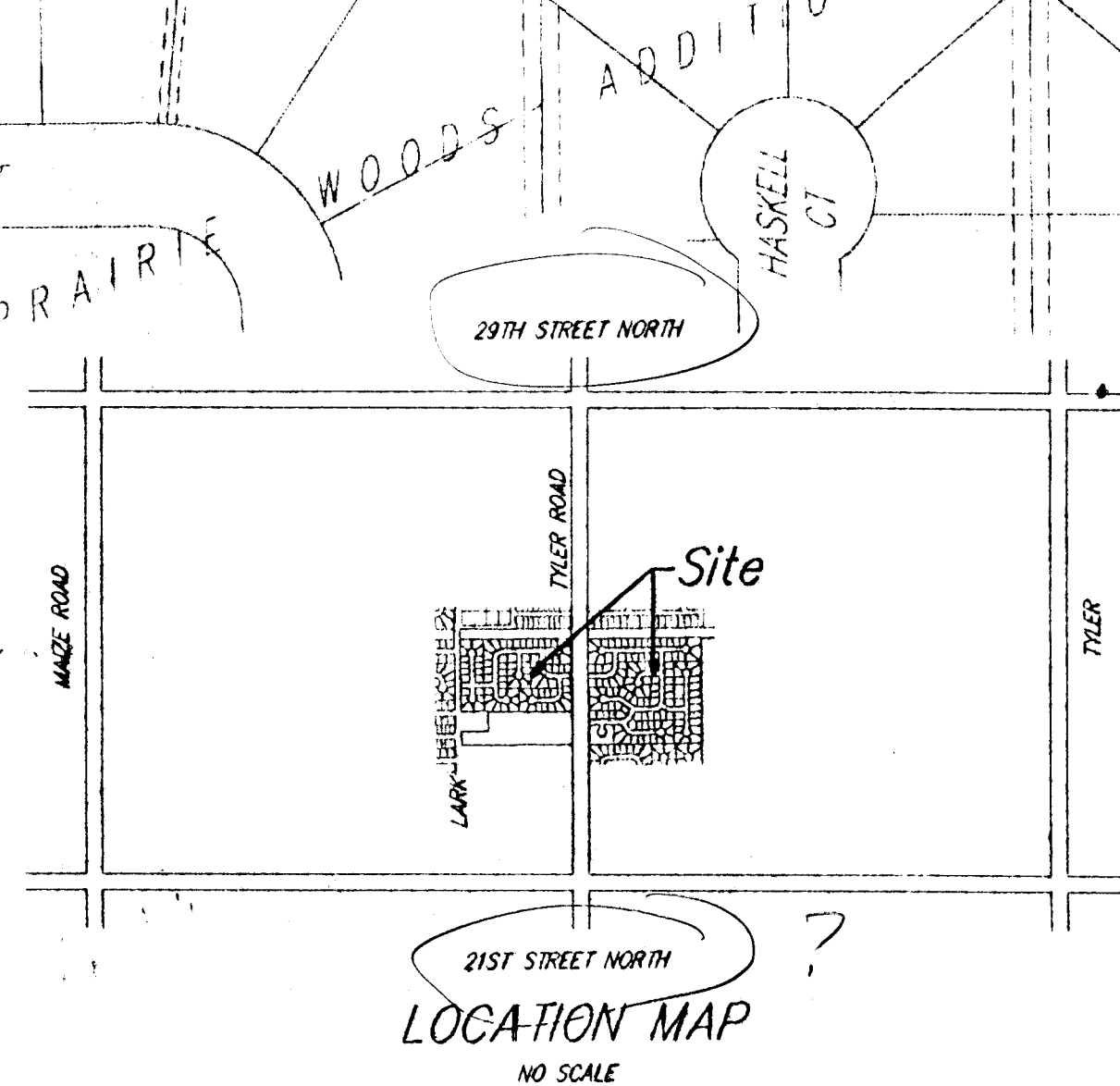

**SRB**  
224 NORTH MAIN  
WICHITA, KANSAS 67203  
SAVOY, RUGGLES & BOHM, P. A.  
ENGINEERING & SURVEYING

1" = 100'  
31 MARCH 97

COMBINED DWG FILE 03050P - S.A.V.  
DWG FILE 00535P - R.C.