

DRAINAGE CONCEPT  
 LOTS TO DRAIN TO STREET  
 AS SHOWN BY ARROWS.

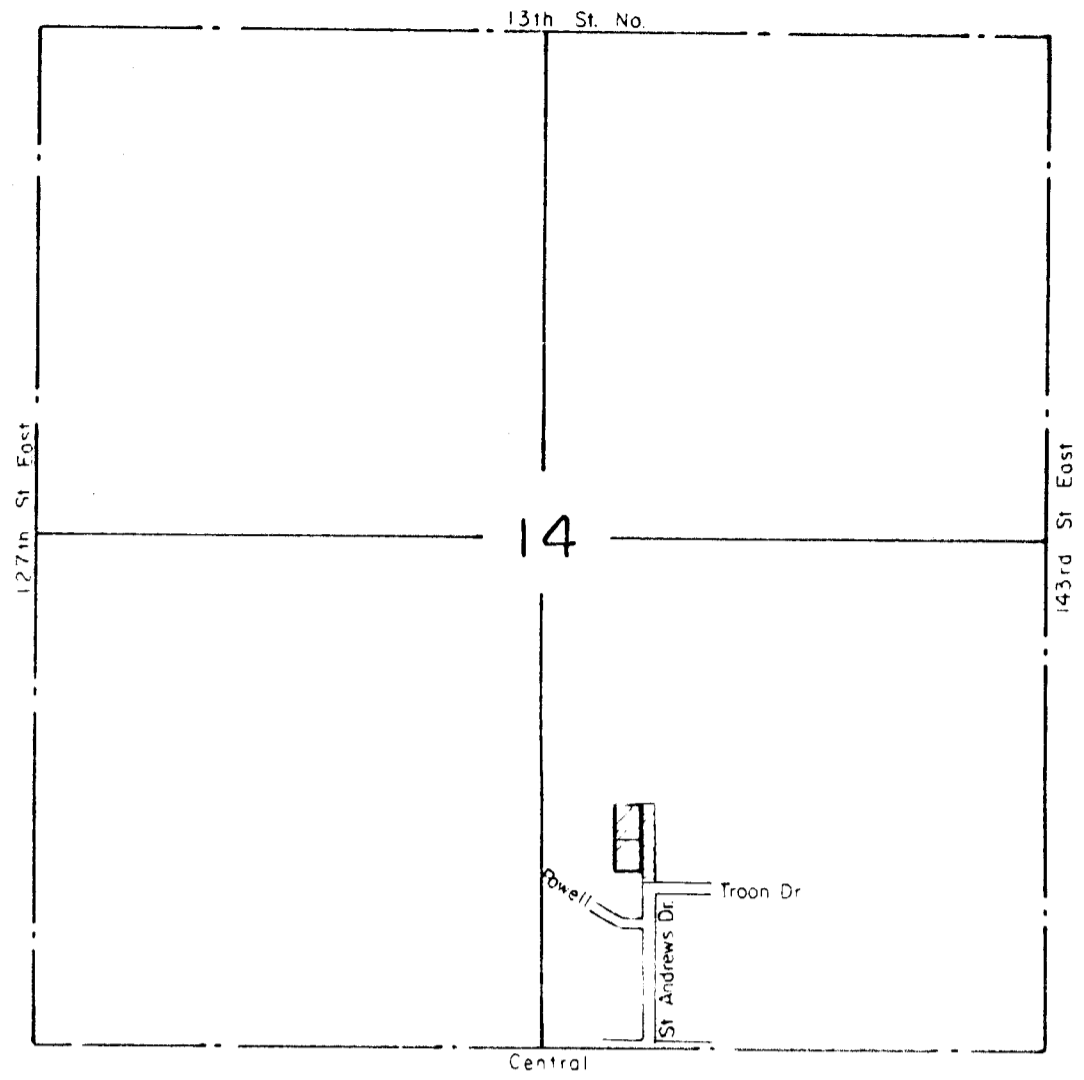

VICINITY MAP

"UNPLATTED"

PRELIMINARY PLAT  
 SOUTHCREST FOUNTAIN ADD.  
 SEDGWICK COUNTY, KANSAS

FOR: BUD GATES AND  
 RICHARD BURKHART

HI-TECH SURVEYORS, INC.  
 334 S. LAURA  
 WICHITA, KS 67211

B.M. - ELEV. 1343.95 -  
 on top of curb on the east side  
 of St. Andrews at the north line of  
 Troon.

TOPO MADE MARCH 5, 1990.