

Scale: 1"=50'

B.M. 93.61 - City Std. Obs.
84' N. & 92' N. of 1/4 Sec. Cor. of
MacArthur Rd. & Clarence.

1328.3' N. & 200.0' E. of
S.W. Cor. 7-28-16.

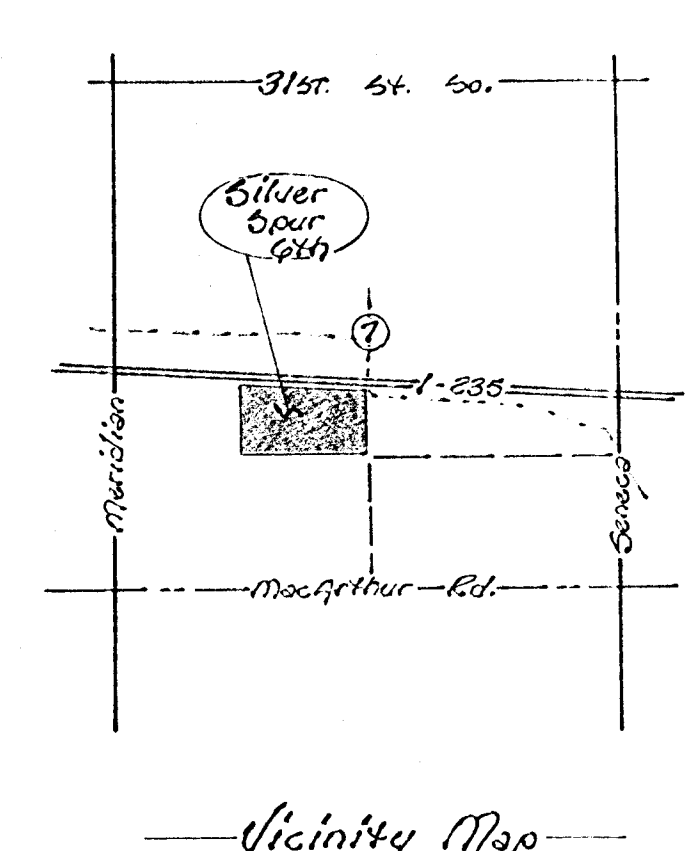

Preliminary Plat
SILVER - SPUR 6TH ADDITION
 Part of N 1/4, SW 1/4, 7-28-16
 Except W. 1290'.
 Owner - Seneca Construction Co., Inc.
 C.J. Mendenhall, Pres.