

# DRAINAGE PLAN

## ST. MARY'S MISSIONARY BAPTIST CHURCH ADDITION

### WICHITA, SEDGWICK COUNTY, KANSAS

SCALE  
1" = 40'  
● = IRON  
CONTOURS @ 1' INTERVALS

LEGEND

○ <sup>(F)</sup> - FIRE HYDRANT	● <sup>(V)</sup> - VALVE BOX
● <sup>(G)</sup> - GUARD POST	○ <sup>(S)</sup> - SIGN
● <sup>(G)</sup> - GM/WM	□ - A.C.
□ <sup>(S)</sup> - SWB FED	○ <sup>(L)</sup> - LIGHT POLE
□ - SWB DUCT	□ <sup>(P)</sup> - POWER POLE
⌋ - GUY WIRE	○ <sup>(M)</sup> - SWB MANHOLE
○ <sup>(V)</sup> - IRRIGATION CONTROL VALVE	

LEGAL

A replat of Lots 8, 10, 12, H. ROBINSON'S ADDITION, Wichita, Kansas, together with the west 1/2 of alley lying east of and adjacent to said Lots; Lots 14, 16, 18, H. ROBINSON'S ADDITION, Wichita, Kansas, together with all of alley lying east of and adjacent to said Lots, together with an unplatted tract of land in NE 1/4 Sec. 9-27-1E.

BENCHMARK

Brass rod in concrete post, 24' east 25.5' north of intersection of centerlines of 17th Street and Hydraulic Avenue. Elev. = 117.25

OWNER

Greater St. Mary's Missionary Baptist Church  
Attn: Oscar Jones  
3901 E. 28th St. N.  
Wichita, Kansas 67220  
(316) 686-6030

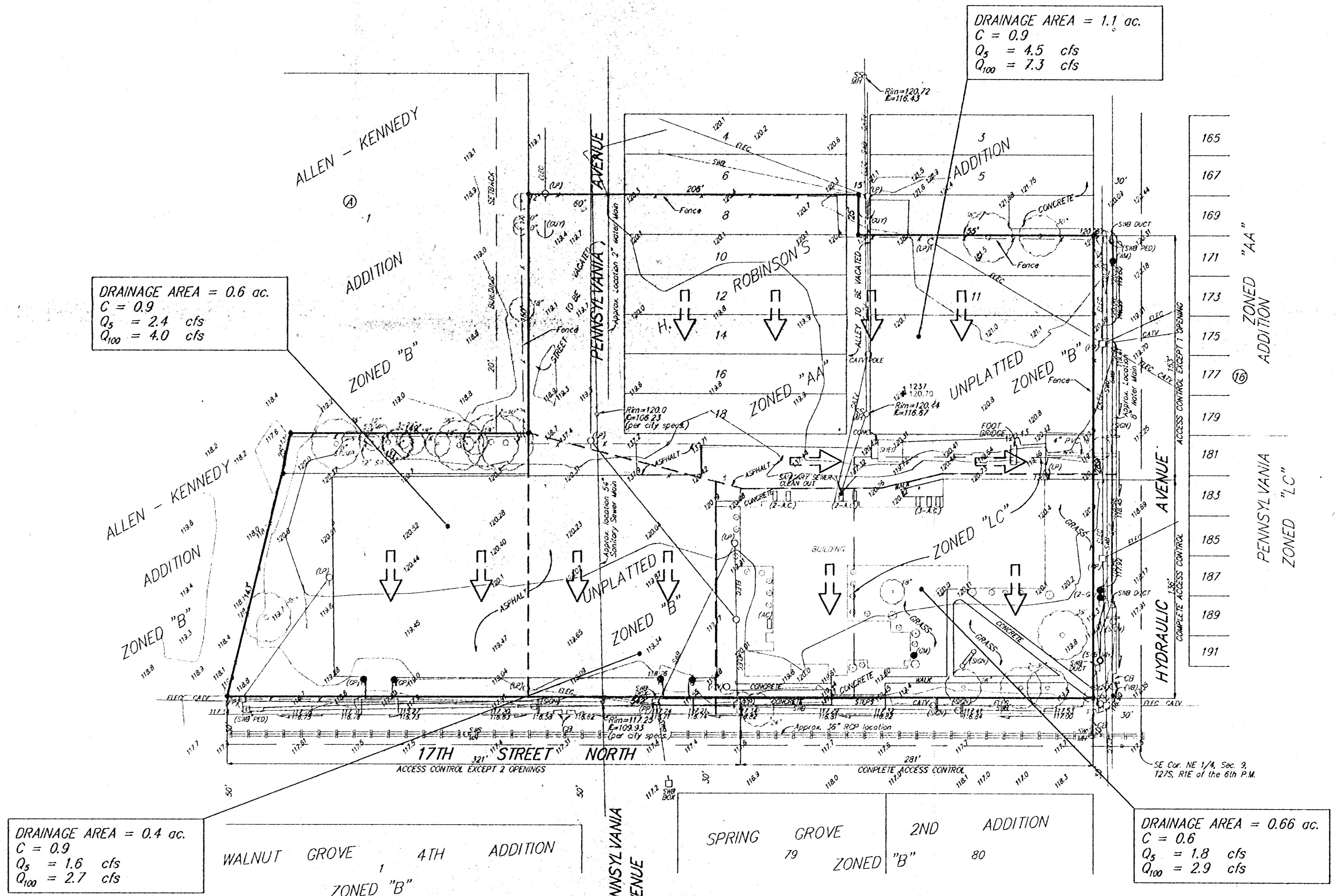

January 30, 1995