

Commencing at the NW corner of the SW/4 of Section 7, T-26-S, R-1-E, of the 6th P.M., Sedgwick County, Kansas; thence S0°00'00"E 735.13 feet along the west line of said Section 7 to the True Point of Beginning of this tract; thence S89°54'21"E 629.58 feet; thence S0°08'30"E 469.33 feet; thence S89°47'50"W 189.40 feet; thence S1°17'52"E 27.38 feet; thence S88°39'17"W 442.08 feet; thence N0°00'00"E 508.79 feet along the west line of said Section 7 to the True Point of Beginning.

Bearings based on the west line of Section 7 being north-south.

Thus described tract contains 7.135 acres.

I, Robert L. Blubaugh, Kansas Registered Professional Engineer P.E. 7647, do hereby certify that the above plot of a tract of land was surveyed on the ground under my supervision and is true and correct to the best of my knowledge.

*Robert L. Blubaugh*

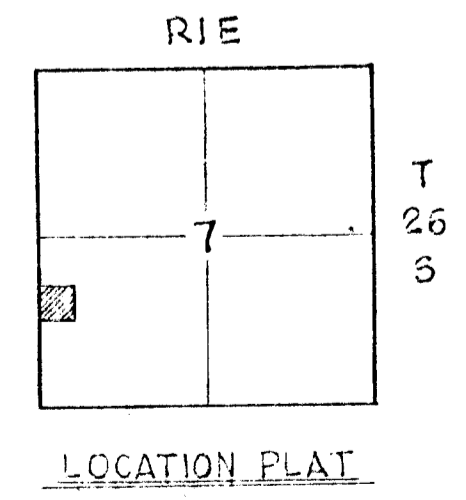

3	10-15-88	GENERAL REVISION	CKD	APD	
2	2-2-85	REVISE TOWNSHIP NO.	CKD	APD	
1	2-14-85	ORIG. PER SURVEY	CKD	APD	
ISU	DATE	DESCRIPTION	BY	CKD	APD
<b>CONOCO INC.</b> ENGINEERING CENTER PONCA CITY, OKLAHOMA					
<b>TOPOGRAPHY AND PLOT PLAN</b> <b>VALLEY CENTER PUMP STATION</b> SCALE: 1" = 50'					
APPD: <i>R. J. G. 2/15/85</i>	SHT. NO.	UNIT	AREA		
DATE: 2-15-85					
NO.					ISSUE

BRUNING 40-21-52296