

GENERAL NOTES

Lot 1 will be developed for a church site. The majority of the lot drains south into a drainage lake and pond located at the southwest corner of the plat. The general drainage pattern established here conforms to the areas and drainage plan designed for Wilderness Second Addition except that the north 50 feet will drain north to 29th St. No. and the small triangle at the southeast corner of the lot will drain west instead of east.

**DRAINAGE CONCEPT
PRELIMINARY PLAT
UNIVERSITY CONGREGATIONAL
CHURCH ADDITION**

THE NORTH 450 FEET OF THE WEST 390 FEET OF GOVERNMENT LOT 1, IN
SEC. 5, TWP. 27-S, R-2-E, OF THE 8TH P.M., SEDGWICK COUNTY, KANSAS.

**RICHARD J. HATTRUP
UNIVERSITY CONGREGATIONAL CHURCH**

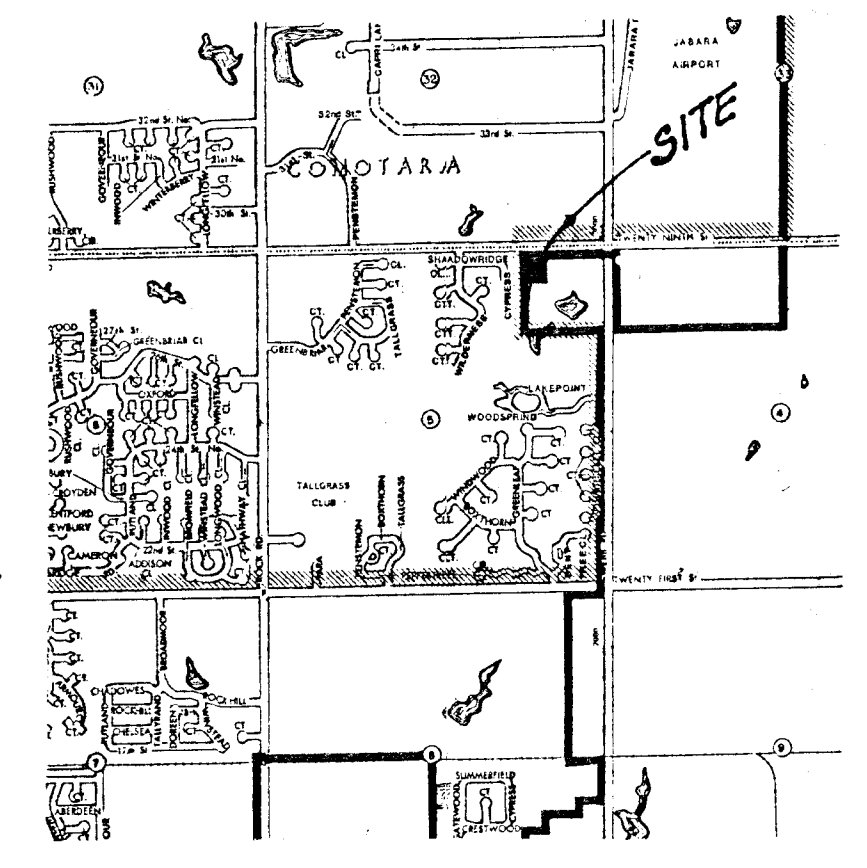

1" = 30'
Elev. = City Datum

BENCH MARK:
City Standard Box 44 N.E. 38 W. of
E. 1/2 Sec. 8, 20th St. N.
ELEVATION = 220.53 CITY DATUM