

**NOTES**

- 1) SURVEY AND TOPOGRAPHY PREPARED BY BAUGHMAN COMPANY P.A., MARCH 15, 1991.
- 2) BENCHMARK: TOP OF CURB APPROXIMATELY 24' NORTH OF S.W. COR. S.E. 1/4 SEC. 18, TWP. 27S, R1W. ELEV.- 1338.45

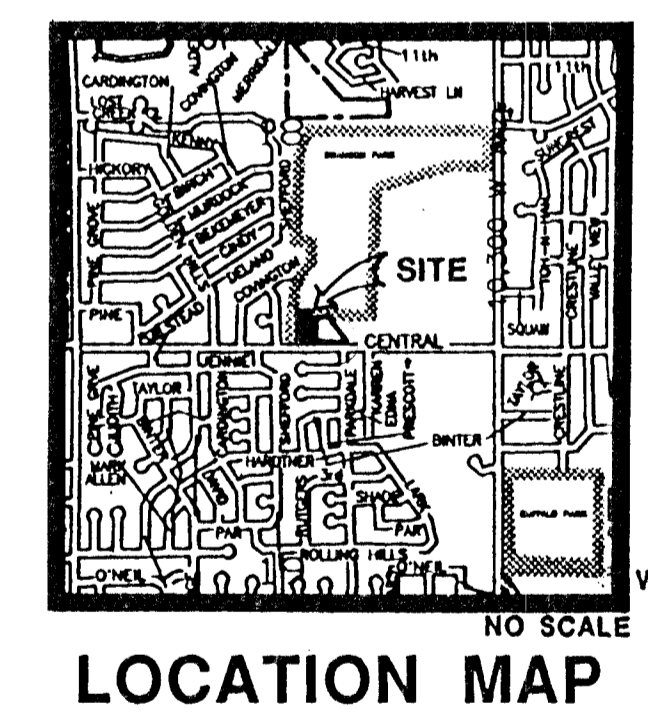
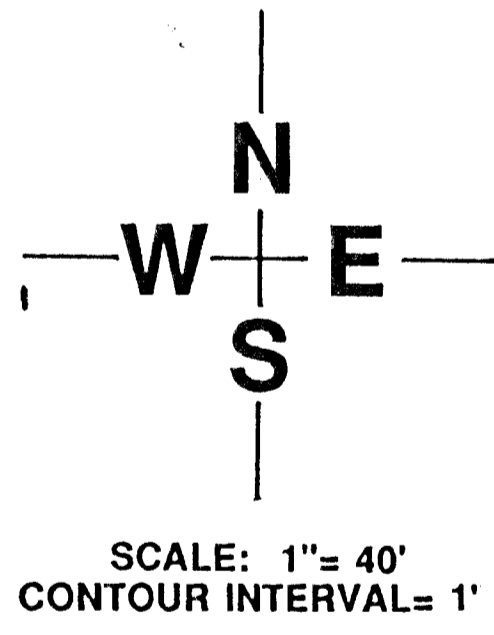

**PRELIMINARY PLAT**  
**OGDEN**  
**DRAINAGE CONCEPT**  
**ADDITION**

OWNER : MAX & DEBBIE OGDEN - 9424 W. 12TH ST., WICHITA, KANSAS 67212

DRAINAGE CONCEPT:  
**BAUGHMAN COMPANY, P.A.**  
 SURVEYING & ENGINEERING  
 316-262-7271 • 315 ELLIS • WICHITA, KANSAS 67211

8-27-91

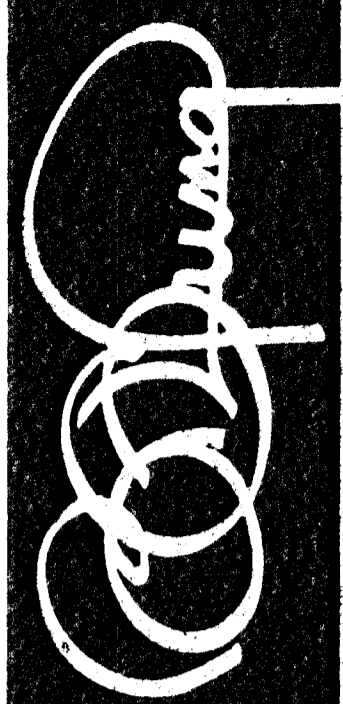

**BILL G. YUNG DESIGN**  
 4912 E. 20TH STREET NORTH  
 WICHITA, KS. 67220  
 316-683-5567

DATE: AUGUST 23, 1991  
 REV.

SHEET TITLE  
 PRELIMINARY PLAT

PROJECT  
 OGDEN ADDITION

SHEET  
 OF