

SKETCH PLAT
J. W. WASHINGTON ADDITION

Lots 1, 2, 3, 4 and the south 51.32 feet of Lot 5 and Lot 6, except the south 24.1 feet of Lot 8, except the north 8.22 feet, all Lots 9, 10, Lyman's Addition to the City of Wichita, Sedwick County, Kansas. Being situated in the SE 1/4 of Sec. 9, Twp. 27-S, R-1-E.

ANTIOCH BAPTIST CHURCH
 & J. W. WASHINGTON

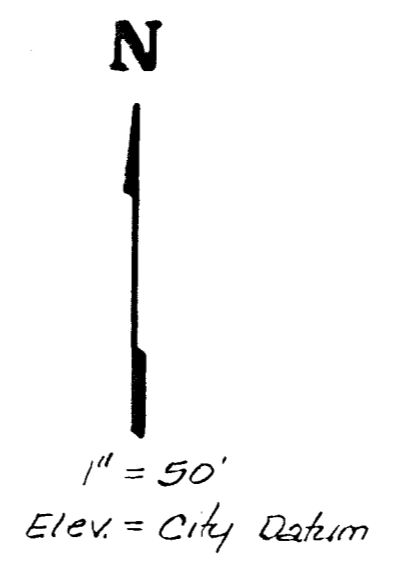

BENCH MARK:
 Brass Rod in concrete post 24'E. &
 25.5' N. of E. 17th St. No. & 14th.
 Elev. = 117.25 City Datum