

B-M-169-95 City STD. Dec. TYLER RD. & 21TH ST. N. 38' W. & 90' S. Of C. Both.  
 B-M-172-48 TYLER RD. & 17TH N. City STD. Dec. 31' S. & 36' E. Of 1/4 Sec. Cor.  
 B-M-168-33 Hub of W-L. TYLER & WESTLAWN  
 B-M-171-53 " " " " & JAMESBURG  
 B-M-155-46 □ Cut On Top Curb. Just E. Of Inlet S-S. 17TH ST. E. Of WESTFIELD  
 Base line is N-L. 17TH ST.

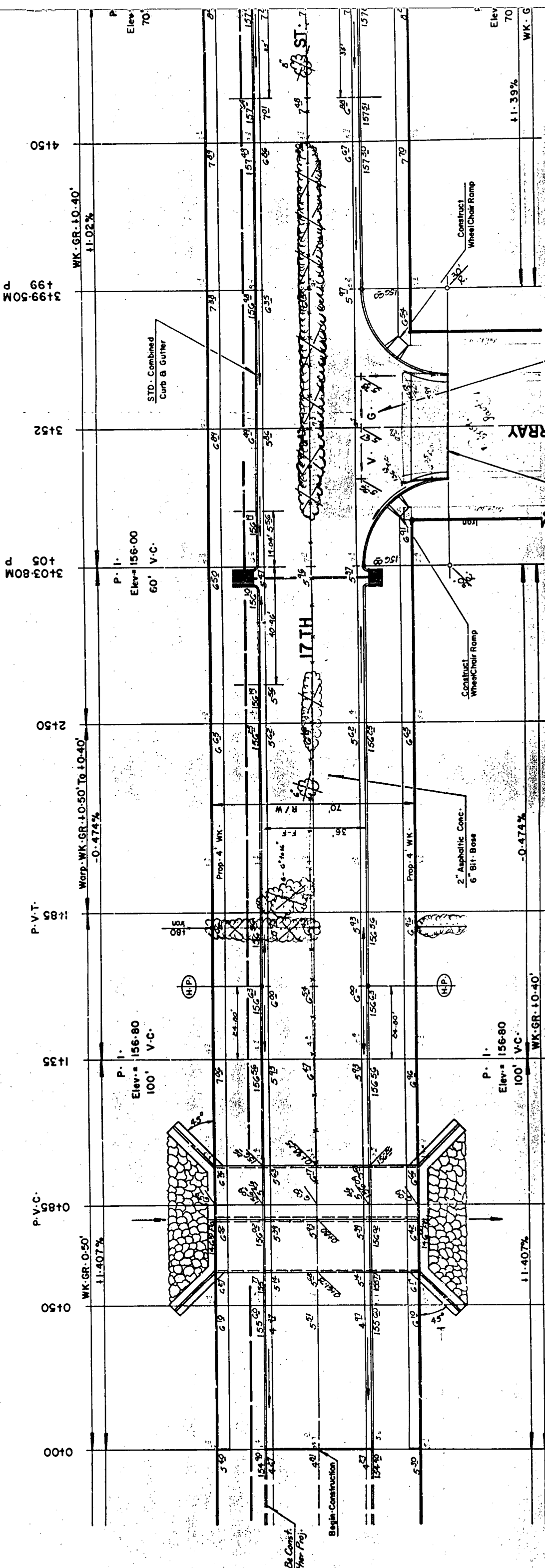

EXCAVATION	PROP.	CITY
10%	12216.43	1825.59
TOTAL	1221.64	182.56
Comp. Fill	13438.07 c y	2008.15 c y
10%	554.97	82.93
TOTAL	55.50	8.29
Manipulation	610.47 c y	91.22 c y
	28674.173 y	4284.99 y

- INTERSECTION QUANTITIES**
- 67.3 S.V. Pavement Removal
  - 162.8 S.V. " " Asphaltic Conc. Pavement (L.C. - Bituminous Base)
  - 6.2 S.V. " " Bituminous Base
  - 14.3 L.F. Combined Curb & Gutter
  - 22.4 L.F. Integral Curb
  - 31.3 S.F. 4" Wheelchair Ramp
  - 27.4 S.F. 4" W.K.
  - 124.8 C.V. Excavation
  - 699.1 Lbs. Reinforcing Steel
  - 234.0 S.V. Manipulation
  - 31.2 Tons Lime or Cement
  - 116.2 S.V. V.C. " Concrete & " Asphaltic Concrete Base
- 6 - 3" F. Walk Removal  
 56.7 - L.F. Street Joint

**SUB-GRADE**  
 TYPE OF SUB-GRADE TREATMENT SHALL BE DETERMINED BY THE FIELD ENGINEER. SUB-GRADE TREATMENT MAY CONSIST OF LIME TREATMENT, CEMENT TREATMENT, SUB-GRADE MODIFICATION OR ANY COMBINATION OF THESE.

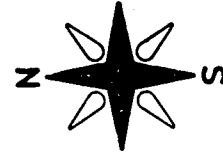

Scale: 1" = 20'

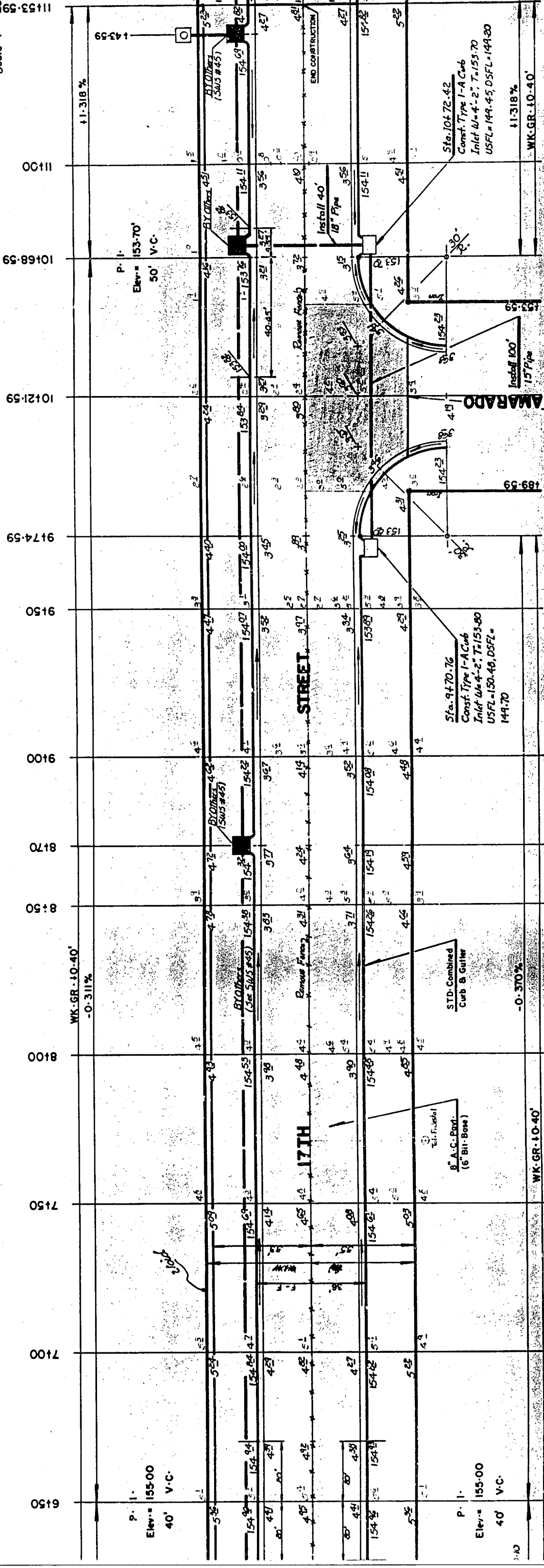

INTERSECTION QUANTITIES

2/8" S.Y.	Concrete Pavement
10-3" S.Y.	Asphaltic Conc. Pavement (6" Bituminous Base)
350.3 LF	Embankment
350.3 LF	Combined Curb & Gutter
113.9 C.Y.	Concrete
19.4 C.Y.	Concrete
232.45 Yd.	Fill
2.9	Tons Lime or Cement
S.Y. V.O.	Concrete & Asphaltic Concrete Base

17TH STREET