

1" = 40'
ELEV = CITY DATUM

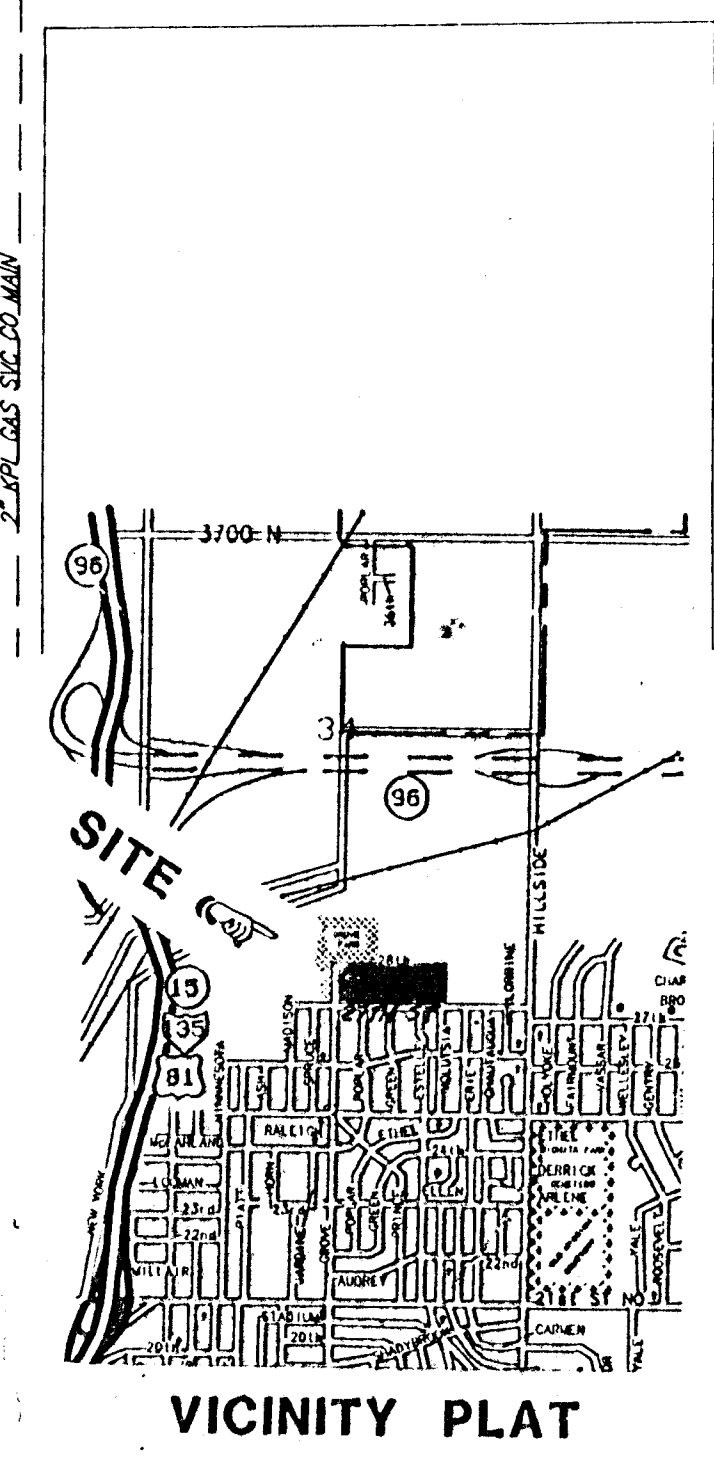

PRELIMINARY PLAT
CONQUEST NORTH ADDITION

WICHITA, SEDGWICK COUNTY, KANSAS

LOT 1, BLOCK A, CHISHOLM TERRACE ADDITION,
WICHITA, SEDGWICK COUNTY, KANSAS.

PRESENT OWNER:
CITY OF WICHITA

PROPOSED OWNER:
TIME QUEST NORTH DEVELOPMENT
AND INVESTMENT CORPORATION
% BOYD SANDERS
1341 N. GROVE
WICHITA, KS 67214
PH: (316) 264-4091

CONSULTANT:
DUBOIS CONSULTANTS, INC.
ATTN: AJAMU WEBSTER OR EDWARD LEANS
1103 E 47TH ST SUITE 225
KANSAS CITY, MO 64110
PH: (816) 756-5010

RESERVE "A" BEING RESERVED FOR RECREATIONAL
PURPOSES, TENNIS COURTS SWIMMING POOL AND
OPEN SPACE.

BAUGHMAN COMPANY P. A.
SURVEYING & ENGINEERING
316/262-7271 • 315 ELLIS • WICHITA, KANSAS 67211

"DRAINAGE CONCEPT"