

N.0°00'00"W - 508.79'
 MERIDIAN AVE
 S.0°00'00"E.
 735.13' W/4 COR SEC 7, T26S, R1E, SEDGWICK COUNTY, KANSAS

Commencing at the NW corner of the SW/4 of Section 7, T-26-S, R-1-E, of the 6th P.M., Sedgwick County, Kansas; thence S0°00'00"E 735.13 feet along the west line of said Section 7 to the True Point of Beginning of this tract; thence S89°54'21"E 629.58 feet; thence S0°08'30"E 469.33 feet; thence S89°47'50"W 189.40 feet; thence S1°17'52"E 27.38 feet; thence S88°39'17"W 442.08 feet; thence N0°00'00"E 508.79 feet along the west line of said Section 7 to the True Point of Beginning.

Bearings based on the west line of Section 7 being north-south.

Thus described tract contains 7.135 acres.

I, Robert L. Blubaugh, Kansas Registered Professional Engineer P.E. 7647, do hereby certify that the above plot of a tract of land was surveyed on the ground under my supervision and is true and correct, to the best of my knowledge.

Robert L. Blubaugh

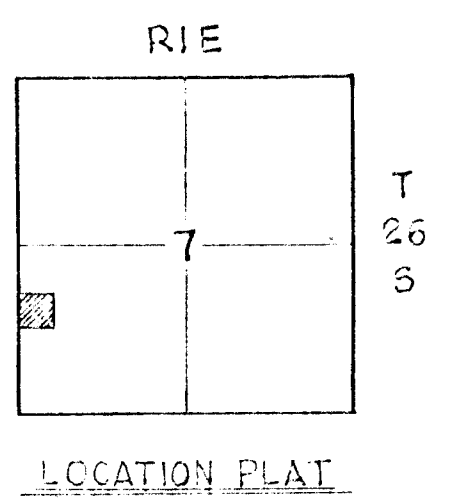

ISU	DATE	DESCRIPTION	BY	CKD	APD
3	10-15-26	GENERAL REVISION	CKD		
2	2-2-25	REVISE TOWNSHIP NO.	CKD		
1	2-14-25	ORIG. PER SURVEY	CKD		

CONOCO INC.
 ENGINEERING CENTER
 PONCA CITY, OKLAHOMA

TOPOGRAPHY AND PLOT PLAN
VALLEY CENTER PUMP STATION
 SCALE: 1" = 50'

APPD: <i>R. J. [Signature]</i>	SHT. NO.	UNIT	AREA
DATE: 2-15-25			
NO.	ISSUE		

BRUNING 4621 52296