

42" RCP @ 0.22% = 60 cfs
V = 6.2 fps
36" RCP @ 0.25% = 45 cfs
V = 6.2 fps

Q₂ = 11.6 cfs
Q₁₀₀ = 28.8 cfs
FROM RESIDENTIAL PLAT

TOTAL FLOW
Q₂ + Q₁₀₀ = 45.6 cfs
Q₁₀₀ = 92.3
BYPASS = 32.3 cfs

F.L. = 177.5

Q100 BYPASS FROM THIS AREA = 18.7 cfs

30" DRNG. ESMT. ADJ. TO BE VACATED BY PLAT.

DA = 10.8 AC.
Q₅ = 34.0 cfs
Q₁₀₀ = 63.7 cfs

NOTES:

- SEE WHISPERING BROOK COMMERCIAL C.U.P., D.P.-203 FOR ADDITIONAL PROVISIONS.
- BENCHMARK: 70' WEST AND 30' NORTH OF WOODLAWN AND 37TH ST. NORTH, CITY OF WICHITA DATUM. ELEV. 186.169.
- TOPOGRAPHY SURVEY DEC. 10, 1981 "BY OTHERS."
- CROSS LOT DRAINAGE AGREEMENTS WILL BE PROVIDED TO ALLOW THE FLOW OF DRAINAGE TO CROSS FROM ONE LOT ACROSS THE OTHER AS INDICATED ON THIS PLAN.
- OWNER HAS AGREED TO PAY UP TO \$5000 OVER THE COST OF THE ORIGINAL STORM SEWER PETITION TO PROVIDE FOR THE LARGER PIPE SIZE REQUIRED TO DRAIN THIS AREA. (SEE LETTER AGREEMENT ON FILE IN THE OFFICE OF THE CITY ENGINEER)

TIME OF CONCENTRATION

15 MINUTE MINIMUM
I₅ = 4.56
I₁₀₀ = 7.37

C FACTORS

LIGHT COMMERCIAL
C₅ = 0.69
C₁₀₀ = 0.80

SOIL TYPE

Fb - Farnum
HYDROLOGIC GROUP B

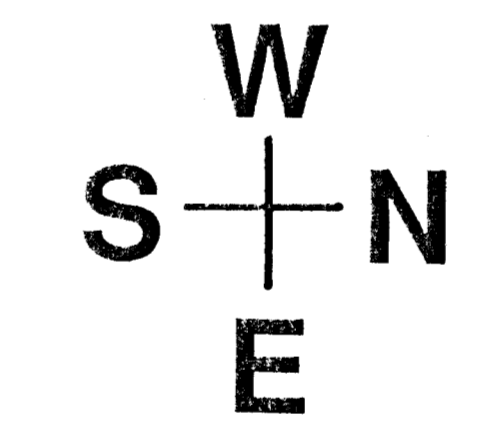

SCALE: 1" = 50'

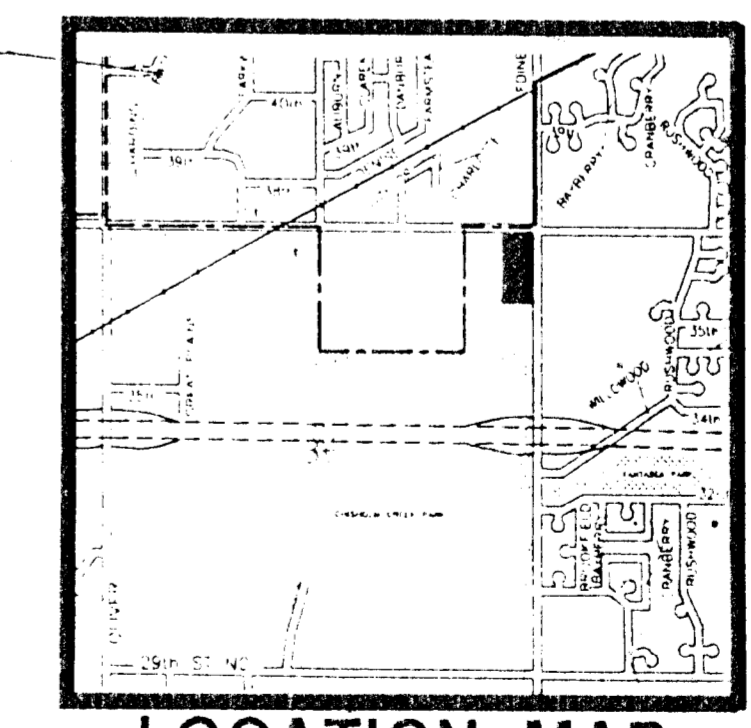

LOCATION MAP
NO SCALE

POE & ASSOCIATES OF KANSAS, INC.
Consulting Engineers
404 N. Oliver Suite 110 Wichita, KS 67208 316/854114

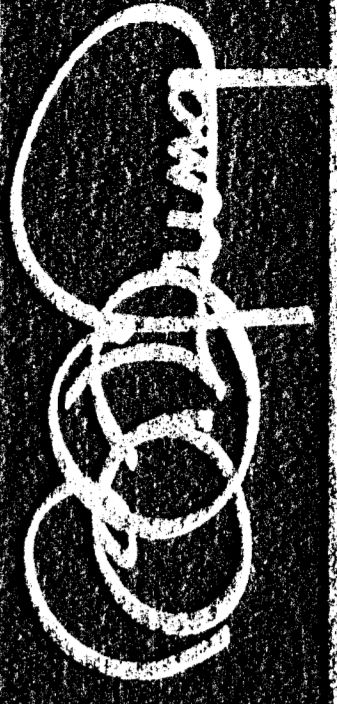

BILL G. YUNG DESIGN
404 N. OLIVER STREET NORTH
WICHITA, KS 67208
316-854-5286

DATE: APRIL 22, 1992
REV: _____

SHEET TITLE: DRAINAGE PLAN

PROJECT: WHISPERING BROOK
SHEET: _____ OF _____

DRAINAGE PLAN

WHISPERING BROOK COMMERCIAL

OWNER: NESTOR R. WEIGAND JR., LESLIE RUDD & DEBORAH FREEMAN, 151 N. MARKET, KANSAS 67202 PH. (316) 262-6400