



SAVOY, RUGGLES & BOHM, P.A.
 ENGINEERING AND SURVEYING
 924 NORTH MAIN
 WICHITA, KANSAS 67203

MEMO

Date: Wednesday, March 14, 2001

To: Vicky Huang

From: Tom Ruggles

Project: Vacation of Dora & Kessler
Street in West Warehouse Add.

SRB Project No.: 1091V

Other Project Reference No.:
MAPD case no. V-2149

Description:

- Confirmation
- Transmittal
- Transmittal under separate cover by

Purpose:

- Approval
- Review & comment
- Use
- Other: _____
- Distribution
- Information
- Record

Enclosures/Attachments:

- Prints
- Originals
- Diskettes containing: _____
- Change Order
- Shop Drawings
- Other: _____

Copies	Description
1	Letters from KGE, Peoples, SWBT
1	Utility easement exhibit

Remarks: These are affirmative responses from all of the utility companies with facilities in the vicinity, and the exhibit drawing we discussed. Please respond to MAPD requirement for acceptable easement width, or call me if you have any questions.

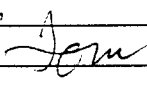
Thanks,

Copies to:

If checked below, please:

- Acknowledge receipt of enclosures
- Return enclosures to us.

Signed _____

1611 South Hoover
Wichita, KS 67209
316-942-8811
Fax: 316-942-7096
316-942-7244
316-942-0677

PEOPLES NATURAL GAS

ENERGYONE

March 8, 2001

To: Tom Ruggles
Savoy Ruggles & Bohm, P.A.
924 N. Main
Wichita Kansas
67203

From Calvin Briggs

Subject: West Warehouse addition

People Natural Gas has no facilities in the vacated areas at Dora St.
and Kessler.

If you have any questions or concerns please call (316) 941-1608

Thank you

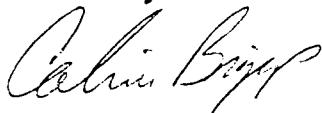

Calvin Briggs
Operations Tech

From: SHARPE, GREGORY W (SWBT) <gs76889@sbc.com>
To: 'truggles@srb1.com' <truggles@srb1.com>
Date: Thursday, March 08, 2001 6:27 AM
Subject: Street Vacation-Dora and Kessler

Tom,

We reviewed your proposal to vacate Kessler from Dora to Esthner and Dora from Kessler to the East and providing easements by separate instrument as shown on your drawing meets with SWB Telephone's approval.

Greg Sharpe
Mgr.-Engr. Design
316-268-2245

3/8/01



March 6, 2001

Savoy, Ruggles & Bohm, P.A.
Tom Ruggles
924 North Main
Wichita, KS 67203

RE: Vacation of Dora & Kessler, West warehouse Addition

Dear Mr. Ruggles,

KGE has reviewed the vacation of Dora & Kessler, West Warehouse Addition and finds the proposed easements to be satisfactory.

Thank you for sending us a copy of this proposed project and if you have further questions, please feel free to contact me at 261-6830.

Sincerely,

LaDonna Vanderford
Administrative Clerk

80' ESTHNER AVE.

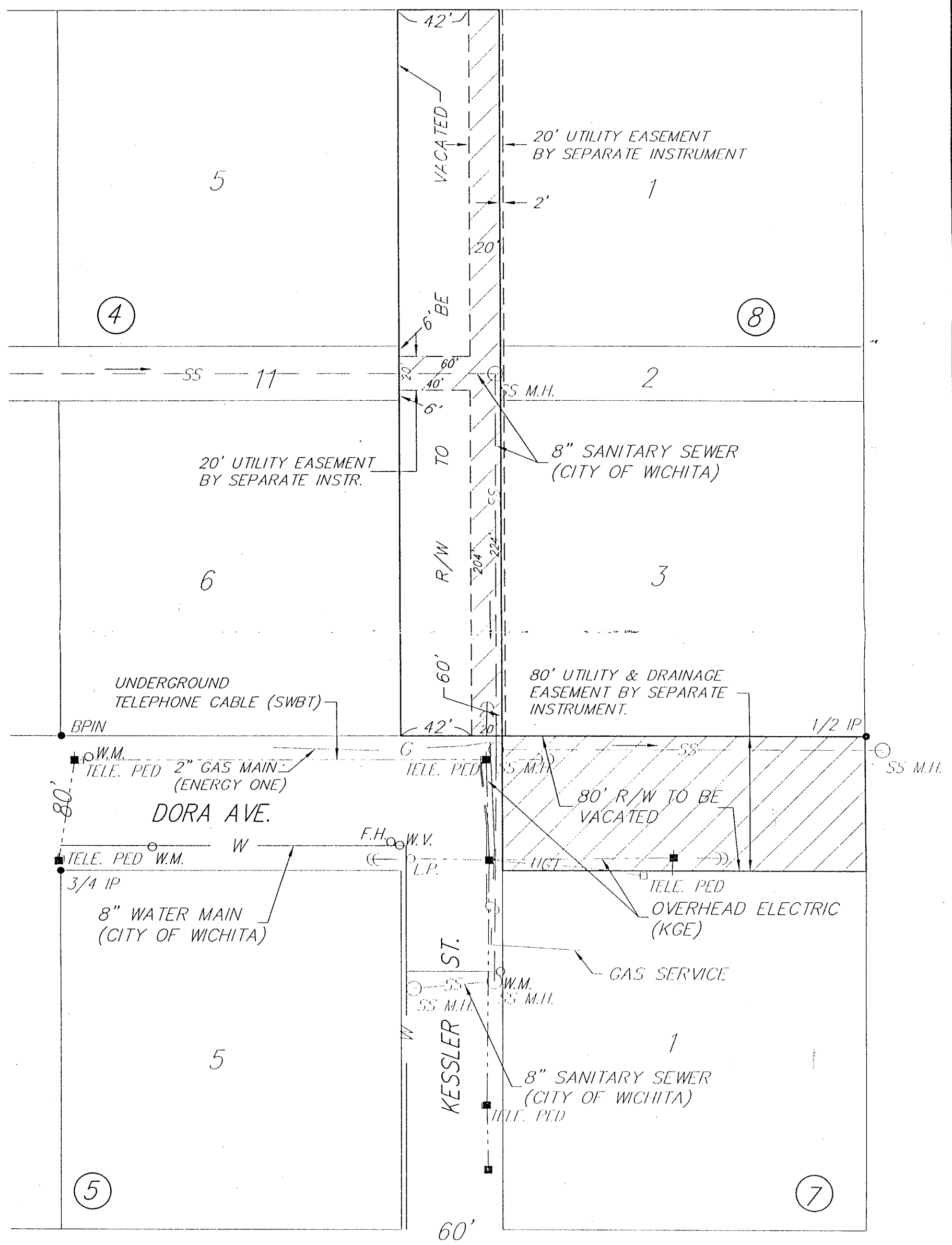

SRB

UTILITY AND EASEMENT EXHIBIT
VACATION CASE V-2149

3-2-01 JCR 1091V

SCALE 1" = 60'

SRB 924 NORTH MAIN 316-264-8008
 WICHITA, KANSAS 67203 FAX 264-4621

SAVOY, RUGGLES & BOHM, P. A.
 ENGINEERING & SURVEYING