

HIGH EDGE CURB & GUTTER
NOT TO SCALE

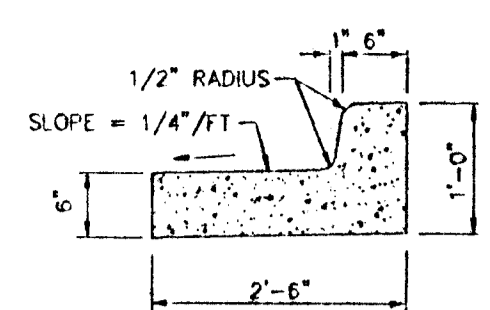

LOW EDGE CURB & GUTTER
NOT TO SCALE

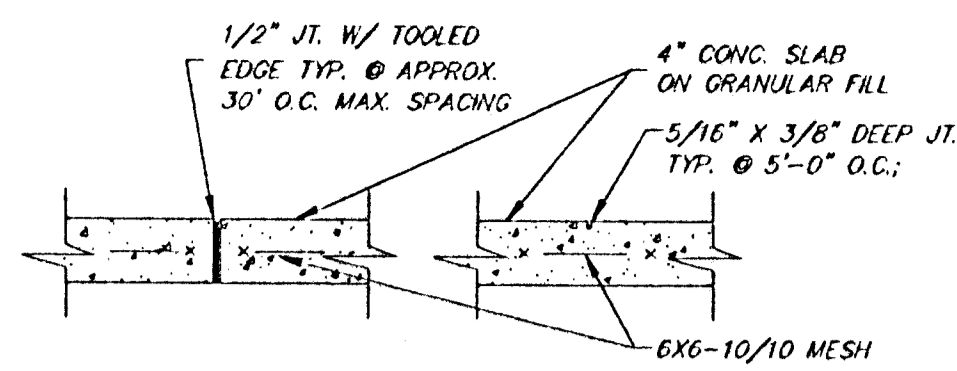

SIDEWALK JOINTS
NOT TO SCALE

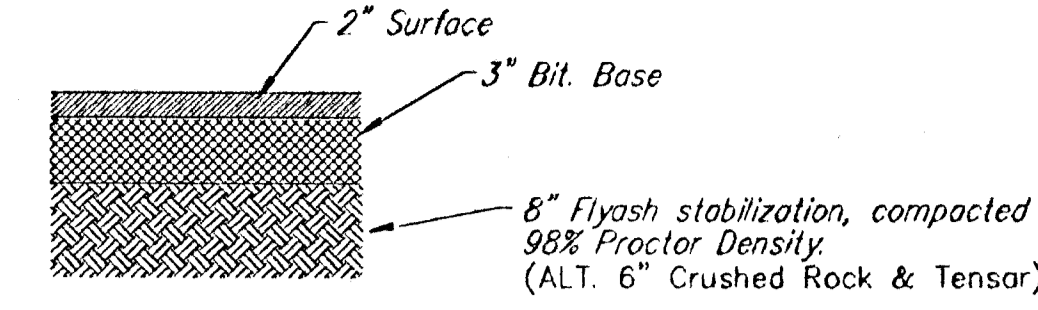

TYP. 5" ASPHALT PAVEMENT DETAIL
NOT TO SCALE

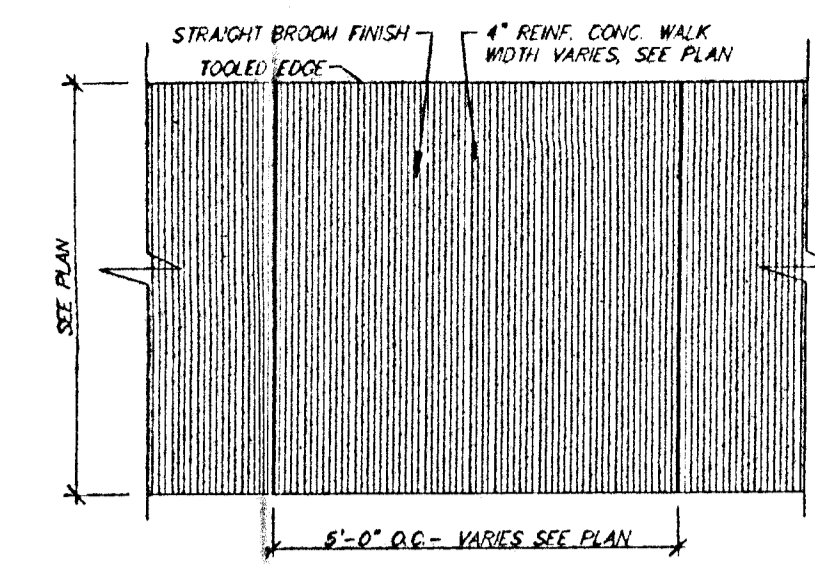

TYP. PATTERN IN WALK
NOT TO SCALE

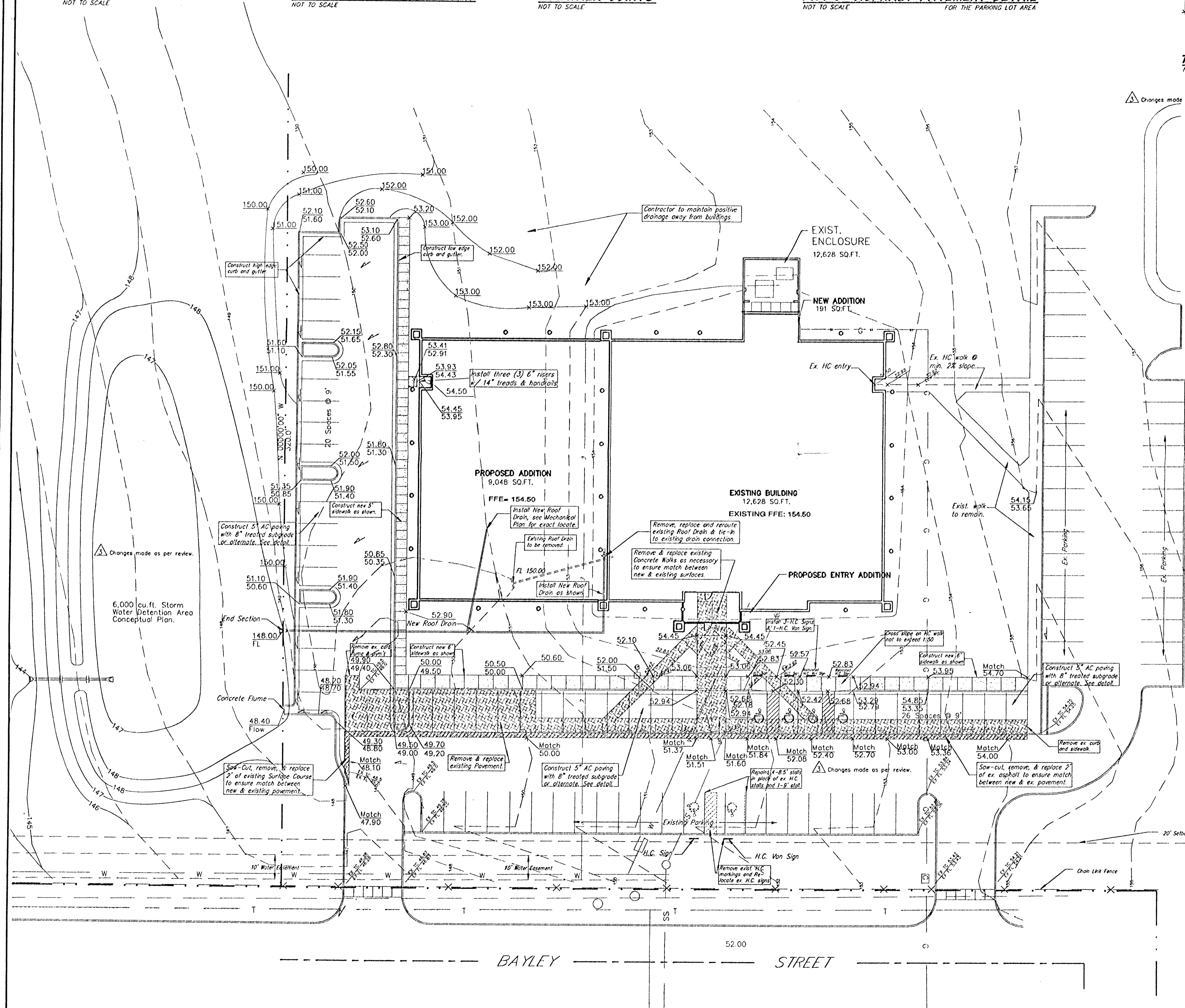

Changes made as per review.

LEGAL DISCRPTION:
BLOCK 1, LOT 1, SISTERS OF ST. JOSEPH 2ND ADDITION, AND LOT 1, BLOCK A, SISTERS OF ST. JOSEPH 4TH ADDITION.

GRADING NOTES

- Contractor will be required to provide notice to utility companies a minimum of two (2) WORKING days prior to any excavation, as follows:
Kansas One-Call 687-2470
The Contractor must notify the following in case of an emergency:
Gas Communications/Cablevision 267-4270
Kansas Gas Service Company 1-800-482-4250
Waste Energy/Electric 383-8650
Apiko Energy (Gas) 1-800-303-0357
Southwestern Bell (Telephone) 268-2745 or 800-286-8313
City of Wichita Water Dept. 268-4523 or 268-4928
City of Wichita Traffic Dept. (Traffic Control) 268-4034 or 268-4003
City of Wichita Sewer Maint. (San. Sewer) 268-4024 or 267-6000
City of Wichita Storm Sewer (Storm Sewer) 268-4090
- Exist. utilities and their locations, as shown on the plans, represent the best information obtainable for design. Location information has been obtained from the various utility companies and is either from company record drawings or company-provided field locations. The Contractor will be required to work around existing utilities which do not conflict with proposed construction.
- Traffic affected by the construction on this project shall be maintained in accordance with the Uniform Traffic Control Devices Manual on Uniform Traffic Control Devices.
- The Contractor to verify utility locations prior to construction of this project.
- Signs, striping and restriping shall be installed in accordance with City of Wichita Specifications and Codes. Striping shall be painted markings in accordance with the latest edition of the Standard Specifications for State Road and Bridge Construction by the Kansas Department of Transportation.
- Paved lot to be constructed with Asphaltic Concrete. Asphalt pavement shall be 5". Subgrade to be compacted to 98% Proctor Density and treated with 6% Fly Ash. Stabilized Refer to Pavement details to verify depths.
- Handicap accessible ramps shall be constructed at both drive approach locations. The ramps shall be constructed in accordance with ADA standards and City of Wichita Specifications.

PRINTS ISSUED		
DATE	PURPOSE	NO.
4/17/02	BDING & PERMIT REVIEW	

REVISIONS		
DATE	ITEM	NO.
6.14.02	Review Comments	1

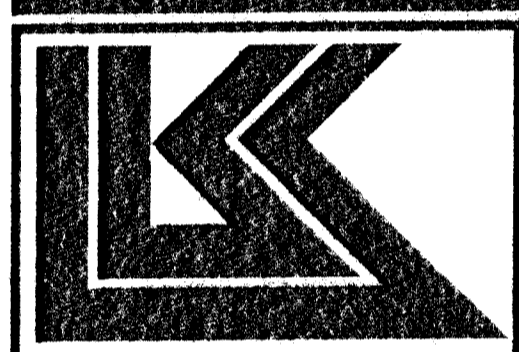

LAW/KINGDON, INC.
ARCHITECTS & ENGINEERS
345 RIVERVIEW, WICHITA, KS 67203
Phone (316) 268-0230 Fax (316) 268-0205
Copyright © 2002

ViaChristi Health System
Addition/Remodel Project

DRAWN	CHECKED
5-10-02 by SCH	NSW

RELATED DRAWINGS

SHELL	
DETAILS	
STRUCTURE	
MECHANICAL	
ELECTRICAL	
OTHER	

SEQUENCE NUMBER _____ OF _____ SHEETS

V.C.H.S. OFFICE ADDITION
3720 E. BAYLEY
WICHITA, KANSAS
PROJECT NUMBER 74470

KEY PLAN

TITLE SHEET	
SHEET TITLE	SHEET NUMBER
	G
	OF _____ SHEETS

BAUGHMAN COMPANY P. A.
ENGINEERING, SURVEYING & PLANNING
316-262-7271 • 315 ELLIS • WICHITA, KANSAS 67201
F:\Eng\ViaChristiNew\slipdon.dwg SCH