

# DRAINAGE CONCEPT

## ANGEL FIRE

### AN ADDITION TO WICHITA, SEDGWICK COUNTY, KANSAS

Drainage Area	Area (acres)	Cu	Cw	Ts (min)	Ls (ft)	Qs (cfs)	Qw (cfs)	Drainage Area	Area (acres)	Cu	Cw	Ts (min)	Ls (ft)	Qs (cfs)	Qw (cfs)
1	0.8	0.50	0.76	15	3.83	7.37	1.5	17	1.0	0.50	0.76	15	3.83	7.37	1.5
2	0.8	0.50	0.76	15	3.83	7.37	1.5	17	1.0	0.50	0.76	15	3.83	7.37	1.5
3	1.5	0.50	0.76	15	3.83	7.37	2.9	18	0.7	0.50	0.76	15	3.83	7.37	1.3
4	1.3	0.50	0.76	15	3.83	7.37	2.5	19	0.5	0.50	0.76	15	3.83	7.37	1.0
5	1.0	0.50	0.76	15	3.83	7.37	1.9	20	0.7	0.50	0.76	15	3.83	7.37	1.3
6	0.5	0.50	0.76	15	3.83	7.37	1.0	21	0.6	0.50	0.76	15	3.83	7.37	1.1
7	0.3	0.50	0.76	15	3.83	7.37	0.6	22	0.5	0.50	0.76	15	3.83	7.37	1.0
8	1.2	0.50	0.76	15	3.83	7.37	2.3	23	0.5	0.50	0.76	15	3.83	7.37	1.0
9	1.0	0.50	0.76	15	3.83	7.37	1.9	24	1.6	0.50	0.76	15	3.83	7.37	3.1
10	2.0	0.50	0.76	15	3.83	7.37	3.8	25	1.8	0.50	0.76	15	3.83	7.37	3.4
11	0.8	0.50	0.76	15	3.83	7.37	1.5	26	1.4	0.50	0.76	15	3.83	7.37	2.7
12	1.5	0.50	0.76	15	3.83	7.37	2.9	27	0.2	0.50	0.76	15	3.83	7.37	0.4
13	0.8	0.50	0.76	15	3.83	7.37	1.5	28	0.4	0.50	0.76	15	3.83	7.37	0.8
14	0.8	0.50	0.76	15	3.83	7.37	1.5	29	0.5	0.50	0.76	15	3.83	7.37	1.0
15	4.3	0.50	0.76	15	3.83	7.37	8.2	30	2.6	0.50	0.76	15	3.83	7.37	5.0

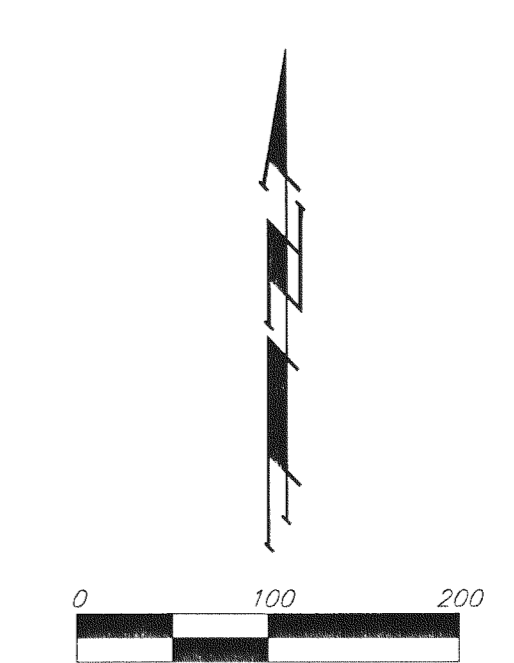

**DEVELOPER:**  
 CAYWOOD, LLC  
 ATTN: MATT ECK  
 5512 W. CENTRAL  
 WICHITA, KS 67212  
 PH. (316) 942-7402

**LEGAL DESCRIPTION:**  
 THE S 1/2 OF THE SW 1/4, SEC. 13, TWP. 28S, R. 1E, W. OF THE 6TH P.M., EXCEPT THE SOUTH 618.00 FEET OF THE WEST 600.00' AND EXCEPT THE WEST 168.71 OF THE FEET NORTH 135.00 FEET OF THE SOUTH 754.00 FEET THERE OF.

**BENCHMARK:**  
 "1" CUT 56.7' SE OF THE SE COR OF THE SW 1/4, TO THE NE CORNER CONCRETE LIFT STATION PAD. ELEV.=91.85 CITY DATUM

RESERVES "A", "B", AND "C" ARE RESERVED FOR OPEN SPACE, LANDSCAPING, BERMS, SIDEWALKS, DRAINAGE PURPOSES, AND UTILITIES AS CONFIRMED TO EASEMENTS.

RESERVES "D", "E" AND "F" ARE RESERVED FOR ENTRY MONUMENTS, STREETS, OPEN SPACE, LANDSCAPING, AND BERMS.

- = #4 Baughman Rebar Set
- = #4 Rebar in Thimble Found
- = 3/4" Iron Pipe in Thimble Found
- △ = #4 Mid Kansas Rebar Found
- ◇ = Mid Kansas 3/4" Iron Pipe Found
- (with dot) = Cable TV Pedestal
- (with dot) = Electric Box
- (with cross) = Guy Anchor
- (with triangle) = Light Pole
- (with cross) = Power Pole
- (with square) = Satellite Dish
- (with circle) = Sign
- SSMH = Sanitary Sewer Manhole
- T = Tree
- TRM = Transformer
- SW Ped = Southwestern Bell Pedestal

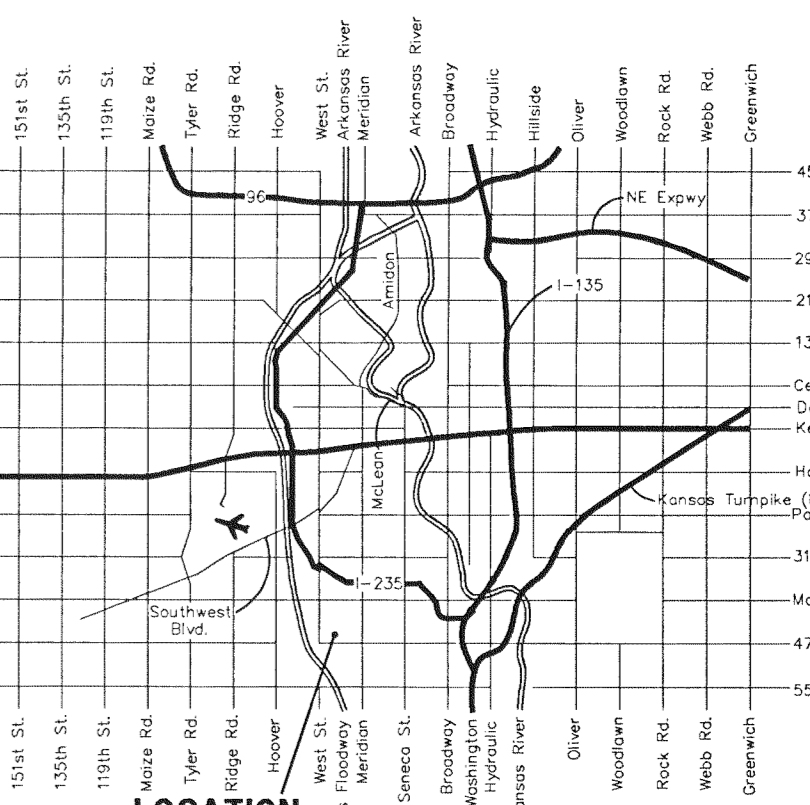
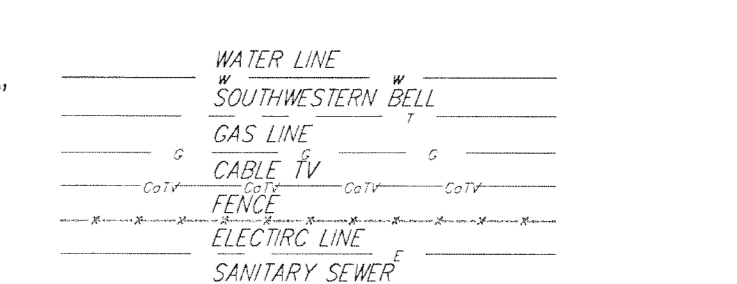

NW Cor., SW 1/4, Sec. 13, Twp. 28S, Range 1 West

LES, VICTOR & ANTHONY  
 2229 S HOOPER  
 WICHITA, KS 67209  
 ZONED "LI"

ZONED "LI"  
 DLS LAND PARTNERSHIP  
 PO BOX 770081  
 WICHITA, KS 67277

WEST YARD ADDITION  
 ZONED "LI"

ZONED "LI"  
 DLS LAND PARTNERSHIP  
 384 LYMOND E DILLING  
 WICHITA, KS 67277

SW Cor., SW 1/4, Sec. 13, Twp. 28S, Range 1 West

Offsite Drainage  
 D.A. = 400 ac.  
 Q<sub>s</sub> = 474 cfs  
 Q<sub>w</sub> = 87 cfs

Offsite Drainage  
 D.A. = 145 ac.  
 Q<sub>s</sub> = 45 cfs  
 Q<sub>w</sub> = 95 cfs  
 Q<sub>100</sub> = 244 cfs

Proposed Pond  
 W.S. = 187.00

Proposed Pond  
 W.S. = 186.53

Offsite Drainage  
 D.A. = 9.2 ac.  
 Q<sub>s</sub> = 6.9 cfs  
 Q<sub>w</sub> = 1.3 cfs  
 Q<sub>100</sub> = 39 cfs

RENOUET, SHIRLEY D.  
 3245 W. 47TH ST. S.  
 WICHITA, KS 67217  
 ZONED "LC"

RENOUET, SHIRLEY D.  
 3245 W. 47TH ST. S.  
 WICHITA, KS 67217  
 3RD ADDITION TO CHITWOOD ESTATES

2ND ADDITION TO CHITWOOD ESTATES  
 ZONED "SF-20"  
 CHITWOOD ZONED "SF-20"

ZONED "SF-20"  
 ESTATES

ZONED "SF-20"  
 SPRINGS, FRED J. ETUX  
 3/8 MARK W. & KELLY J. SPRINGS  
 6601 W. 35TH ST. S.  
 WICHITA, KS 67215

VERSAR ADDITION  
 ZONED "SF-20"

ARCHER, JOHN CALVIN  
 3515 W. 47TH S.  
 WICHITA, KS 67217  
 ZONED "SF-20"

RENOUET, CLINTON A.  
 3245 W. 47TH ST. S.  
 WICHITA, KS 67217  
 ZONED "SF-20"  
 WAHL, GLADYS  
 3201 W. 47TH S.  
 WICHITA, KS 67217

22 MAY 2000