

STAFF REPORT
(One-Step Final Plat)

CASE NUMBER: SUB 2006-42 -- ANGELL ESTATES ADDITION

OWNER/APPLICANT: Larry D. Angell Revocable Trust, Larry D. and Susan J. Angell, 7633 N. Oliver, Valley Center, KS 67147

SURVEYOR/ENGINEER: Ruggles & Bohm, P.A., 924 N. Main, Wichita, KS 67203

LOCATION: South side of 77th St. North, West of Oliver

SITE SIZE: 10.24 acres

NUMBER OF LOTS

Residential:	3
Office:	
Commercial:	
Industrial:	
Total:	<u>3</u>

MINIMUM LOT AREA: 2.31 acres

CURRENT ZONING: RR, Rural Residential

PROPOSED ZONING: Same

VICINITY MAP

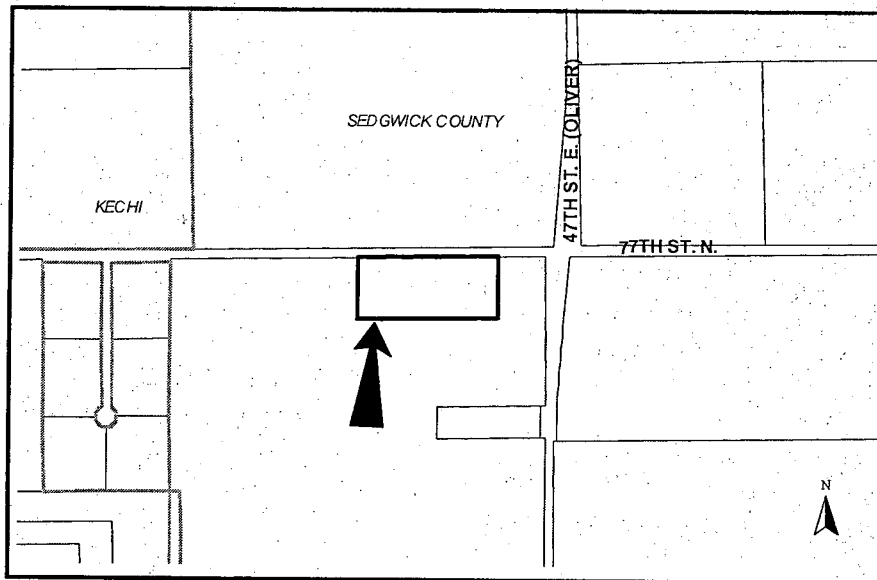

NOTE: This site is located in the County within three miles of Wichita's boundary. It is located in an area designated as " Small City 2030 Urban Growth Area" by the Wichita-Sedgwick County Comprehensive Plan. It is located in the Kechi Area of Influence.

STAFF COMMENTS:

- A. Since sanitary sewer is unavailable to serve this property, the applicant shall contact **County Code Enforcement** to find out what tests may be necessary and what standards are to be met for approval of on-site sewerage facilities. A memorandum shall be obtained specifying approval.
- B. The site is currently located within the Sedgwick County Rural Water District No. 2. If service is available, feasible and the property is eligible for service, **County Code Enforcement** recommends connection.
- C. In accordance with the Urban Fringe Development policy, since this plat is located within the Kechi 2030 Urban Growth Area, the subdivider shall contact the City of Kechi, to determine the financial feasibility of connecting the proposed subdivision to the city water system. If financially feasible, then the subdivision shall be connected to the city's water system in accordance with that city's standards.
- D. If improvements are guaranteed by petition, a notarized certificate listing the petitions shall be submitted to the Planning Department for recording.
- E. **County Engineering** needs to comment on the status of the applicant's drainage plan. *A drainage plan is needed and should calculate high water elevations on lots for purposes of setting minimum pad elevations. Location of emergency spillways of offsite pond need to be located and applicant needs to determine if additional easements on Lot 2 are needed to carry overflow. Drainage easements should be shown as floodway reserves.*
- F. An onsite benchmark is needed.
- G. **County Engineering** has requested the dedication of access controls along 77th St. North. Lots 1 & 2 should share an entrance. Lot 3 should have a joint entrance on the west.
- H. **Sedgwick County Fire Department** advises that all access drives shall be in accordance with Sedgwick County Service Drive Code.
- I. In accordance with the KS Wetland Mapping Conventions under the Memorandum of Understanding between the USDA-NRCS; USEPA; USACE; and USF&WS, this site has been identified as one with potential wetland hydrology. The US Army Corps of Engineers (USACE) should be contacted (316-322-8247) to have a wetland determination completed.
- J. The Applicant is reminded that a platting binder is required with the final plat. Approval of this plat will be subject to submittal of this binder and any relevant conditions found by such a review.
- K. The plat's text shall include language that a drainage plan has been developed for the plat and that all drainage easements, rights-of-way, or reserves shall remain at established grades or as modified with the approval of the applicable City or County Engineer, and unobstructed to allow for the conveyance of stormwater.

SUB 2006-42 -- One-Step Final Plat of ANGELL ESTATES ADDITION
May 11, 2006 - Page 3

- L. The applicant shall install or guarantee the installation of all utilities and facilities that are applicable and described in Article 8 of the MAPC Subdivision Regulations. (Water service and fire hydrants required by Article 8 for fire protection shall be as per the direction and approval of the Chief of the Fire Department.)
- M. The applicant's engineer is advised that the Register of Deeds is requiring the name(s) of the notary public, who acknowledges the signatures on this plat, to be printed beneath the notary's signature.
- N. To receive mail delivery without delay, and to avoid unnecessary expense, the applicant is advised of the necessity to meet with the U.S. Postal Service Growth Management Coordinator (Phone: 316-946-4556) prior to development of the plat so that the type of delivery, and the tentative mailbox locations can be determined.
- O. The applicant is advised that various State and Federal requirements (specifically but not limited to the Army Corps of Engineers, Kanopolis Project Office, Rt. 1, Box 317, Valley Center, KS 67147) for the control of soil and wind erosion and the protection of wetlands may impact how this site can be developed. It is the applicant's responsibility to contact all appropriate agencies to determine any such requirements.
- P. The owner of the subdivision should note that any construction that results in earthwork activities that will disturb one (1) acre or more of ground cover requires a Federal/State NPDES Storm Water Discharge Permit from the Kansas Department of Health and Environment in Topeka. Also, for projects located within the City of Wichita, erosion and sediment control devices must be used on ALL projects. For projects outside of the City of Wichita, but within the Wichita Metropolitan area, the owner should contact the appropriate governmental jurisdiction concerning erosion and sediment control device requirements.
- Q. Perimeter closure computations shall be submitted with the final plat tracing.
- R. Recording of the plat within 30 days after approval by the City Council and/or County Commission.
- S. The representatives from the utility companies should be prepared to comment on the need for any additional utility easements to be platted on this property.
- T. A compact disc (CD), which will be used by the City and County GIS Departments, detailing the final plat in digital format in AutoCAD. If a disc is not provided, please send via e-mail to Cheryl Holloway (E-Mail address: cholloway@wichita.gov). Please include the name of the plat on the disc.