

PRELIMINARY PLAT FOR
MULBERRY EAST THIRD
 AN ADDITION TO WICHITA, SEDGWICK COUNTY, KANSAS

BENCH MARKS

- B.M. #1: CITY STD. 30' N & 8' W
 COR. @ 37TH & 3RD
 ELEV. = 184.54
- B.M. #2: RR SPKLE IN N FACE
 OF N. LEG. OF "N" OF
 37TH & GOVERNOR
 ELEV. = 179.24
- B.M. #3: TBM RR SPKLE IN S.
 FACE OF CENTER "N"
 E OF N QUARTER COR.
 SEC. 29-28-2E.
 ELEV. = 187.79
- B.M. #4: CITY STD. 44' S & 8' W
 COR. @ 37TH & CENTERLINE
 OF 3RD
 ELEV. = 204.11



LOCATION MAP

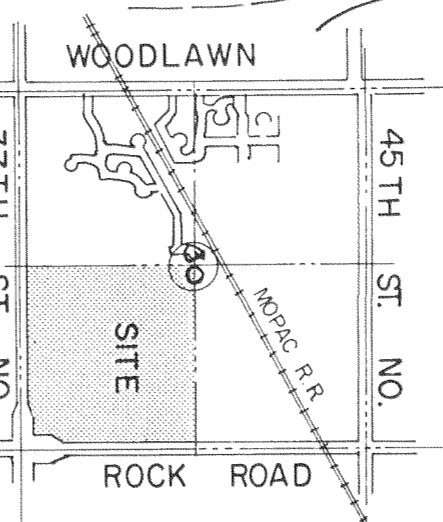

R-5628.00'
 $\Delta = 107^{\circ}28'36''$
 L = 169.69
 S-2047.10' W
 CH = 169.45

R-3723.00'
 $\Delta = 66^{\circ}30'54''$
 L = 561.71
 Bsp. S5660'E
 CH = 547.69

B.M. 1515.00'
 $\Delta = 171^{\circ}45'11''$
 L = 570.41
 S-33442.3' W
 CH = 438.55

SCALE 1" = 100'

	PRELIMINARY PLAT
	MULBERRY EAST THIRD
MID-KANSAS ENGINEERING CONSULTANTS PA 3500 NORTH ROCK ROAD BUILDING #800 WICHITA, KANSAS 67226	682-6551

(Willow Bend 3rd)