

SUBDIVISION COMMITTEE  
METROPOLITAN AREA PLANNING COMMISSION

AGENDA ITEM NO: 10  
MARCH 23, 2006

STAFF REPORT:  
(One-Step Final Plat)

CASE NUMBER: SUB 2006-15 -- DATER ADDITION

OWNER/APPLICANT: Rose M. Dater Living Trust, Attn: Duane Dater, 4020 N. 167th St.  
West, Colwich, KS 67030

SURVEYOR/ENGINEER: Terra Tech Land-Surveying, Inc., 22200 W. 63rd St. South, Viola, KS  
67149

LOCATION: North of 37th St. North, East side of 167th St. West

SITE SIZE: 5 acres

NUMBER OF LOTS

Residential: 1  
Office: \_\_\_\_\_  
Commercial: \_\_\_\_\_  
Industrial: \_\_\_\_\_  
Total: 1

MINIMUM LOT AREA: 4.7 acres

CURRENT ZONING: RR, Rural Residential

PROPOSED ZONING: Same

VICINITY MAP

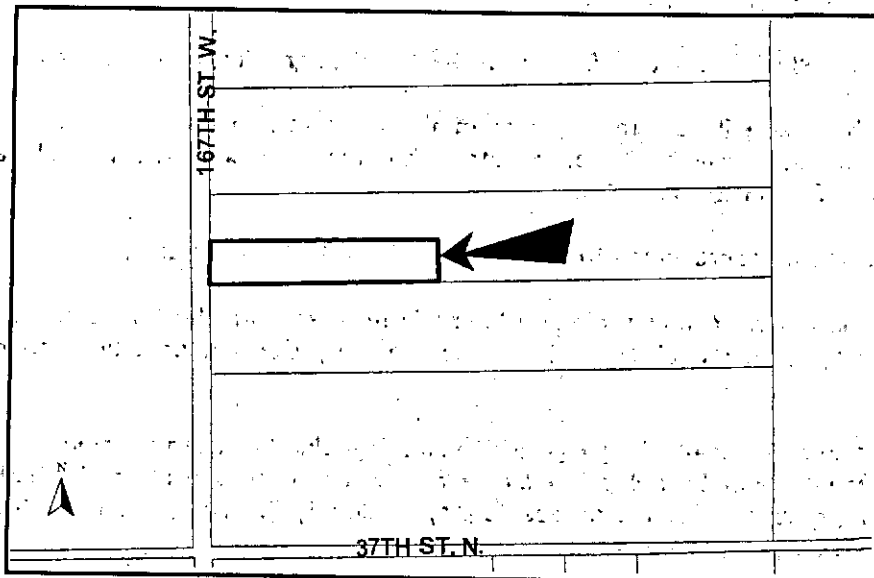

**NOTE:** This is unplatted property located in the County within three miles of the City of Wichita. It is in an area designated as "2030 Urban growth area" by the Wichita-Sedgwick County Comprehensive Plan. It is located in the Colwich Area of Influence.

**STAFF COMMENTS:**

- A. Since neither sanitary sewer nor municipal water is available to serve this property, the applicant shall contact County Code Enforcement to find out what tests may be necessary and what standards are to be met for approval of on-site sewerage and water wells. A memorandum shall be obtained specifying approval. The applicant need to either move the property line 100 feet north or contact Sedgwick County Code Enforcement for a waiver for the lagoon.
- B. In accordance with the Urban Fringe Development Standards, the subdivider shall contact the City of Wichita to determine the financial feasibility of connecting the proposed subdivision to the city water system. If financially feasible, the subdivision shall be connected to Wichita's water system in accordance with City of Wichita standards.
- C. City of Wichita Water and Sewer Department requests a petition for future extension of sanitary sewer and City water services.
- D. If improvements are guaranteed by petition, a notarized certificate listing the petitions shall be submitted to the Planning Department for recording.
- E. County Engineering needs to comment on the status of the applicant's drainage plan.
- F. County Engineering needs to comment on the access controls. The plat denotes one opening along 167th St. West. The access controls are approved.
- G. Sedgwick County Fire Department advises that all access drives shall be in accordance with Sedgwick County Service Drive Code.
- H. The plat's text shall note the dedication of the street to and for the use of the public.
- I. Approval of this plat will require a waiver of the lot depth to width ratio of the Subdivision Regulations. The Subdivision Regulations state that the maximum depth of all residential lots shall not exceed 2.5 times the width.
- J. GIS has requested an abbreviation for the labeling of "167<sup>th</sup> Street West".
- K. The Applicant is reminded that a platting binder is required with the final plat. Approval of this plat will be subject to submittal of this binder and any relevant conditions found by such a review.
- L. The plat's text shall include language that a drainage plan has been developed for the plat and that all drainage easements, rights-of-way, or reserves shall remain at established grades or as modified with the approval of the applicable City or County Engineer, and unobstructed to allow for the conveyance of stormwater.

**SUB 2006-15 -- One-Step Final Plat of DATER ADDITION**  
**March 23, 2006 - Page 2**

- M. The applicant shall install or guarantee the installation of all utilities and facilities that are applicable and described in Article 8 of the MAPC Subdivision Regulations. (Water service and fire hydrants required by Article 8 for fire protection shall be as per the direction and approval of the Chief of the Fire Department.)
- N. The applicant's engineer is advised that the Register of Deeds is requiring the name(s) of the notary public, who acknowledges the signatures on this plat, to be printed beneath the notary's signature.
- O. To receive mail delivery without delay, and to avoid unnecessary expense, the applicant is advised of the necessity to meet with the U.S. Postal Service Growth Management Coordinator (Phone: 316-946-4556) prior to development of the plat so that the type of delivery, and the tentative mailbox locations can be determined.
- P. The applicant is advised that various State and Federal requirements (specifically but not limited to the Army Corps of Engineers, Kanopolis Project Office, Rt. 1, Box 317, Valley Center, KS 67147) for the control of soil and wind erosion and the protection of wetlands may impact how this site can be developed. It is the applicant's responsibility to contact all appropriate agencies to determine any such requirements.
- Q. The owner of the subdivision should note that any construction that results in earthwork activities that will disturb one (1) acre or more of ground cover requires a Federal/State NPDES Storm Water Discharge Permit from the Kansas Department of Health and Environment in Topeka. Also, for projects located within the City of Wichita, erosion and sediment control devices must be used on ALL projects. For projects outside of the City of Wichita, but within the Wichita Metropolitan area, the owner should contact the appropriate governmental jurisdiction concerning erosion and sediment control device requirements.
- R. Perimeter closure computations shall be submitted with the final plat tracing.
- S. Recording of the plat within 30 days after approval by the City Council and/or County Commission.
- T. The representatives from the utility companies should be prepared to comment on the need for any additional utility easements to be platted on this property.
- U. A compact disc (CD), which will be used by the City and County GIS Departments, detailing the final plat in digital format in AutoCAD. If a disc is not provided, please send via e-mail to Cheryl Holloway (E-Mail address: [cholloway@wichita.gov](mailto:cholloway@wichita.gov)). Please include the name of the plat on the disc.