

STAFF REPORT
(One-Step Final Plat)

CASE NUMBER: SUB 2007-47 – EASY CREDIT AUTO SALES ADDITION

OWNER/APPLICANT: Easy Credit Auto Sales, Inc., 333 S. Emporia, Wichita, KS 67207

SURVEYOR/AGENT: Baughman Company, P.A., Attn: Kris Rose, 315 Ellis, Wichita, KS 67211

LOCATION: North of 47th St. South, East side of Broadway

SITE SIZE: 1.83 acres

NUMBER OF LOTS

Residential:	-
Office:	-
Commercial:	1
Industrial:	-
Total:	1

MINIMUM LOT AREA: 1.83 acres

CURRENT ZONING: GC, General Commercial

PROPOSED ZONING: Same

VICINITY MAP

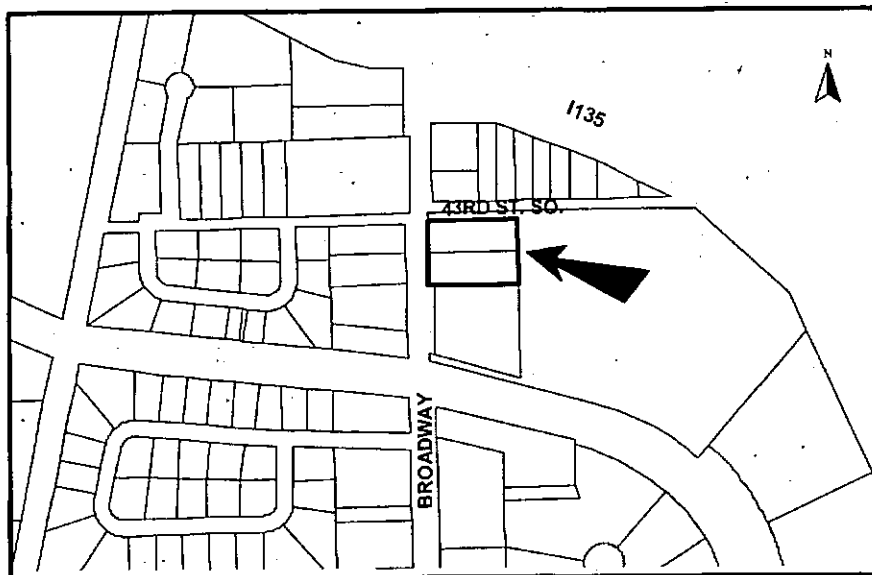

NOTE: This is an unplatted site located within the City.

STAFF COMMENTS:

- A. The applicant shall guarantee the extension of sanitary sewer. An off-site easement may also be needed.
- B. If improvements are guaranteed by petition, a notarized certificate listing the petitions shall be submitted to the Planning Department for recording.
- C. **City Engineering** needs to comment on the status of the applicant's drainage plan.
- D. The plat proposes one access opening along Broadway. **Traffic Engineering** has approved the access controls.
- E. The proposed right-of-way along Broadway has been approved by **Traffic Engineering**.
- F. This property is within a zone identified by the City Engineers' office as likely to have groundwater at some or all times within 10 feet of the ground surface elevation. Building with specially engineered foundations or with the lowest floor opening above groundwater is recommended, and owners seeking building permits on this property will be similarly advised. More detailed information on recorded groundwater elevations in the vicinity of this property is available in the City Engineers' office.
- G. The plat's text shall include language that a drainage plan has been developed for the plat and that all drainage easements, rights-of-way, or reserves shall remain at established grades or as modified with the approval of the applicable City or County Engineer, and unobstructed to allow for the conveyance of stormwater.
- H. The applicant shall install or guarantee the installation of all utilities and facilities that are applicable and described in Article 8 of the MAPC Subdivision Regulations. (Water service and fire hydrants required by Article 8 for fire protection shall be as per the direction and approval of the Chief of the Fire Department.)
- I. The applicant's engineer is advised that the Register of Deeds is requiring the name(s) of the notary public, who acknowledges the signatures on this plat, to be printed beneath the notary's signature.
- J. To receive mail delivery without delay, and to avoid unnecessary expense, the applicant is advised of the necessity to meet with the U.S. Postal Service Growth Management Coordinator (Phone: 316-946-4556) prior to development of the plat so that the type of delivery, and the tentative mailbox locations can be determined.
- K. The applicant is advised that various State and Federal requirements (specifically but not limited to the Army Corps of Engineers, Kanopolis Project Office, Rt. 1, Box 317, Valley Center, KS 67147) for the control of soil and wind erosion and the protection of wetlands may impact how this site can be developed. It is the applicant's responsibility to contact all appropriate agencies to determine any such requirements.
- L. The owner of the subdivision should note that any construction that results in earthwork activities that will disturb one (1) acre or more of ground cover requires a Federal/State NPDES Storm Water Discharge Permit from the Kansas Department of Health and Environment in Topeka. Also, for projects located within the City of Wichita, erosion and sediment control devices must be used on ALL projects. For projects outside of the City of Wichita, but within the Wichita Metropolitan area, the owner should contact the appropriate governmental jurisdiction concerning erosion and sediment control device requirements.
- M. Perimeter closure computations shall be submitted with the final plat tracing.
- N. The representatives from the **utility companies** should be prepared to comment on the need for any additional utility easements to be platted on this property.
- O. A compact disc (CD), which will be used by the City and County GIS Departments, detailing the final plat in digital format in AutoCAD. If a disc is not provided, please send via e-mail to Cheryl Holloway (E-Mail address: cholloway@wichita.gov). Please include the name of the plat on the disc.

CLOSURE

CLOSURE - EASY CREDIT AUTO SALES ADDITION

PT 01 North: 7900.8707 East : 11831.1054
Line Course: N 00-02-11 E Length: 239.9700
PT 02 North: 8140.8407 East : 11831.2578
Line Course: S 89-31-50 E Length: 362.8700
PT 03 North: 8137.8676 East : 12194.1156
Line Course: S 00-00-09 W Length: 239.8200
PT 04 North: 7898.0476 East : 12194.1051
Line Course: N 89-33-19 W Length: 363.0100
PT 01 North: 7900.8652 East : 11831.1061

MISCLOSURE:

Line Course: N 07-11-19 W Length: 0.0056
North: 7900.8708 East : 11831.1054