

DRAINAGE PLAN

AUTOCRAFT ADDITION

WICHITA, SEDGWICK COUNTY, KANSAS

Existing
 Area = 2.0 acres
 Soil Type B
 $T_c = 15 \text{ min}$
 $CN = 69$
 $Q_2 = 2.2 \text{ cfs}$
 $Q_5 = 3.8 \text{ cfs}$
 $Q_{100} = 10.4 \text{ cfs}$

Developed
 Area = 2.0 acres
 Soil Type B
 $T_c = 15 \text{ min}$
 $CN = 88$
 $Q_2 = 6.2 \text{ cfs}$
 $Q_5 = 8.4 \text{ cfs}$
 $Q_{100} = 15.6 \text{ cfs}$

WEST OFFSITE
 D.A. = .70 acres
 $CN = 88$
 $T_c = 0.25 \text{ hrs}$
 $Q_2 = 1.9 \text{ cfs}$
 $Q_5 = 2.7 \text{ cfs}$
 $Q_{100} = 5.2 \text{ cfs}$

EXISTING 3x6 RCBC
 Capacity
 @ 5 ft/s = 90 cfs
 @ 6 ft/s = 108 cfs
 @ 7 ft/s = 126 cfs
 @ 8 ft/s = 144 cfs

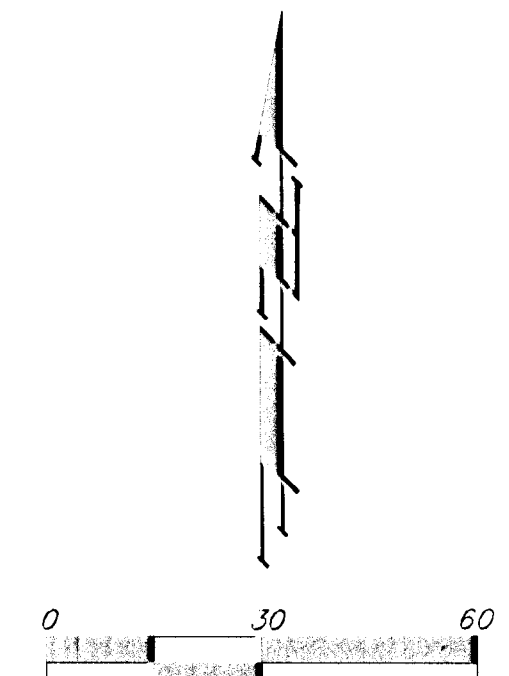

DATE OF TOPOGRAPHY: 7 APRIL 2006
 DATE OF PREPARATION: 25 SEPTEMBER 2006
 CONTOUR INTERVALS = 1 FOOT

BENCHMARK:
 Maize Rd. & Kellogg - NE. cor. of intersection, City of Wichita
 disc. SW cor. of disc. base for traffic signal light pole
 Elevation = 1323.97 (N.G.V.D. 29)

NOTE: Site not located in designated FEMA
 Floodplain or floodway as of September 26, 2006.

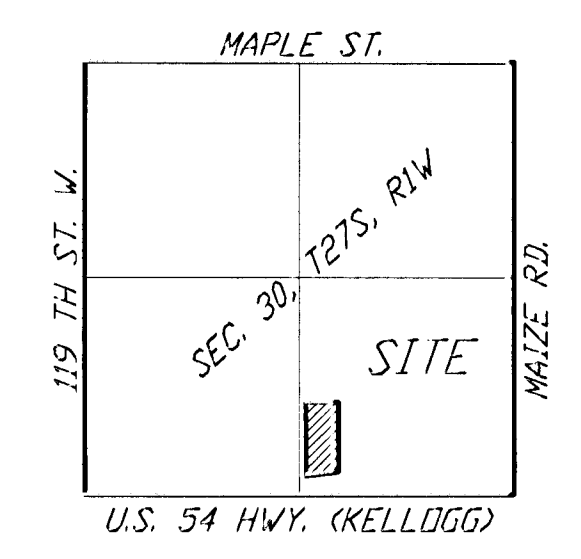

VICINITY MAP

