

# DRAINAGE PLAN AVALON PARK 2ND

AN ADDITION TO WICHITA  
SEDGWICK COUNTY, KANSAS

SCALE: 1" = 100'

### LEGEND

- 5A BASIN IDENTIFIER
- MINOR BASIN BOUNDARY
- STORM WATER FLOW
- 300 NODE IDENTIFIER
- +— STORM SEWER AND INLET
- +— STORM SEWER AND MANHOLE

SEE SUPPORTING CALCULATIONS FOR HYDROLOGY

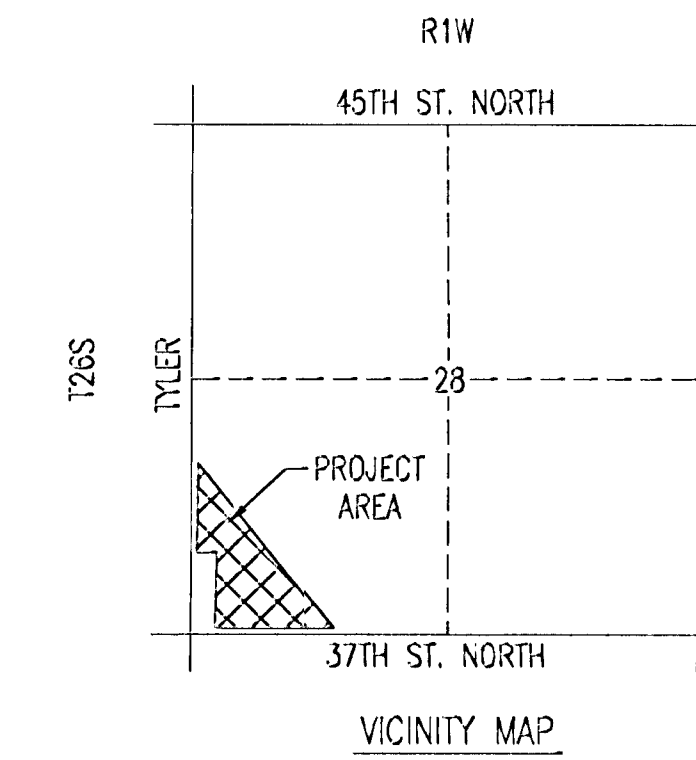

MINIMUM OPENINGS	ELEVATION (N.G.V.D.)	CITY DATUM
BLOCK 1		
LOTS 1-6	1339.0	151.6
LOTS 7-24	1337.9	150.5
BLOCK 2		
LOTS 1-16	1338.5	151.1

OWNER: PAISY S.  
SCOTT REY RUST  
UNPLATTED  
ZONED: "SF-20"

DONALD E. LAMBDA  
UNPLATTED  
ZONED: "SF-20"

TERRY D. & FRANCES G. BOSCH  
UNPLATTED  
ZONED: "SF-20"

THE JAMES F. & GERALDINE L. LOEHR  
UNPLATTED  
ZONED: "SF-20"

JUSTIN & KRISTI GLOVER  
UNPLATTED  
ZONED: "SF-20"

N.W. Corner SW 1/4, Sec. 28  
Twp. 26S, R-1-W  
Found 3/4" Iron Pipe  
w/ 1.5875 Cop-Moehring

S.W. Cor. SW 1/4,  
Sec. 28, Twp. 26S, R-1-W  
Found 3/4" Pipe

ALAN IL. & GEORGE R. RENNICK  
UNPLATTED  
ZONED: "SF-5"

AVALON PARK LLC  
UNPLATTED  
ZONED: "SF-5"  
TO BE PLATTED AS  
AVALON PARK ADDITION

REVISED 7/12/04



**Professional Engineering Consultants, P.A.**  
303 S. TOPEKA • WICHITA, KANSAS 67202  
316-262-2691 • FAX 316-262-3003

S.E. Corner SW 1/4,  
Sec. 28, Twp. 26S, R-1-W  
Found 5/8" Rebar