

TO 1-71 SCOTT LINDEBAK FROM 1-101
TRAFFIC ENGINEERING
(12/9/05)

DEC 1 2005
CITY - ENGINEERING

Preliminary Plat BELLECHASE Wichita, Sedgwick County, Kansas

ENLARGEMENT
1"=30'

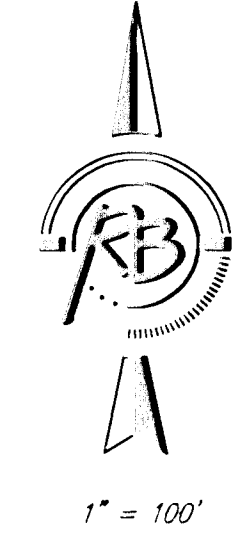
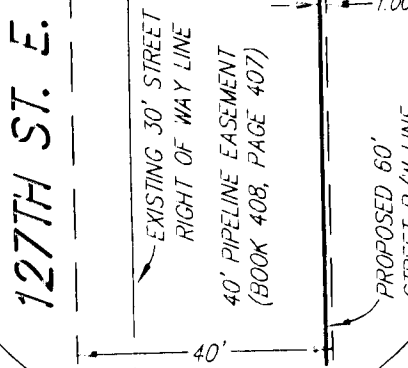

BENCH MARK: RAILROAD SPIKE IN SOUTH
FACE OF POWER POLE '79' SOUTH SOUTHEAST
CORNER OF THE WEST QUARTER CORNER OF SEC. 26,
127S, R2E
ELEV.=1337.46 (NGVD)

LEGEND

- SS SANITARY SEWER (CITY OF WICHITA)
- ONE OVERHEAD ELECTRIC (WESTAR)
- G GAS LINE (KANSAS GAS SERVICE)
- W WATER MAIN (CITY OF WICHITA)
- FH FIRE HYDRANT
- WV WATER VALVE BOX
- WM WATER METER
- JPED TELEPHONE PEDESTAL
- PP POWER POLE (WESTAR)
- DA DUY ANCHOR
- SS M.H. SANITARY SEWER MANHOLE (CITY OF WICHITA)
- CONOCO P.L.M. CONOCO PIPELINE - PIPELINE MARKER
- DT DECIDUOUS TREE (CALIPER INDICATED)
- CT CONIFER TREE (CALIPER INDICATED)

SS M.H.
TOP: 1300.4
12' X 1220.40
72' OUT: 1230.32

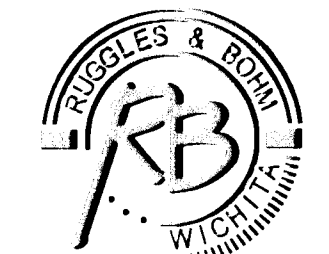

Ruggles & Bohm, P.A.
Engineering, Surveying, Land Planning
924 North Main (316) 264-8008
Wichita, Kansas 67203 (316) 264-4621 fax
www.rbkansas.com E-mail: info@rbkansas.com

DWG FILE: SURVEY BASE
PROJECT NO. 2658P
DECEMBER 7, 2005

ENLARGEMENT
1"=30'

