

DRAINAGE PLAN FOR BLANCHAT MACHINE COMPANY ADDITION

N.W. 1/4, S. 25, T.27S., R.1W. OF THE 6TH P.M., WICHITA, SEDGWICK COUNTY, KS

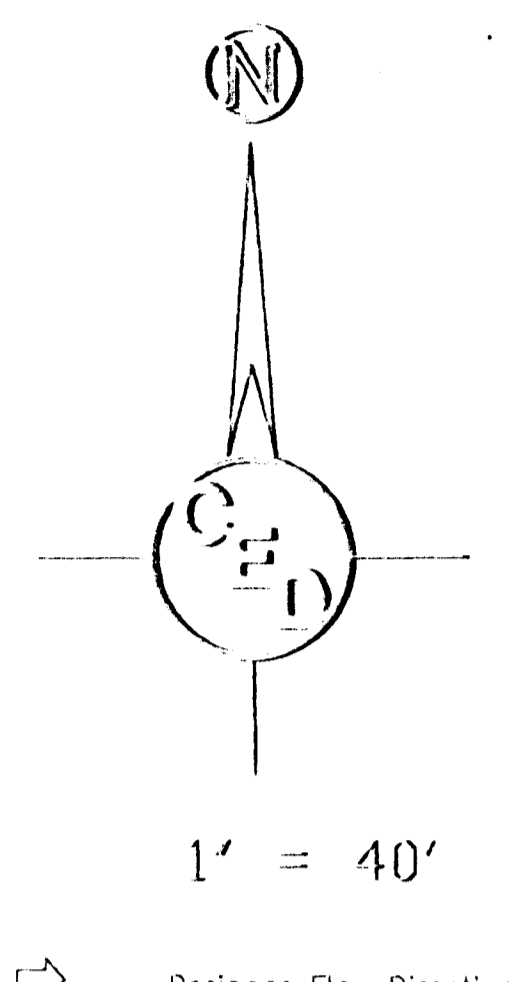

Benchmark: City Standard Disc. 41' North of the centerline of Maple Street and 26' West of the Centerline of Sheridan.
Elevation: 114.04 MSL

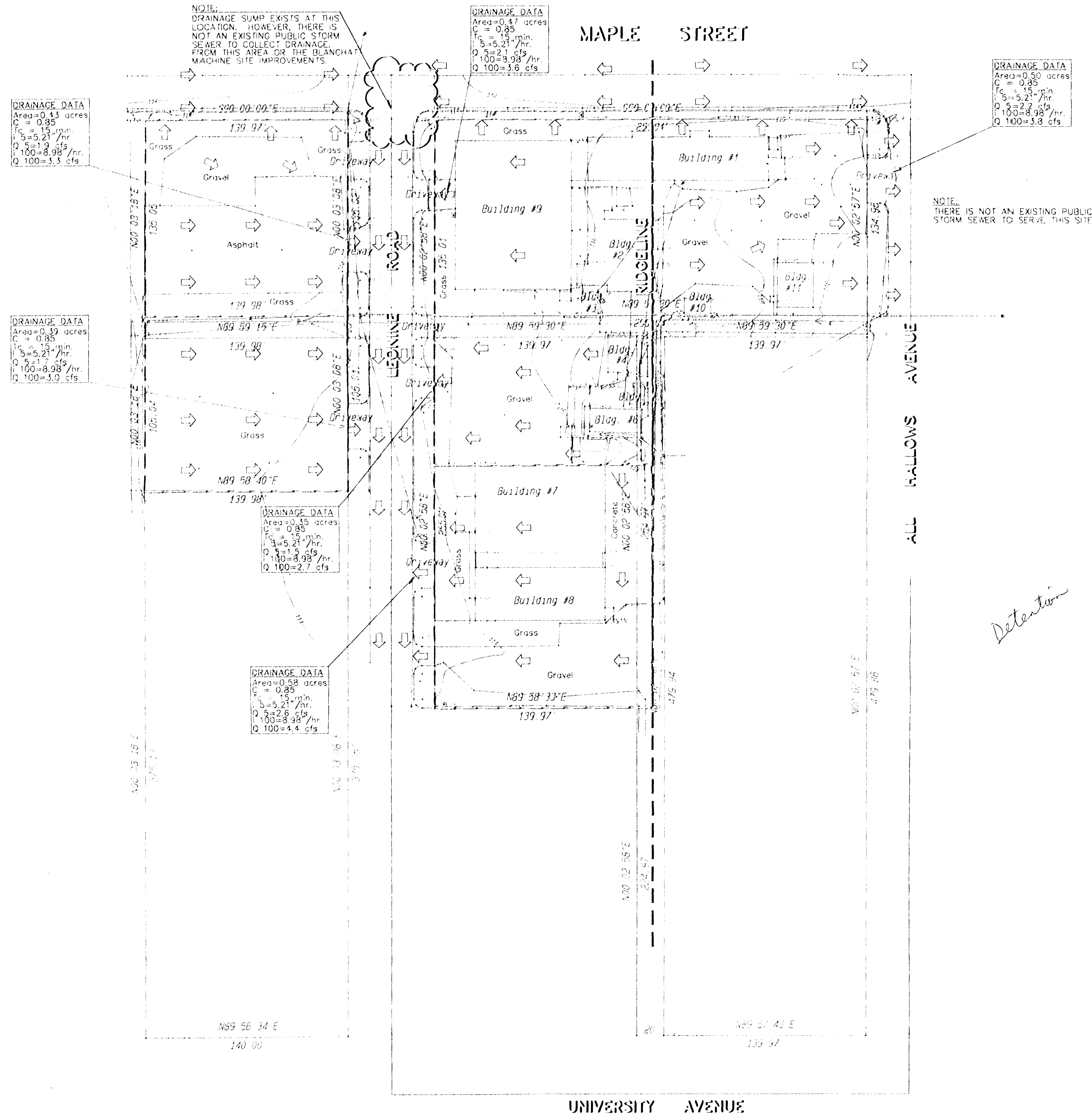
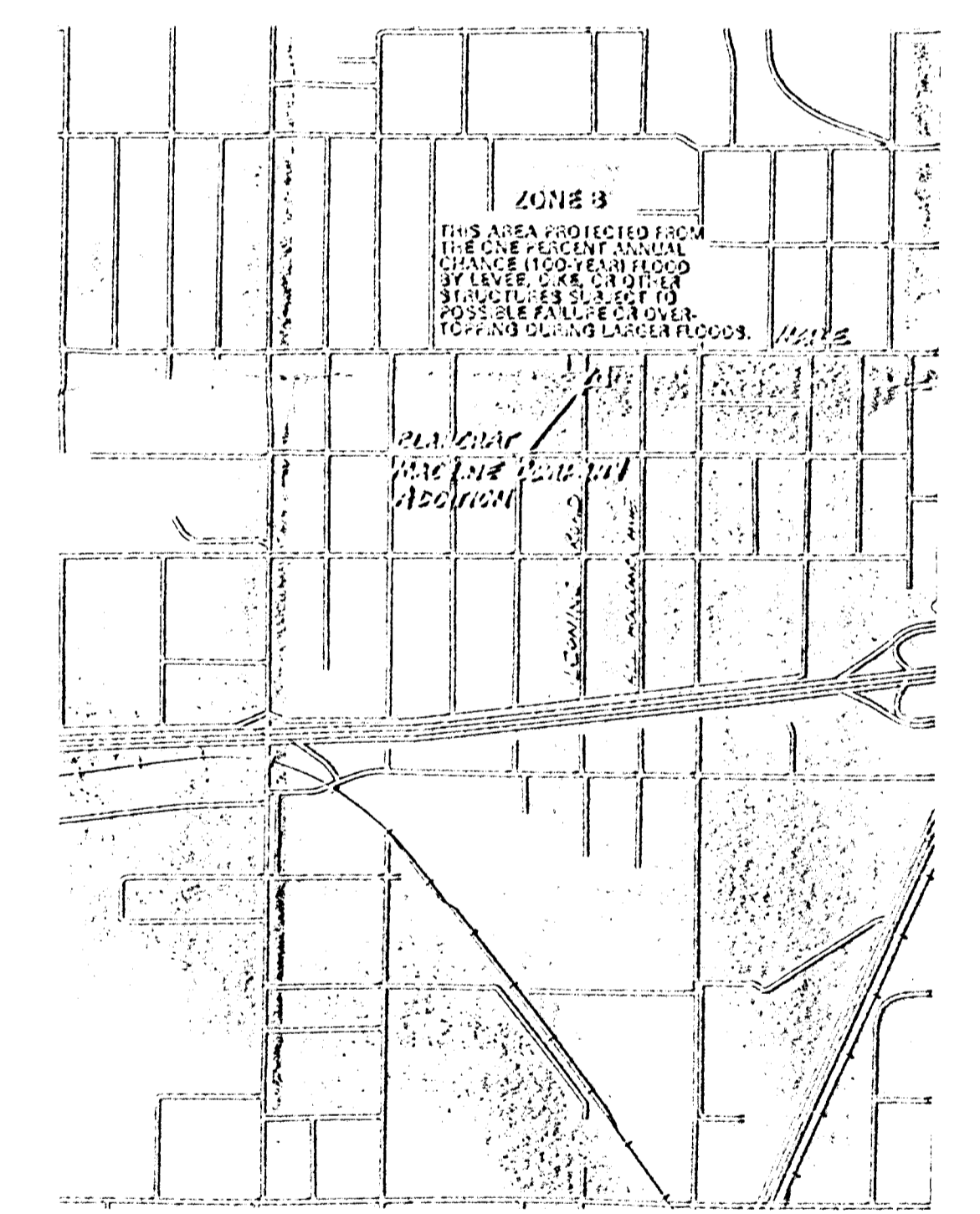

FEMA FIRM PANEL NO. 200328 0025B

Detention

Topographic Survey provided by Terra Tech Land Surveying, Inc.
Date of Survey: May 7, 1998

DRAINAGE PLAN FOR BLANCHAT MACHINE COMPANY ADDITION 3525 MAPLE, WICHITA, KS		
PROJ. NO.:		
CERTIFIED ENGINEERING DESIGN		
400 NORTH OHIO WICHITA, KANSAS 67214 (316) 262-8803		
DESIGNED: HOF	SCALE: 1" = 40'	SHEET 1
DRAWN: TRLS, HOF	DATE: 6-1-98	TOTAL 1
CHECKED: HOF	DED FILE: BLANCHAT.DWG	

