

STAFF REPORT
(One-Step Final Plat)

CASE NUMBER: SUB 2001-104 -- HAN DIEC ADDITION

OWNER/APPLICANT: Cinemas Associates; Attn: Bill Warren, P.O. Box 782560, Wichita, KS 67278-2560; (contract purchaser) Han Diec, c/o John T. Arnold & Associates, 101 S. Market, Wichita, KS 67202

SURVEYOR/ENGINEER: Baughman Company, P.A., 315 Ellis, Wichita, KS 67211

LOCATION: North of Kellogg, West side of Greenwich Road

SITE SIZE: 1.85 Acres

NUMBER OF LOTS

Residential:	
Office:	
Commercial:	1
Industrial:	
Total:	1

MINIMUM LOT AREA: 1.85 Acres

CURRENT ZONING: LC, Limited Commercial

PROPOSED ZONING: Same

*Easement for SS
to plat to the south?*

VICINITY MAP

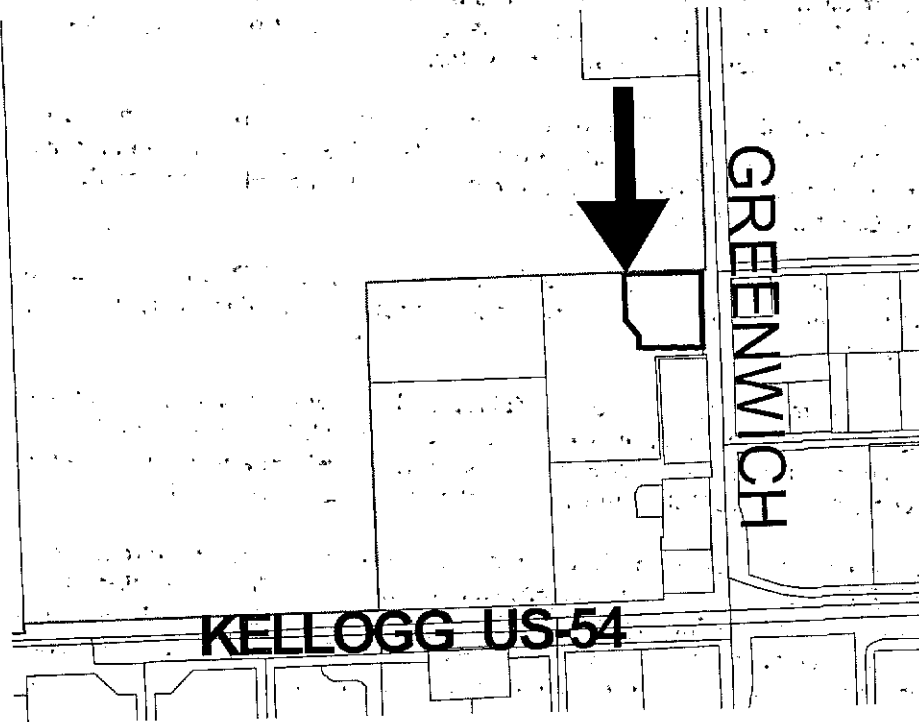

NOTE: This is a replat of a portion of David's East Addition.

STAFF COMMENTS:

- A. Municipal services are available to serve the site. City Engineering needs to comment on the need for guarantees or easements.
- B. If improvements are guaranteed by petition, a notarized certificate listing the petitions shall be submitted to the Planning Department for recording.
- C. City Engineering needs to comment on the status of the applicant's drainage plan.
- D. The plat proposes one access opening along Greenwich. Traffic Engineering needs to comment on the access controls. Traffic Engineering and MAPD have recommended access control except for one joint opening with the abutting lot to the south.
- E. The applicant shall guarantee the closure of any driveway openings located in areas of complete access control or that exceed the number of allowed openings.
- F. On the final plat, the MAPC signature block needs to reference "J.D. Michaélis, Chair".
- G. The Applicant is advised that if platted, the building setback may be reduced to 20 feet.
- H. The Applicant is reminded that a platting binder is required with the final plat. Approval of this plat will be subject to submittal of this binder and any relevant conditions found by such a review.
- I. The platting text shall include language that a drainage plan has been developed for the plat and that all drainage easements, rights-of-way, or reserves shall remain at established grades or as modified with the approval of the applicable City or County Engineer, and unobstructed to allow for the conveyance of stormwater.
- J. The applicant shall install or guarantee the installation of all utilities and facilities which are applicable and described in Article 8 of the MAPC Subdivision Regulations. (Water service and fire hydrants required by Article 8 for fire protection shall be as per the direction and approval of the Chief of the Fire Department.)
- K. The applicant's engineer is advised that the Register of Deeds is requiring the name(s) of the notary public, who acknowledges the signatures on this plat, to be printed beneath the notary's signature.
- L. To receive mail delivery without delay, and to avoid unnecessary expense, the applicant is advised of the necessity to meet with the U.S. Postal Service Growth Management Coordinator (Phone 316-946-4556) prior to development of the plat so that the type of delivery, and the tentative mailbox locations can be determined.
- M. The applicant is advised that various State and Federal requirements (specifically but not limited to the Army Corps of Engineers, Kanopolis Project Office, Rt. 1, Box 317, Valley Center, KS 67147) for the control of soil and wind erosion and the protection of wetlands may impact how this site can be developed. It is the applicant's responsibility to contact all appropriate agencies to determine any such requirements.

SUB 2001-104 -- One-Step Final Plat of HAN DIEC ADDITION
October 18, 2001 - Page 3

- N. The owner of the subdivision should be aware of the fact that the development of any subdivision greater than five (5) acres in size may require an NPDES Storm Water Discharge Permit from the Kansas Department of Health and Environment in Topeka. Further, on all construction sites, the City of Wichita requires that best management practices be used to reduce pollutant loadings in storm water runoffs.
- O. Perimeter closure computations shall be submitted with the final plat tracing.
- P. Recording of the plat within thirty (30) days after approval by the City Council and/or County Commission.
- Q. The representatives from the utility companies should be prepared to comment on the need for any additional utility easements to be platted on this property.
- R. The applicant is reminded that a disk shall be submitted with the final plat tracing to the Planning Department detailing this plat in digital format in AutoCAD. This will be used by the City and County GIS Department.

CLOSURE: HAN DIEC

PT. 1	North: 5574.0138	East : 4809.2797
Line Course:	S 00-00-00 W	Length: 285.0000
PT. 2	North: 5289.0138	East : 4809.2797
Line Course:	S 89-53-38 W	Length: 241.0000
PT. 3	North: 5288.5675	East : 4568.2801
Line Course:	N 00-00-00 E	Length: 49.4500
PT. 4	North: 5338.0175	East : 4568.2801
Line Course:	N 44-01-36 W	Length: 81.1600
PT. 5	North: 5396.3729	East : 4511.8745
Line Course:	N 01-13-46 W	Length: 177.1300
PT. 6	North: 5573.4621	East : 4508.0739
Line Course:	N 89-53-38 E	Length: 301.2100
PT. 1	North: 5574.0199	East : 4809.2834