

STAFF REPORT
(One-Step Final Plat)

CASE NUMBER: SUB 2004-72 -- HARRIS ADDITION

OWNER/APPLICANT: The Heirs of Law of Charles W. Harris, Virginia L. Harris Revocable Living Trust, 830 First National Bank Building, Wichita, KS 67201; Trail-n-Sail 2931 N. Gouverneur, #114, Wichita, KS 67226

SURVEYOR/ENGINEER: AM Consulting, Inc., 142 N. Emporia, Wichita, KS 67202

LOCATION: South side of Harry, west of Rock Road

SITE SIZE: 33,171 Sq. Ft.

NUMBER OF LOTS

Residential:	
Office:	
Commercial:	1
Industrial:	
Total:	<u>1</u>

MINIMUM LOT AREA: 33,171 Sq. Ft.

CURRENT ZONING: GC, General Commercial District

PROPOSED ZONING: Same

VICINITY MAP

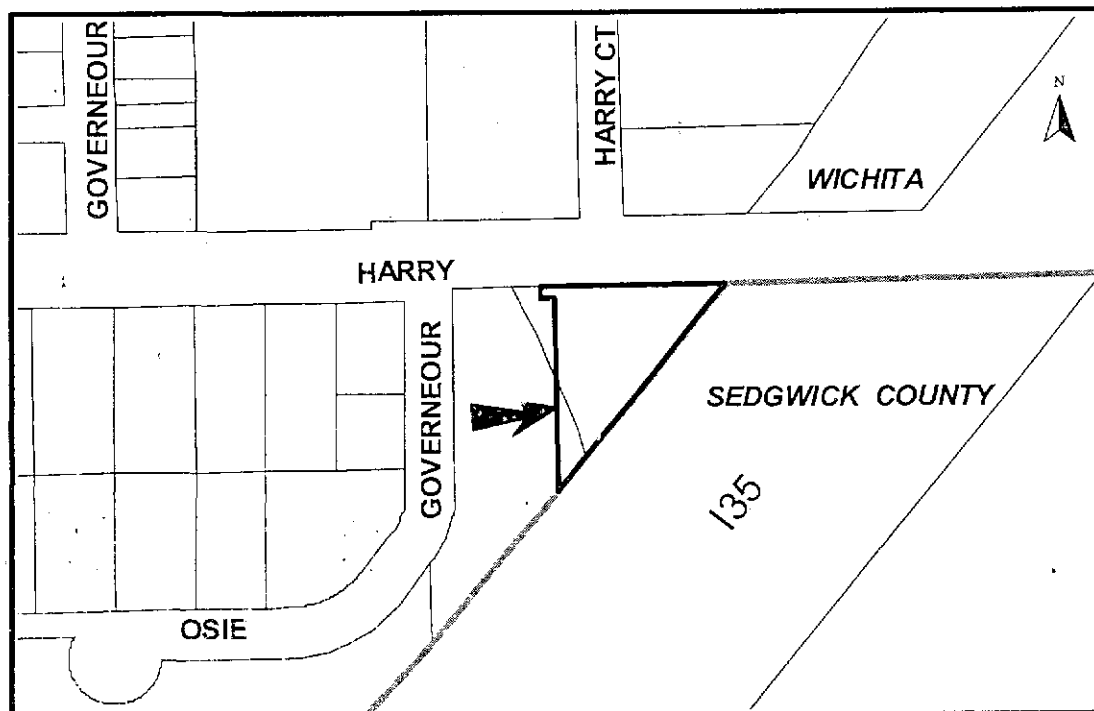

NOTE: This is an unplatted site located within the City.

STAFF COMMENTS:

- A. Municipal services appear to be available to serve the site. City Engineering needs to comment on the need for guarantees or easements.
- B. If improvements are guaranteed by petition, a notarized certificate listing the petitions shall be submitted to the Planning Department for recording.
- C. City Engineering needs to comment on the status of the applicant's drainage plan.
- D. Traffic Engineering needs to comment on the access controls. The plat proposes one joint opening along Harry with the property to the west. Distances should be shown for all segments of access control. Traffic Engineering has approved the proposed opening as a right-in/out opening only.
- E. A cross-lot access agreement with the property to the west shall be provided.
- F. The applicant shall submit an avigational easement covering all of the subject plat and a restrictive covenant assuring that adequate construction methods will be used to minimize the effects of noise pollution in the habitable structures constructed on subject property.
- G. The legal description needs to be corrected to delete reference to Tract B and to revise Tract A.
- H. The frontage dimension needs to be corrected.
- I. The Applicant is reminded that a platting binder is required with the final plat. Approval of this plat will be subject to submittal of this binder and any relevant conditions found by such a review.
- J. The platator's text shall include language that a drainage plan has been developed for the plat and that all drainage easements, rights-of-way, or reserves shall remain at established grades or as modified with the approval of the applicable City or County Engineer, and unobstructed to allow for the conveyance of stormwater.
- K. The applicant shall install or guarantee the installation of all utilities and facilities that are applicable and described in Article 8 of the MAPC Subdivision Regulations. (Water service and fire hydrants required by Article 8 for fire protection shall be as per the direction and approval of the Chief of the Fire Department.)
- L. The applicant's engineer is advised that the Register of Deeds is requiring the name(s) of the notary public, who acknowledges the signatures on this plat, to be printed beneath the notary's signature.
- M. To receive mail delivery without delay, and to avoid unnecessary expense, the applicant is advised of the necessity to meet with the U.S. Postal Service Growth Management Coordinator (Phone: 316-946-4556) prior to development of the plat so that the type of delivery, and the tentative mailbox locations can be determined.

SUB 2004-72 -- One-Step Final Plat of HARRIS ADDITION
July 1, 2004 - Page 3

- N. The applicant is advised that various State and Federal requirements (specifically, but not limited to, the Army Corps of Engineers, Kanopolis Project Office, Rt. 1, Box 317, Valley Center, KS 67147) for the control of soil and wind erosion and the protection of wetlands may impact how this site can be developed. It is the applicant's responsibility to contact all appropriate agencies to determine any such requirements.
- O. The owner of the subdivision should note that any construction that results in earthwork activities that will disturb one (1) acre or more of ground cover requires a Federal/State NPDES Storm Water Discharge Permit from the Kansas Department of Health and Environment in Topeka. Also, for projects located within the City of Wichita, erosion and sediment control devices must be used on ALL projects. For projects outside of the City of Wichita, but within the Wichita Metropolitan area, the owner should contact the appropriate governmental jurisdiction concerning erosion and sediment control device requirements.
- P. Perimeter closure computations shall be submitted with the final plat tracing.
- Q. Recording of the plat within 30 days after approval by the City Council and/or County Commission.
- R. The representatives from the utility companies should be prepared to comment on the need for any additional utility easements to be platted on this property.
- S. The applicant is reminded that a compact disc (CD) shall be submitted with the final plat tracing to the Planning Department detailing this plat in digital format in AutoCAD, or sent via e-mail to MAPD (cholloway@wichita.gov) . This will be used by the City and County GIS Department.