

BENCHMARK:
 CITY OF WICHITA BENCHMARK
 AT THE NE CORNER OF
 ARKANSAS AND 29TH ST
 NORTH
 ELEV. = 1316.81 NGVD29

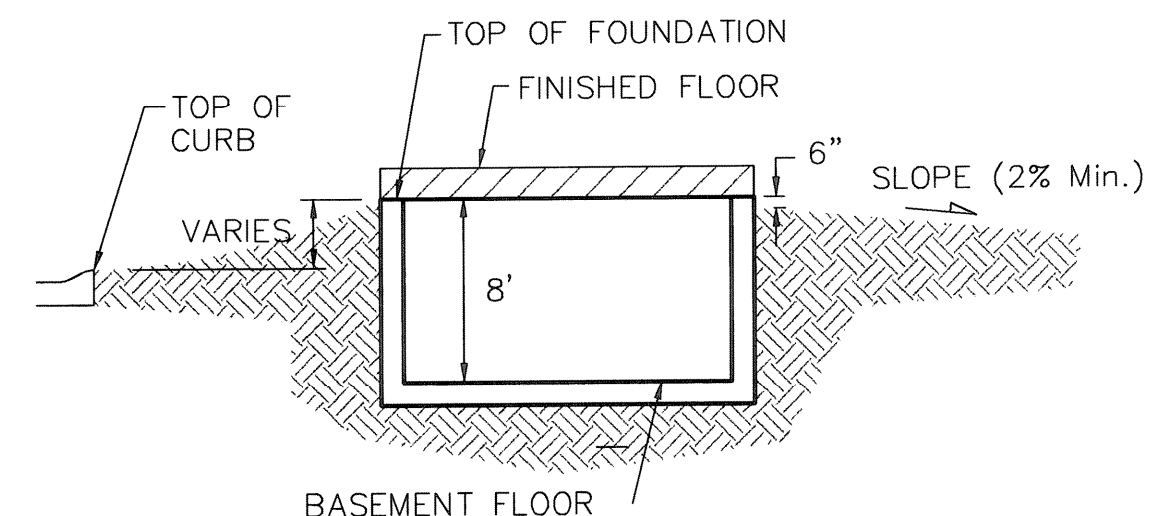
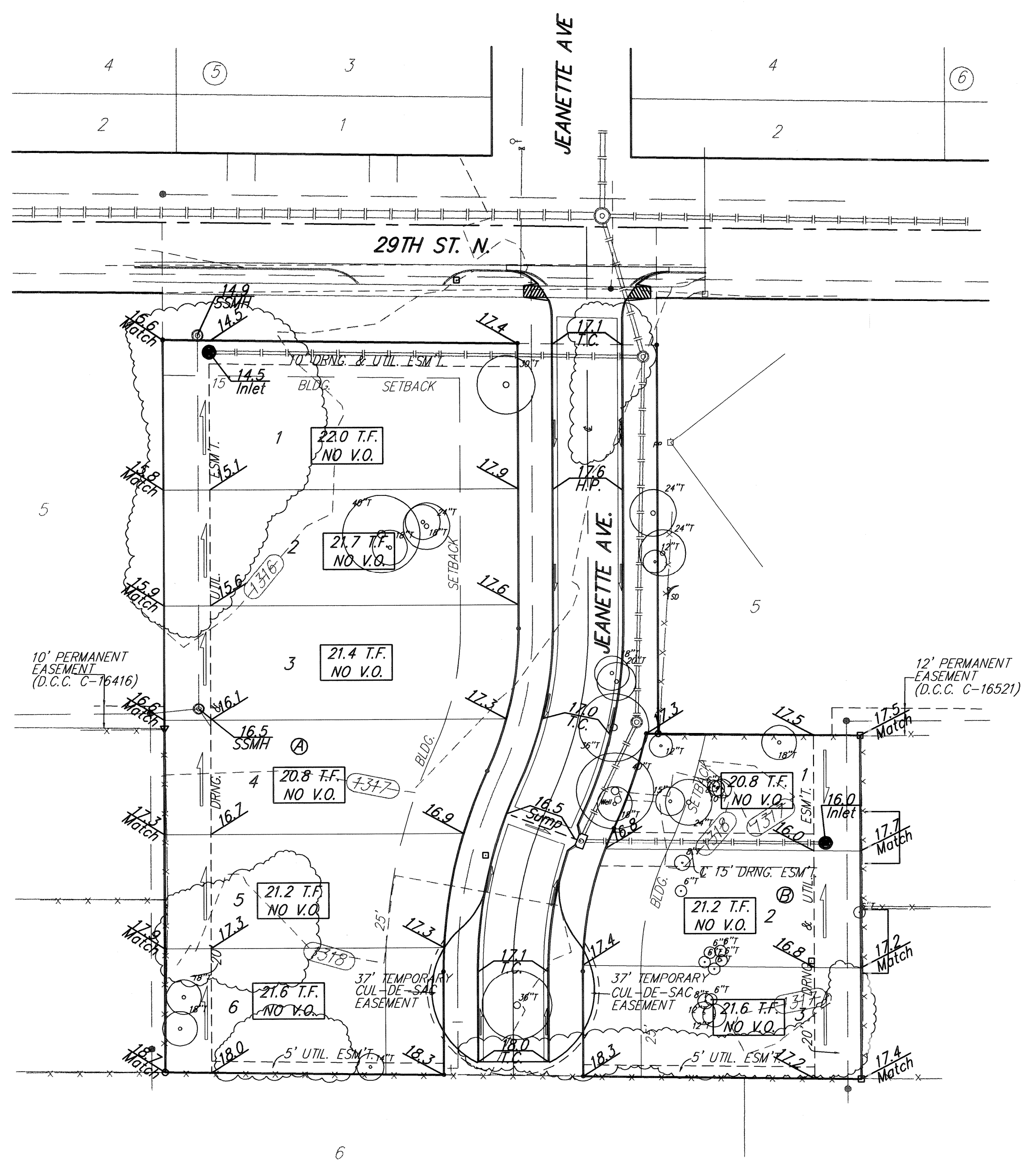
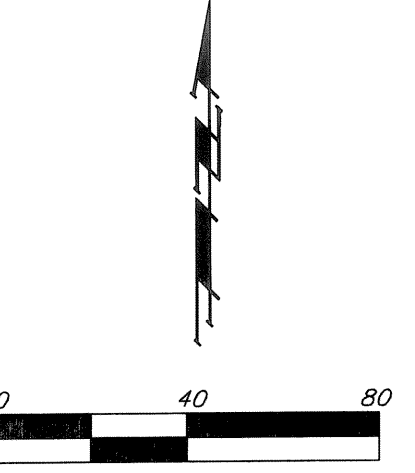

TYPICAL NON-VIEW OUT DETAIL
 NO SCALE

- NOTES:**
1. PROPOSED TOP OF FOUNDATION ELEVATIONS ARE SHOWN ON PLANS. CONTRACTOR TO SET FINISHED FLOOR AND GARAGE FLOOR ELEVATIONS. ALL STREET ELEVATIONS SHOWN ON PLANS ARE FOR TOP OF CURB (FULL-HEIGHT).
 2. THIS GRADING PLAN IS DESIGNED WITH NON VIEW-OUTS.
 3. LOT DIMENSIONS HAVE BEEN OMITTED ON THIS PLAN. REFER TO THE RECORDED PLAT FOR FINAL DIMENSION, EASEMENT, & BUILDING SETBACK INFORMATION.
 4. HOUSE PAD ELEVATIONS DEPICTED WITH BOLD OUTLINES AND NOTED WITH THIS SYMBOL ● INDICATE THAT DEEP FOOTINGS OR DEEP FOUNDATIONS MAY BE REQUIRED.
 5. A DRAINAGE PLAN HAS BEEN DEVELOPED FOR THIS SUBDIVISION AND IS ON FILE WITH THE CITY OF WICHITA, KANSAS. DRAINAGE INTENT SHALL REMAIN AS DEPICTED OR AS MODIFIED WITH THE APPROVAL OF THE CITY ENGINEER OF CITY OF WICHITA, KANSAS. NO OBSTRUCTIONS WHICH IMPEDE THE FLOW OF THIS DRAINAGE PLAN SHALL BE ALLOWED.
 6. ALL ELEVATIONS SHOWN ARE NGVD29 DATUM.

---(1.340)--- Existing Grade

		WOODLAND NORTH SUBDIVISION GRADING PLAN SEDGWICK COUNTY, KANSAS	
<small>Baughman Company, P.A. 315 Ellis St. Wichita, KS 67211 P 316-262-7271 F 316-262-0149 ENGINEERING SURVEYING PLANNING LANDSCAPE ARCHITECTURE</small>			
PROJECT NUMBER	DESIGN	DRAWN	
	NBW	TMS	
REVISIONS:	APPROVED	DATE	
	NBW	05/08	
	SCALE		
	Noted		
	SHEET		
		1 OF 1	
<small>F:\GRADE\WOODLANDNORTH\GRADE.dwg</small>			

