

DRAINAGE PLAN BAREFOOT BAY ESTATES WICHITA, SEDGWICK COUNTY, KANSAS

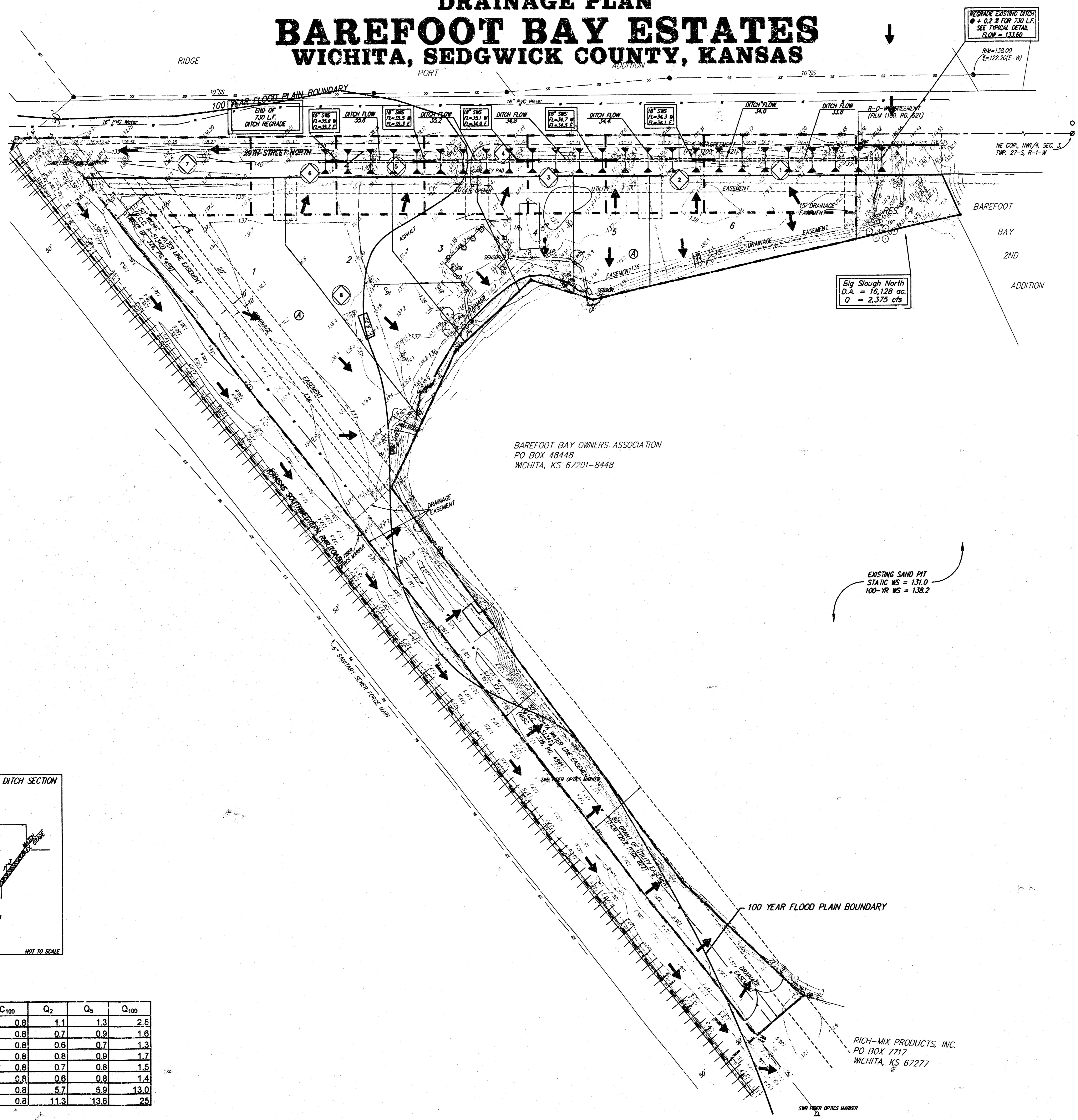

REGRADE EXISTING DITCH
@ +0.2' FOR 130 L.F.
SEE TYPICAL DETAIL
FLOW = 133.60
RM = 138.00
E = 122.20(E-W)

Big Slough North
D.A. = 16,128 ac.
Q = 2,375 cfs

BAREFOOT BAY OWNERS ASSOCIATION
PO BOX 48448
WICHITA, KS 67201-8448

EXISTING SAND PIT
STATIC WS = 131.0
100-YR WS = 138.2

RICH-MIX PRODUCTS, INC.
PO BOX 7717
WICHITA, KS 67277

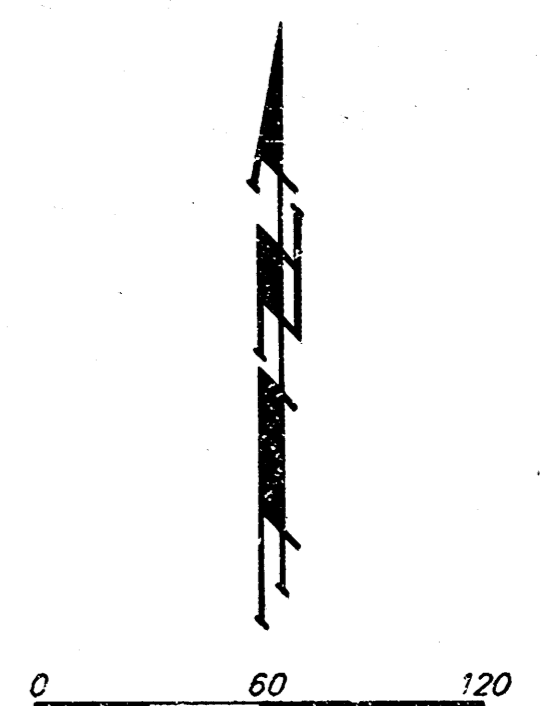

DATE OF PREPARATION = 9 JUNE 2003
CONTOUR INTERVAL = 1 FOOT
DATE OF TOPOGRAPHY = 26 OCTOBER 2000
= # REBAR W/ "BAUGHMAN" CAP (FOUND)
* = # REBAR W/ "BAUGHMAN" CAP (SET)
@ = # REBAR W/ "MDK'S" CAP (FOUND)
O = 3/4" REBAR W/ "PEC" CAP (FOUND)
B = 3/4" IRON (FOUND)
□ = RAILROAD SPIKE (FOUND)

Drainage Note:
A Portion of Subject Property is Located in
a FEMA Special Flood Hazard Area (Zone
A2), per The Below FIRM Panel.
(Community/ Panel Number; 200321
0125A) Effective Date: June 3, 1986.

MINIMUM BUILDING PAD ELEVATIONS FOR LOWEST OPENING TO THE STRUCTURES		
LOT	BLOCK	ELEVATION CITY DATUM
1-8	A	141.0

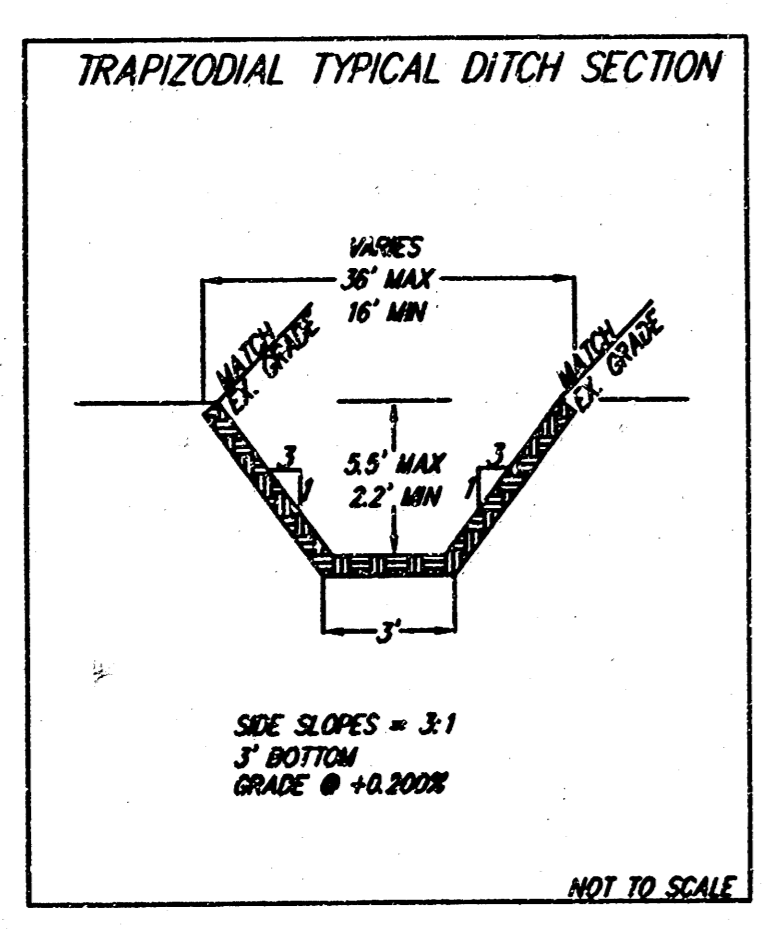

Basin #	Acres	C ₂	C ₅	C ₁₀₀	Q ₂	Q ₅	Q ₁₀₀
1	0.43	0.68	0.69	0.8	1.1	1.3	2.5
2	0.27	0.68	0.69	0.8	0.7	0.8	1.6
3	0.22	0.68	0.69	0.8	0.6	0.7	1.3
4	0.29	0.68	0.69	0.8	0.8	0.9	1.7
5	0.25	0.68	0.69	0.8	0.7	0.8	1.5
6	0.24	0.68	0.69	0.8	0.6	0.8	1.4
7	2.20	0.68	0.69	0.8	5.7	6.9	13.0
8	4.32	0.68	0.69	0.8	11.3	13.6	25