

PRELIMINARY PLAT
HILLSIDE GARDENS 2ND ADDITION
TO
WICHITA, SEDGWICK COUNTY, KANSAS

POE ASSOCIATES OF KANSAS, INC.
1001 N. CHERRY STREET, SUITE 100, WICHITA, KANSAS 67202
TEL: 316-261-1111

NOTE:
The Site Will Be Graded To
Sheet Drain Through Proposed
Drive Approach.

ERIE AVENUE

21ST STREET NORTH

LOT 1
BLOCK 1

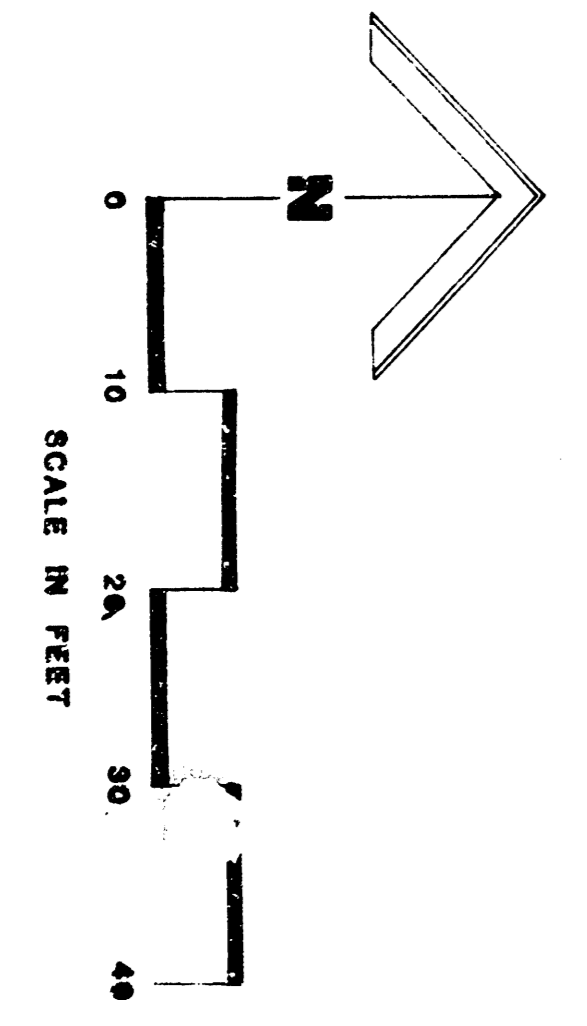

VICINITY MAP
SCALE 1"=2000'

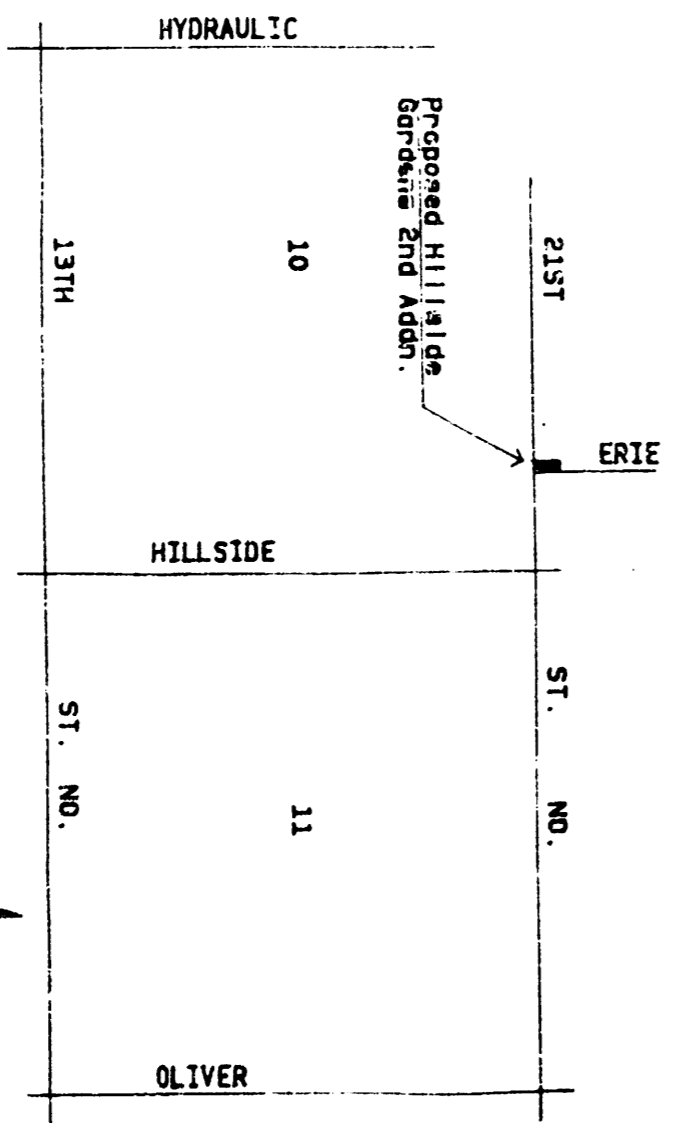

BENCHMARK: "C" set on top of curb 13' E. of
Erie and 60' N. of 21st Street. Elev. 136.67