

JEFF & AMY'S 1ST ADDITION
(Drainage)

N

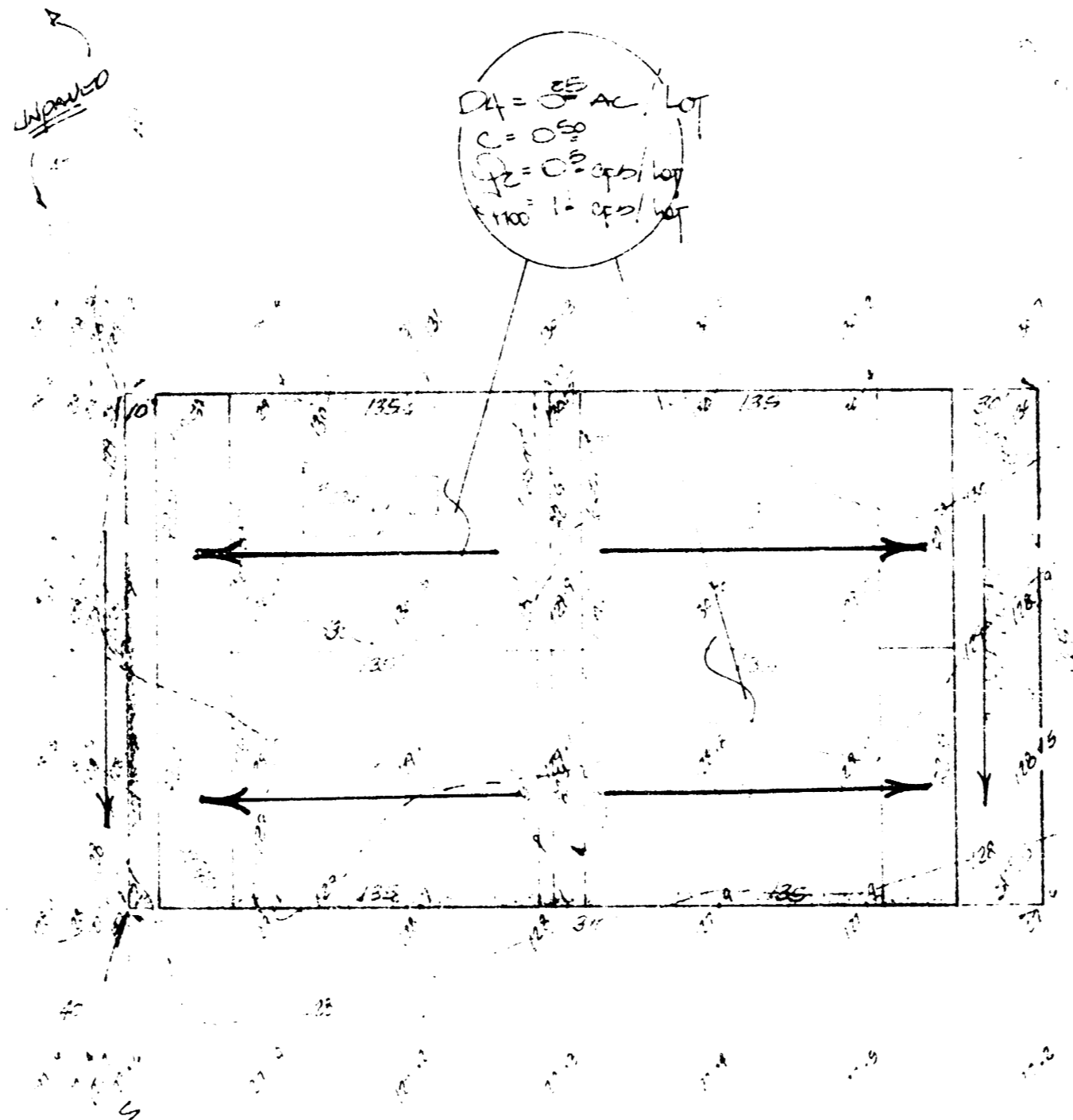

JEFF AND AMY'S 1ST ADD'N.

The site is to be divided into four (4) lots of approximately 0.25 acres in size.
R. B. Moore, Surveyor, Shawnee, Kansas

DWAYNE H. BALDWIN

ROBINSON
(PWS)

REMARKS
The four lots in this plat (approximately .25 acres in size) will be residential lots. Drainage from the lots will be directed to the street right of ways which lots are currently are improved. When streets will be graded to drain with ditches at the time of development on the lots.

DRAINAGE PLAN

MEBAUGHMAN COMPANY, P.A.
SURVEYORS & ENGINEERS
314 N. 2nd St. • 330 LAURA • WICHITA KANSAS 67201

7-27-85