

DRAINAGE PLAN

KRUMSICK & BARRETT ADDITION

WICHITA, SEDGWICK COUNTY, KANSAS

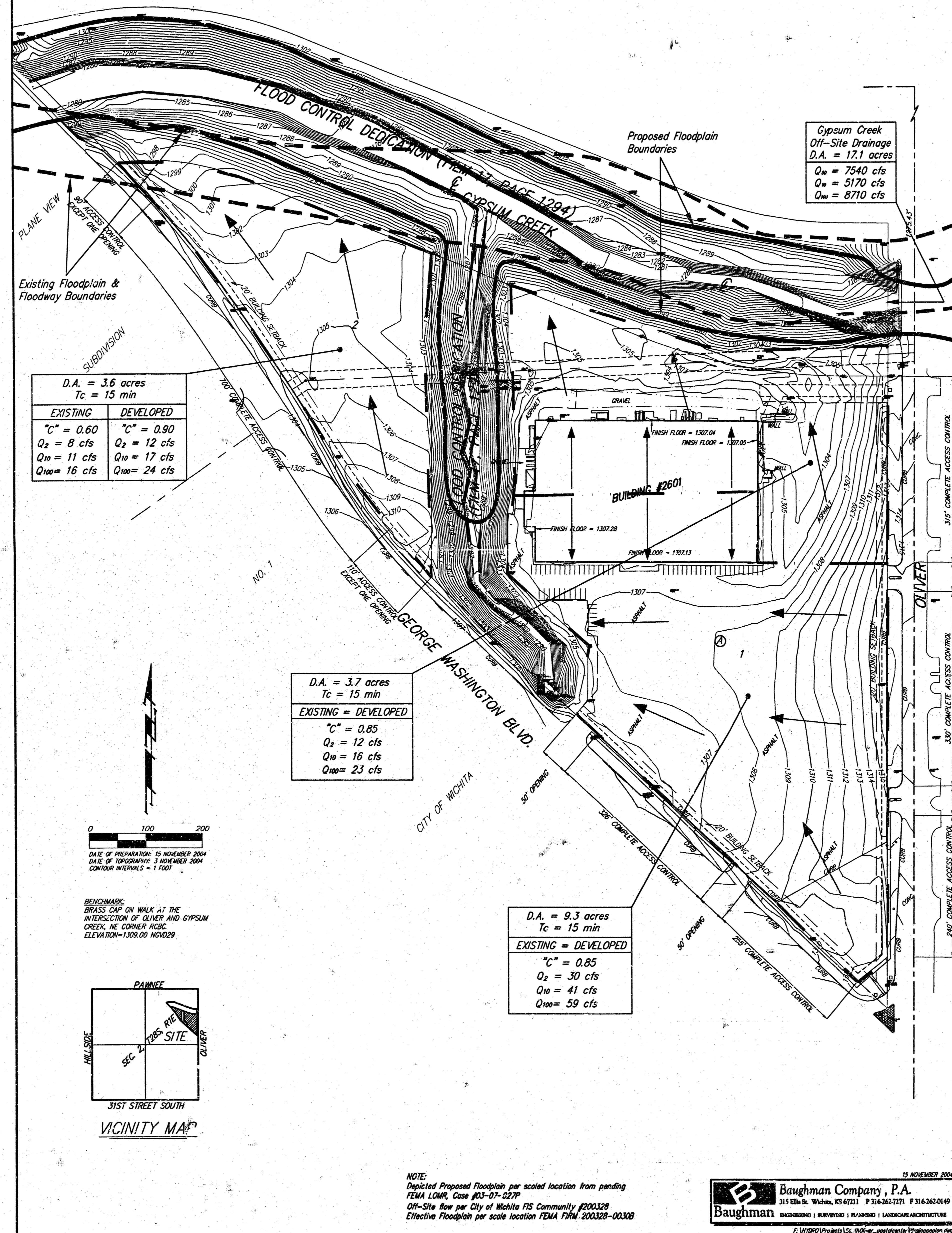

NOTE:
 Depicted Proposed Floodplain per scaled location from pending
 FEMA LOMR, Case #03-07-027P
 Off-Site flow per City of Wichita FIS Community #200328
 Effective Floodplain per scale location FEMA FIRM 200328-00308

15 NOVEMBER 2004



Baughman Company, P.A.
 315 28th St. Wichita, KS 67211 P 316-262-7171 F 316-262-0149
 SURVEYING | SURVEYING | PLANNING | LANDSCAPE ARCHITECTURE
F:\VIERO\Projects\15-Nov-04\15-Nov-04.dwg