

L. N. LIES ADDITION
(Drainage)

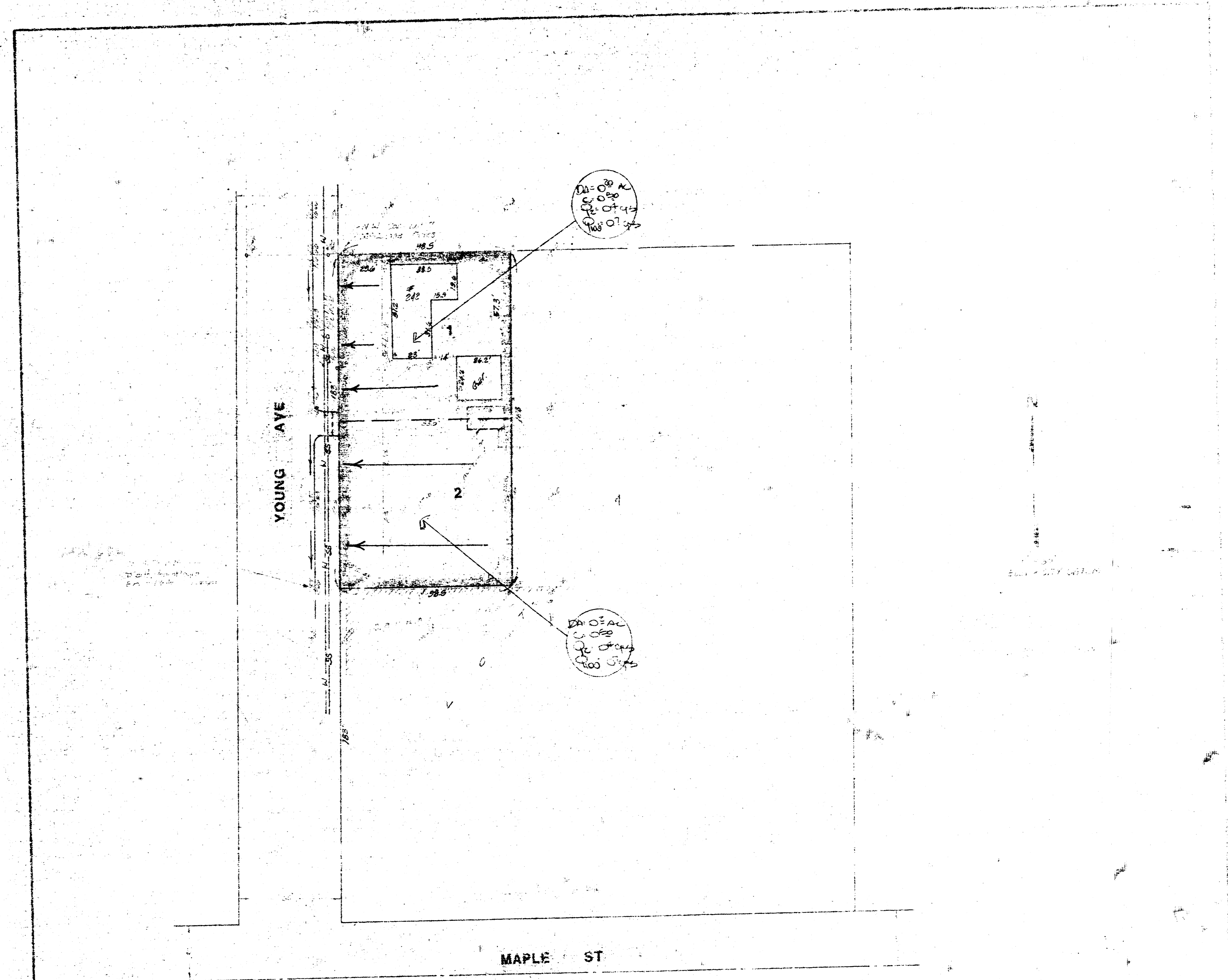

SKETCH PLAT
L. N. LIES ADDITION

THE WEST 98.5 FEET OF THE N 1/2 OF LOT 7,
MCCOMAS ACRES, SEDGWICK COUNTY, KANSAS.

LAWRENCE N. LIES

DRAINAGE PLAN

Also
The two escrowed lots will drain into
Young Ave (paved) and some in the street
as indicated

BAUGHMAN COMPANY, P.A.
SURVEYORS & ENGINEERS
214-261-1231 • 214-261-1235 • 14097A, F.W. ROAD