

**SKETCH PLAT
MASTERBILT ADDITION**

A REPLAT OF LOTS 2 AND 4 BLOCK 16, PARKWILDE ADDITION TO WICHITA, KANSAS
AND LOT 1, SHAVER ADDITION, WICHITA, KANSAS

OWNER: MASTERBILT MOTORS, INC.
B. J. MEANS, PRESIDENT
315 E. 55TH ST SO. 522-1585

DRAINAGE CONCEPT

GENERAL NOTES
THE LOT WILL BE GRADDED TO DRAIN
TOWARD STREETS AND DRAINAGE AS IT FILLS.
THE RESIDENTIAL LOTS WILL DRAIN NORTH
AND SOUTH IN PLACES AND TO PARK

BAIGHMAN COMPANY, P.A.
ENGINEERING & ARCHITECTURE
19 July 1958

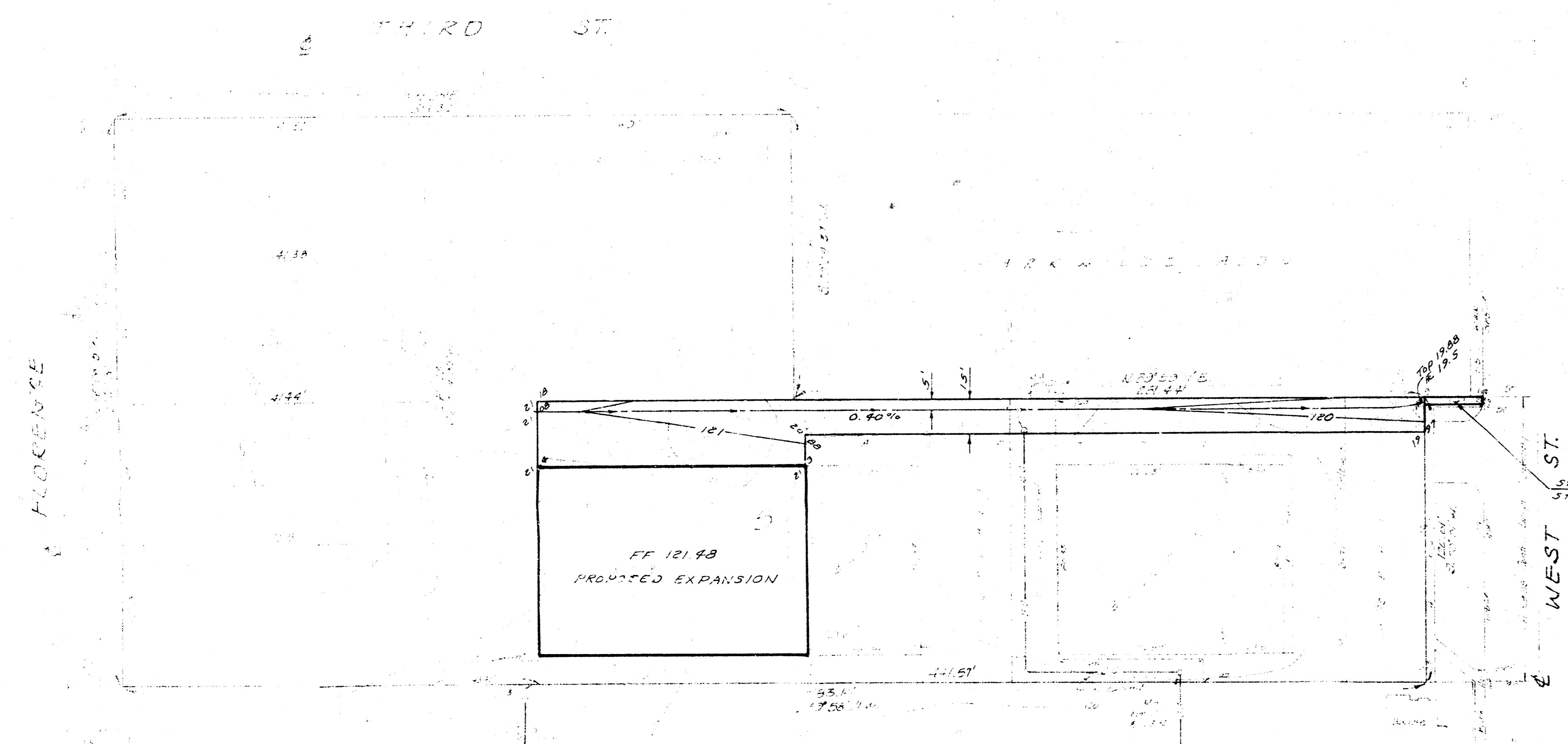

**SKETCH PLAT
MASTERBILT ADDITION**

A REPLAT OF LOTS 2 AND 4 BLOCK 16, PARKWILDE ADDITION TO WICHITA, KANSAS
AND LOT 1, SHAVER ADDITION, WICHITA, KANSAS

OWNER: MASTERBILT MOTORS, INC.
B. J. MEANS, PRESIDENT
315 E. 55TH ST SO. 522-1585