

DRAINAGE PLAN MID CONTINENT AIRPORT 3RD ADDITION TO WICHITA, SEDGWICK COUNTY, KANSAS

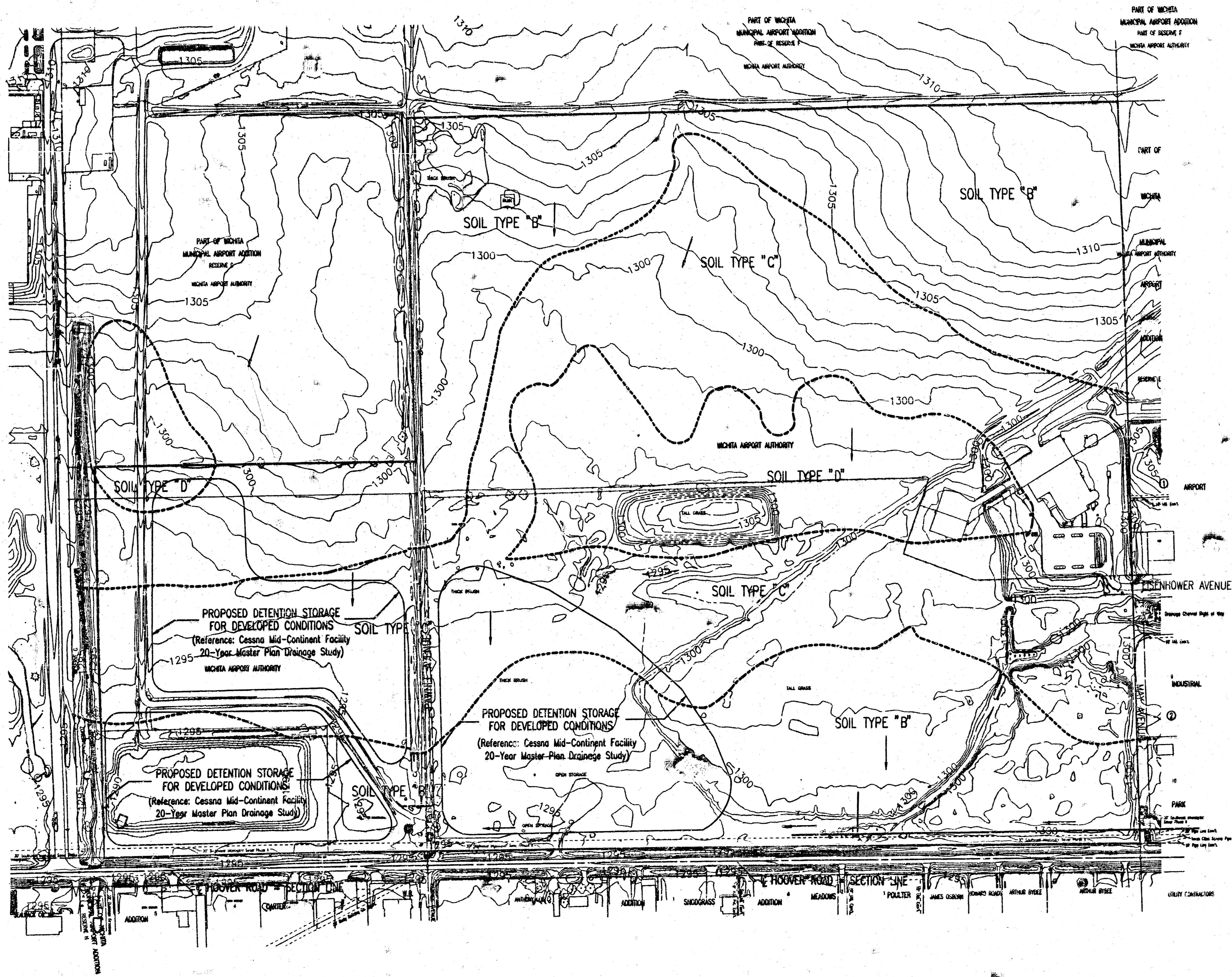

SCALE: 1" = 200'
 CONTOUR INTERVAL: 1'
 DATE OF PHOTOGRAPHY: JANUARY 11, 1999



WESTERN AIR MAPS, INC.
 OVERLAND PARK, KANSAS 66207

LEGEND

- SOIL GROUP BOUNDARY
- ◻ MAJOR STORM WATER OVERFLOW (Q100)
- MINOR STORM WATER FLOW (Q2)

DRAINAGE FROM MID CONTINENT AIRPORT 3RD ADDITION SHALL BE ROUTED TO THE ON-SITE DETENTION STORAGE FACILITY BY DRIVES, PARKING LOTS, DITCHES, FLUMES, STORM SEWER SYSTEMS OR OTHER APPROVED DRAINAGE DEVICES. SEE SUPPORTING CALCULATIONS FOR HYDROLOGY.

SEE MAP TITLED "DRAINAGE-20 YEAR PLAN, ALTERNATIVE #1" FOR BASIN LIMITS.

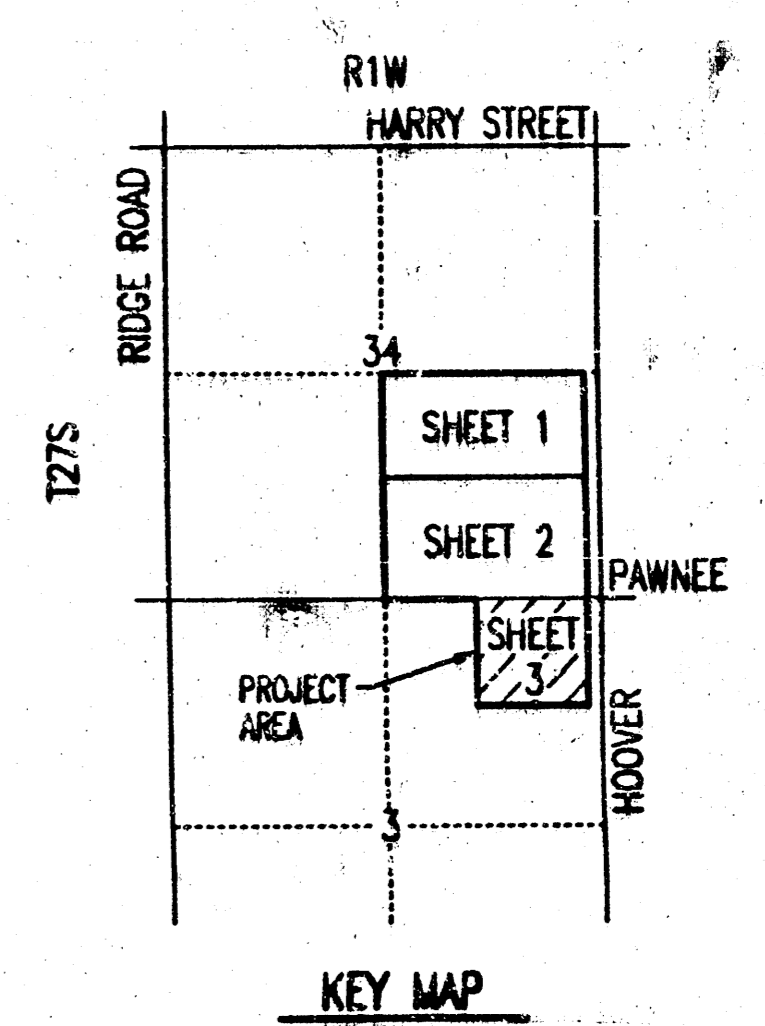

DSNB, SLD, OBER, SLD SCALE: 1"=200.00
 C:\1999\9664\Airport\Plan\City\Drainage_3rd 06-02-2000 01:16:48 pm