

**DRAINAGE PLAN  
PRELIMINARY PLAT OF  
"NELSON'S HILLSIDE PARK"  
WICHITA, KANSAS**

IN THE SOUTHEAST QUARTER OF SECTION 3,  
TOWNSHIP 28 SOUTH, RANGE 1 EAST OF THE 6TH P.M.,  
SEDGWICK COUNTY, KANSAS

Owner: Joyland Hillside Park, Inc.  
Zoning: LC-1 & SF-6

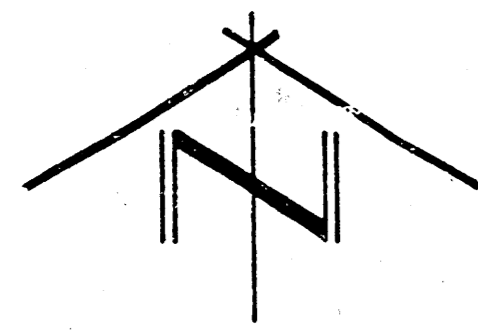

SCALE: 1" = 80'  
 IRON FOUND AS NOTED  
 OR IRON MONUMENT FOUND  
 OR IRON MONUMENT WITH I.D. CAP  
 "T" IN USES SET  
 (D) = DESCRIBED  
 (M) = MEASURED  
 BEARING BASIS ASSUMED  
 B.M. = BENCH MARK  
 F.M. = FIRE HYDRANT  
 M.H. = MANHOLE  
 W.M. = WATER METER  
 W.V. = WATER VALVE  
 P.D. = POWER POLE  
 FILE # 970089  
 20 MARCH, 1997

**LEGAL DESCRIPTION**

A tract in the Southeast Quarter of Section 3, Township 28 South, Range 1 East of the Sixth Principal Meridian, Sedgwick County, Kansas, described as follows:

**BEGINNING** at a point on the North line of the Southeast Quarter of said Section 3, which is 50 feet West of the Northeast corner of said Southeast Quarter; thence South, parallel with the East line of said Southeast Quarter, a distance of 30 feet; thence East, parallel with the North line of said Southeast Quarter, a distance of 10 feet; thence South, parallel with the East line of said Quarter, a distance of 92 feet; thence Southwesterly to a point which is 185 feet South and 240 feet West of the Northeast corner of said Southeast Quarter; thence West, parallel with the North line of said Southeast Quarter, a distance of 102 feet; thence North, parallel with the East line of said Quarter, a distance of 185 feet to the North line of said Quarter; thence East, on said North line, a distance of 292 feet to the POINT OF BEGINNING.

This legal description was prepared by Terra Tech Land Surveying, Inc. and is true and correct according to information of record and to the best knowledge and belief of the corporation.

TERRA TECH LAND SURVEYING, INC.

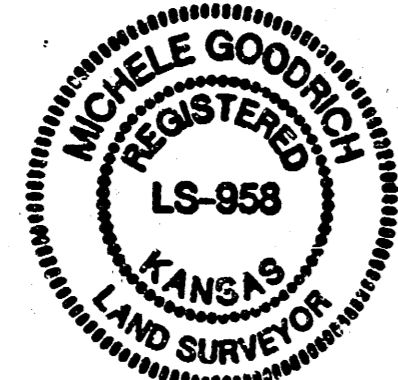

Michelle Goodrich  
 Michelle Goodrich 5-7-97, LS 958

This document should contain a crimped seal and the surveyor's signature in blue ink. If it does not, it is a copy that should be assumed to contain unauthorized alterations. The certification on this document shall not apply to any copies.

DRAINAGE PLAN PREPARED BY:	
<b>CERTIFIED ENGINEERING DESIGN</b>	
438 NORTH OHIO	SHEET 1
WICHITA, KANSAS 67214	TOTAL 1
PH. (316) 262-8803	
FAX (316) 262-0080	

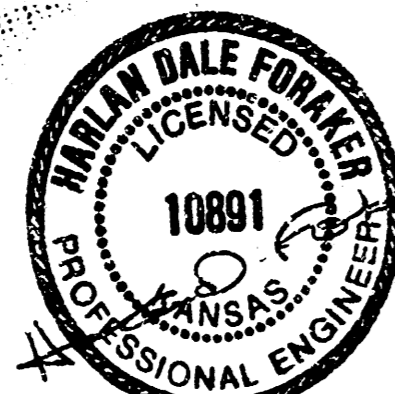

7-22-97

**TERRA TECH**  
**LAND SURVEYING INC.**

239 North Ohio  
 Wichita, Kansas 67214-3933  
 (316) 497-0744 / 267-2348  
 Fax (316) 267-2736

